

J.E. LOVE COMPANY

LOVE®

TREE SEEDLING HARVESTER



SERIAL NUMBERS 103- 114

FORESTRY PRODUCTS GROUP

P.O. BOX 188

GARFIELD, WA 99130-0188

PHONE: (509) 635-1321

FAX: (509) 635-1434

Manufacturers of Special Harvesting Equipment

ALTERNATE ROOT CLEANING SYSTEMS

OSCILLATING ROOT CLEANING SYSTEMS	4- 2
OSCILLATING ROOT SHAKER ASSEMBLIES	4- 3
ROOT SHAKER DRIVE ASSEMBLY, B1180	4- 7
PRE 1998 OSCILLATING BEATERS	4- 9
1998 TIMKEN BEARING OSCILLATING BEATERS	4-11
1999 TIMKEN BEARING OSCILLATING BEATERS	4-13
1999 BALL BEARING OSCILLATING BEATERS	4-15
ROTARY ROOT CLEANING SYSTEM, B5550	4-17

OSCILLATING ROOT SHAKER ASSEMBLIES

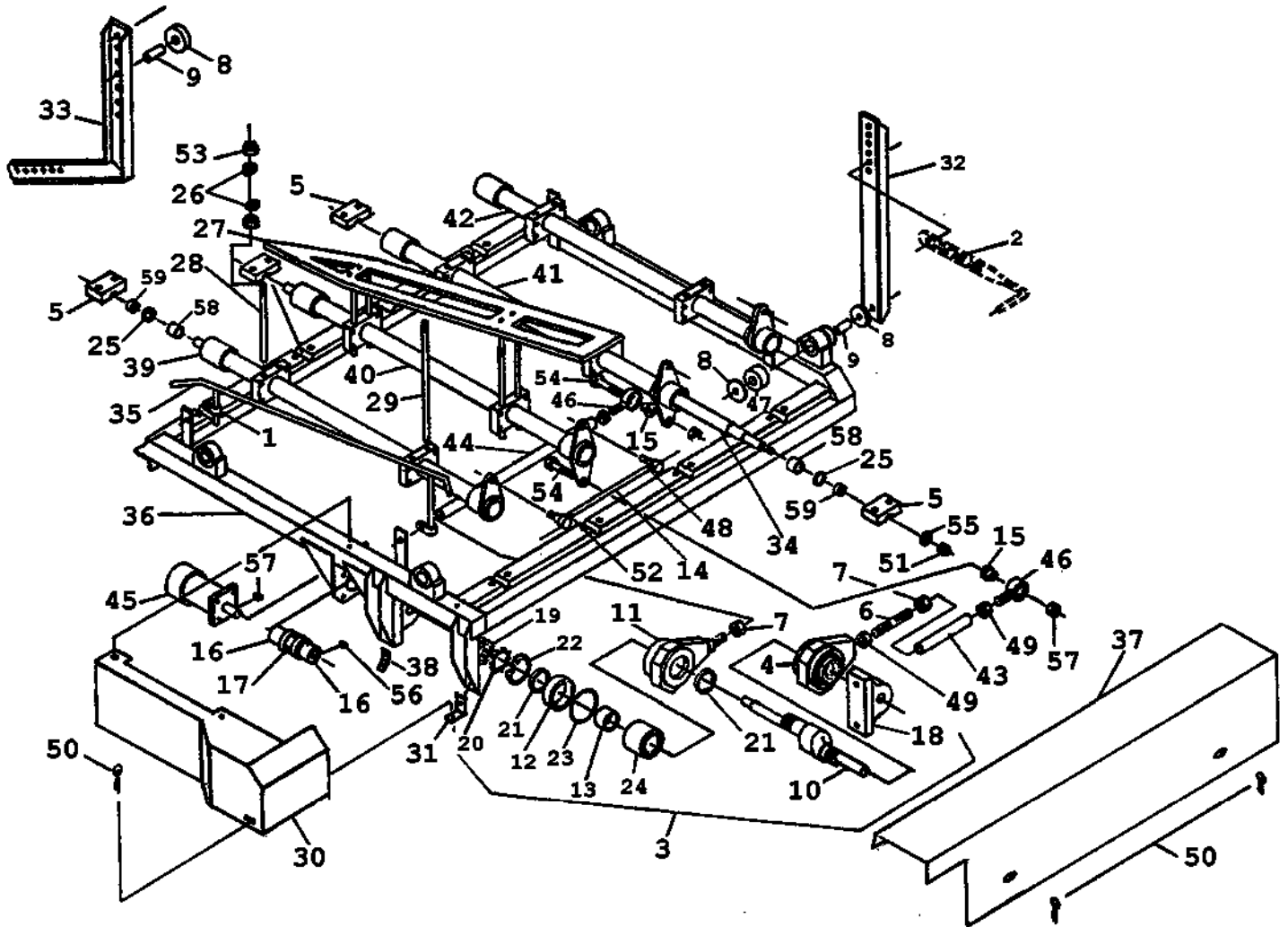



OSCILLATING ROOT SHAKER ASSEMBLIES



WARNING - STOP MACHINERY TO CLEAN, ADJUST, OIL, OR REPAIR
WARNING - KEEP HANDS, FEET, AND CLOTHING AWAY FROM POWER DRIVEN PARTS!
WARNING - SHIELDS ARE FOR YOUR PROTECTION - KEEP THEM IN PLACE!

<u>KEY</u>	<u>PART NO.</u>	<u>DESCRIPTION</u>
1	B1125	SHAKER ROD CLAMP
2	B1132	TRIP ROD HANGER
3	B1180	ROOT SHAKER DRIVE ASSY (<i>REFER TO PAGE 3-55</i>)
4	B1189	SHAKER ECCENTRIC BEARING ASSEMBLY
5	B1198	CLAMP
6	B1355	PITMAN STUD (2)
7	B1360	JAM NUT, 1"-16 LEFT HAND
8	B1368	SHAKER MOUNT WASHER
9	B1369	SHAKER MOUNT SLEEVE
10	B1379	SHAKER DRIVE SHAFT
11	B1380	ECCENTRIC BEARING CARRIER (2)
12	B1381	SEAL CARRIER RING (2)
13.	B1382	SEAL WEAR SLEEVE (2)
14	B1447	CONTROL PITMAN TUBE
15	B1448	ROD END SPACER (2)
16	B1590	COUPLING HALF, 1"
17	B1619	COUPLING INSERT
18	B1641	BEARING (2)
19	B1642	LOCKNUT (2)
20	B1643	LOCK WASHER (2)
21	B1644	SEAL (2)
22	B1645	SNAP RING (2)
23	B1646	O-RING (2)
24	B1647	BEARING (2)
25	B1659	SHAKER BAR SEAL
26	B1908	TAPERED WASHER (32 EA), PRIOR TO 1999
	B3046	TOP CLAMP (8 EA), 1999 & LATER - NOT SHOWN
	B3047	BOTTOM CLAMP (8 EA), 1999 & LATER - NOT SHOWN
27	B2962	BEATER, 48" MYCARTA
	B3023	BEATER, 57" MYCARTA
	B2420	BEATER, UHMW POLYETHYLENE
28	B2421	FRONT SUPPORT ROD
	B3051	FRONT BOLT
	B3049	FRONT SLEEVE (8 EA), 1999 & LATER - NOT SHOWN
29	B2422	REAR SUPPORT ROD, PRIOR TO 1999
	B3052	REAR BOLT, 1999 & LATER
	B3048	SPACER (8 EA AT REAR), 1999 & LATER - NOT SHOWN
	B3050	REAR SLEEVE (8 EA), 1999 & LATER - NOT SHOWN

OSCILLATING ROOT SHAKER ASSEMBLIES, CONTINUED:

<u>KEY</u>	<u>PART NO.</u>	<u>DESCRIPTION</u>
30	B2662	ECCENTRIC DRIVE SHIELD
	WARNING - SHIELDS ARE FOR YOUR PROTECTION - KEEP THEM IN PLACE!	
	D24	DECAL, BE CAREFUL
31	B2663	ECCENTRIC SHIELD LATCH
32	B2671	REAR SHAKER HANGER
33	B2672	LEFT FRONT SHAKER HANGER
	B2673	RIGHT FRONT SHAKER HANGER
34	B2678	BEATER SHAFT, 31-3/4"
35	B2679	LEFT BACKUP ROD
	B2680	RIGHT BACKUP ROD
36	B3025	FRAME, ADJUSTABLE REAR SHAFT CLAMP (TIMKEN BEARING)
	B2689	ROOT SHAKER FRAME, PRIOR TO 1999
37	B2704	PITMAN SHIELD
	WARNING - SHIELDS ARE FOR YOUR PROTECTION - KEEP THEM IN PLACE!	
	D24	DECAL, BE CAREFUL
38	B2759	ECCENTRIC SHIELD STOP
39	B3031	LEFT IDLER HOUSING, 1999 & LATER
40	B3032	LEFT DRIVE HOUSING, 1999 & LATER
41	B3033	RIGHT DRIVE HOUSING, 1999 & LATER
42	B3034	RIGHT IDLER HOUSING, 1999 & LATER
43	B3035	SHORT INPUT PITMAN TUBE, RH THREAD 1-14 UNF
	B1446	SHORT INPUT PITMAN TUBE, 1-16 UNS THREAD (PRIOR TO 1999)
44	B3036	LONG INPUT PITMAN TUBE, RH THREAD 1-14 UNF
	B1445	LONG INPUT PITMAN TUBE, 1-16 UNS THREAD (PRIOR TO 1999)
45	B5393	HYDRAULIC MOTOR, COUNTER CLOCKWISE 3.2 C.I.R. - 4 BOLT
	B5378	HYDRAULIC MOTOR, 4-BOLT ORB PORTS - PRIOR TO 1999
	B1658	HYDRAULIC MOTOR, 4-BOLT PIPE PORTS - PRIOR TO 1998
46	B5392	SPHERICAL ROD END, 1"-14 THREAD (2)
	B1670	SPHERICAL ROD END, 1"-16 UNS THREAD (PRIOR TO 1999)
47	CD215	RUBBER BUSHING
48	CD535	BALL JOINT, 1' RIGHT HAND STUD NUT: 9/16-18 THD, 1-1/16 ACROSS FLATS, 39/64 HIGH, 3/4 LOCK WASHER
49	X2L100-JAM	JAM NUT, 1"-14 UNF
	CD537	JAM NUT, 1"-16 NS, PRIOR TO 1999
50	D10089	QUICK LOCK PIN
51	R10237	SELF LOCKING NUT, 3/4-16 UNF
52	R10266	BALL JOINT, 1' LEFT HAND STUD NUT: 9/16-18 THD, 1-1/16 ACROSS FLATS, 39/64 HIGH, 3/4 LOCK W
53	X2E062-NF2	SELF LOCKING NUT, 5/8-10 UNC
54	X2L0750350	B1826, 3/4-16 UNF X 3-1/2 CAP SCREW, GRADE 8
55	X3D125075-3	MACHINERY BUSHING, 1-1/4" O.D. X 3/4" I.D. X #10 GA

OSCILLATING ROOT SHAKER ASSEMBLIES, CONTINUED:

<u>KEY</u>	<u>PART NO.</u>	<u>DESCRIPTION</u>
56	X3H808	WOODRUFF KEY, #808 - 1/4 X 1 (WAS B1821)
57	X3H809	WOODRUFF KEY, #809 - 1/4 X 1-1/8 (WAS B1822)
58		BEARING, REFER TO ALT. SPECIFICATIONS, PAGES 4-9 - 4-15.
59		SPACER, REFER TO ALT. SPECIFICATIONS, PAGES 4-9 - 4-15.

NOT SHOWN:

<u>KEY</u>	<u>PART NO.</u>	<u>DESCRIPTION</u>
	B2845	DOUBLE ECCENTRIC SHIELD
	B3046	TOP CLAMP (8 EA), 1999 & LATER
	B3047	BOTTOM CLAMP (8 EA), 1999 & LATER
	B3048	SPACER (8 EA AT REAR), 1999 & LATER
	B3048	SPACER
	B3049	FRONT SLEEVE (8 EA), 1999 & LATER
	B3050	REAR SLEEVE (8 EA), 1999 & LATER

REFER TO:

PAGE 4-11 TO 4-13,

ALTERNATE SPECIFICATIONS FOR ROOT **SHAKER HOUSINGS PRIOR TO 1999.**

PAGE 4-11 TO 4-13,

ALTERNATE SPECIFICATIONS FOR OPTIONAL **TIMKEN BEARING BAR ASSEMBLIES.**

PAGE 4-11 AND 4-15,

ALTERNATE SPECIFICATIONS FOR OPTIONAL **BALL BEARING BAR ASSEMBLIES.**

ROOT SHAKER ECCENTRIC ASSEMBLY, B1180

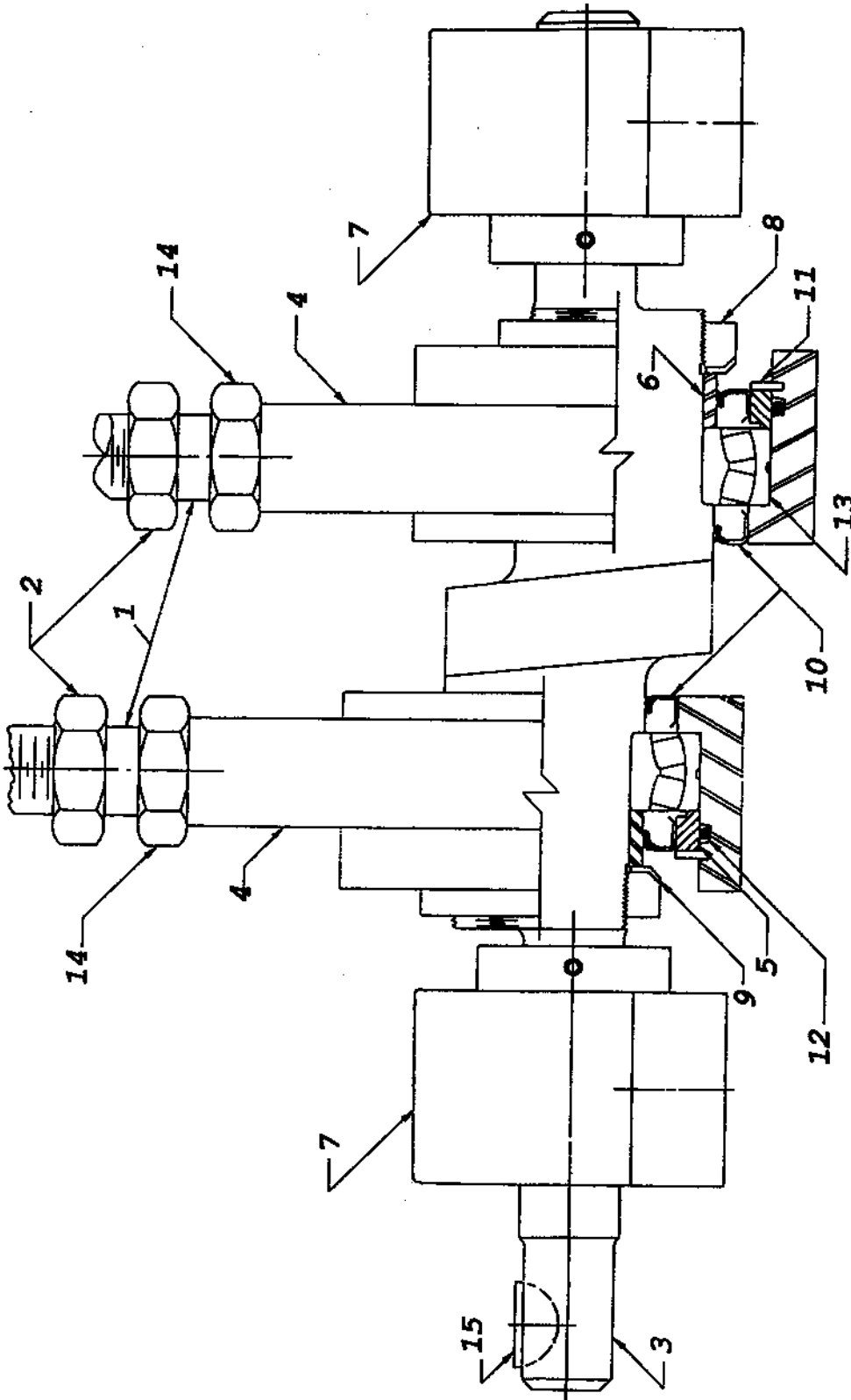

ROOT SHAKER ECCENTRIC ASSEMBLY, B1180

<u>KEY</u>	<u>PART NO.</u>	<u>DESCRIPTION</u>
1	B1355	PITMAN STUD
2	B1360	JAM NUT, 1-16 NS LEFT HAND
3	B1379	SHAKER DRIVE SHAFT
4	B1380	ECCENTRIC BEARING CARRIER
5	B1381	SEAL CARRIER RING
6	B1382	SEAL WEAR SLEEVE
7	B1641	BEARING, 1-1/8" PILLOW BLOCK
8	B1642	LOCKNUT
9	B1643	LOCK WASHER
10	B1644	SEAL
11	B1645	SNAP RING
12	B1646	O-RING
13	B1647	BEARING, SPHERICAL ROLLER
14	CD537	JAM NUT, 1-16 NS RIGHT HAND
15	X3H809	WOODRUFF KEY, #809 - 1/4 X 1-1/8 (WAS B1822)

ALTERNATE ROOT CLEANING SYSTEMS

OSCILLATING WITH SPLIT CLAMPS FOR SUPPORT RODS AND BALL BEARINGS
B2555, B2556 B2557, AND B2558

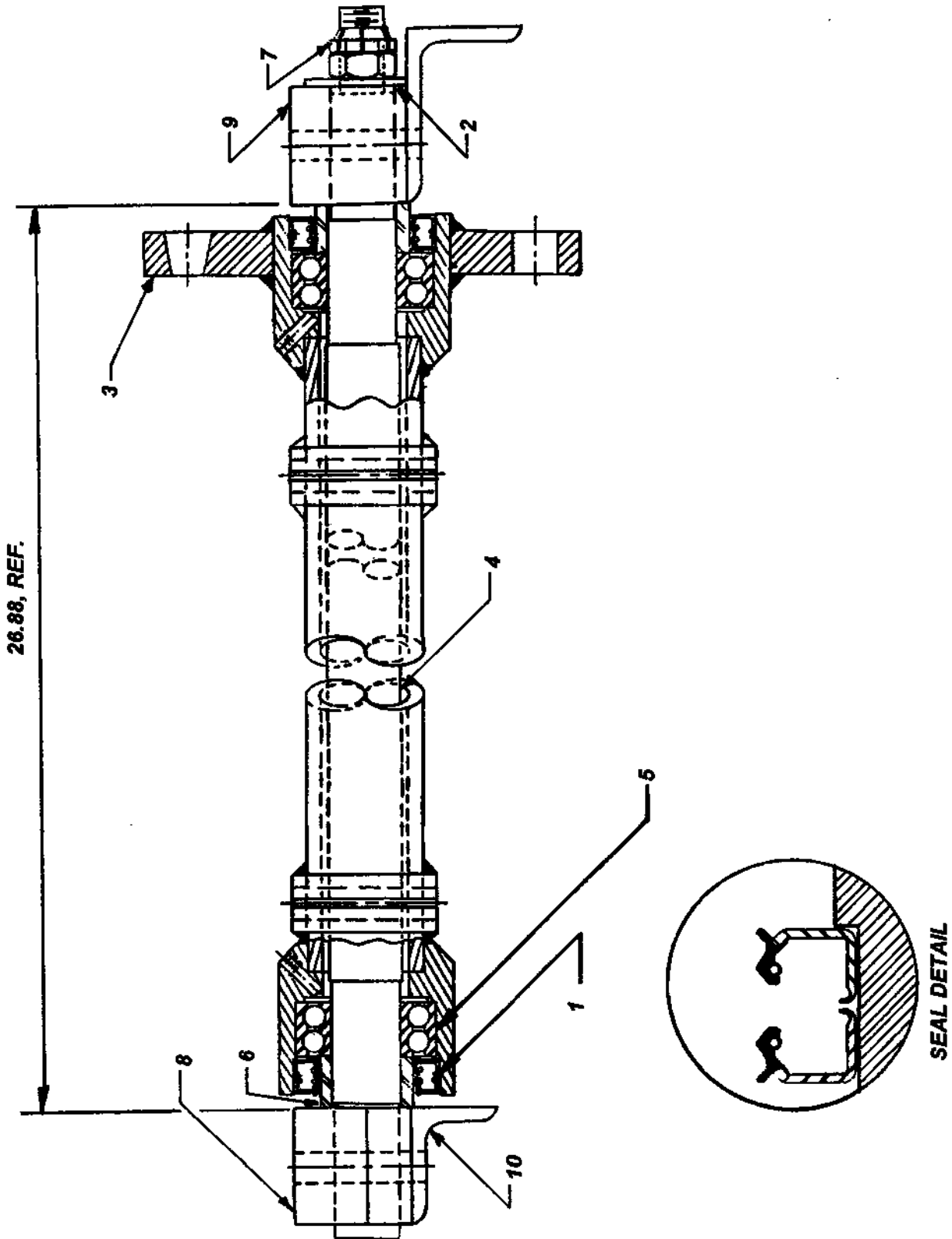

ALTERNATE ROOT CLEANING SYSTEMS

OSCILLATING WITH SPLIT CLAMPS FOR SUPPORT RODS AND BALL BEARINGS B2555, B2556 B2557, AND B2558

<u>KEY</u>	<u>PART NO.</u>	<u>DESCRIPTION</u>
1	B1659	SEAL
2	X3D125075-3	MACHINERY BUSHING, 1-1/4" O.D. X 3/4" I.D. X #10 GA
3	B2674	LEFT IDLER HOUSING WITH CLAMPS
	B2555	LEFT IDLER BAR ASSEMBLY, BALL BEARING WITH CLAMPS
	B2675	LEFT DRIVE HOUSING WITH CLAMPS (SHOWN)
	B2556	LEFT DRIVE BAR ASSY, BALL BEARING WITH CLAMPS (SHOWN)
	B2676	RIGHT DRIVE HOUSING WITH CLAMPS
	B2557	RIGHT DRIVE BAR ASSEMBLY, BALL BEARING WITH CLAMPS
	B2677	RIGHT IDLER HOUSING WITH CLAMPS
	B2558	RIGHT IDLER BAR ASSEMBLY, BALL BEARING WITH CLAMPS
4	B2678	BEATER SHAFT, 31.75"
5	R 390	BEARING
6	R10139	SPACER, 7/8"
7	R10237	SELF LOCKING NUT, 3/4-16 UNF
8	B1198	CLAMP (8)
9	B3024	SHAFT CLAMP, ADJUSTABLE
10	B3025	FRAME, ADJUSTABLE SHAFT CLAMP

NOT SHOWN:

<u>KEY</u>	<u>PART NO.</u>	<u>DESCRIPTION</u>
	B1908	TAPERED WASHER (32)
	B2421	FRONT SUPPORT ROD (8)
	B2422	REAR SUPPORT ROD (8)
	B2962	BEATER, 48" MYCARTA - STANDARD

OPTIONAL BEATERS

<u>KEY</u>	<u>PART NO.</u>	<u>DESCRIPTION</u>
	B2420	BEATER, UHMW POLYETHYLENE X 48"
	B3023	BEATER, 57" MYCARTA

ALTERNATE ROOT CLEANING SYSTEMS

B5549, TIMKEN BEARINGS CLAMP STYLE HOUSINGS

OSCILLATING WITH SPLIT CLAMPS FOR SUPPORT RODS AND TIMKEN BEARINGS
B5551, B5552 B5553, AND B5554

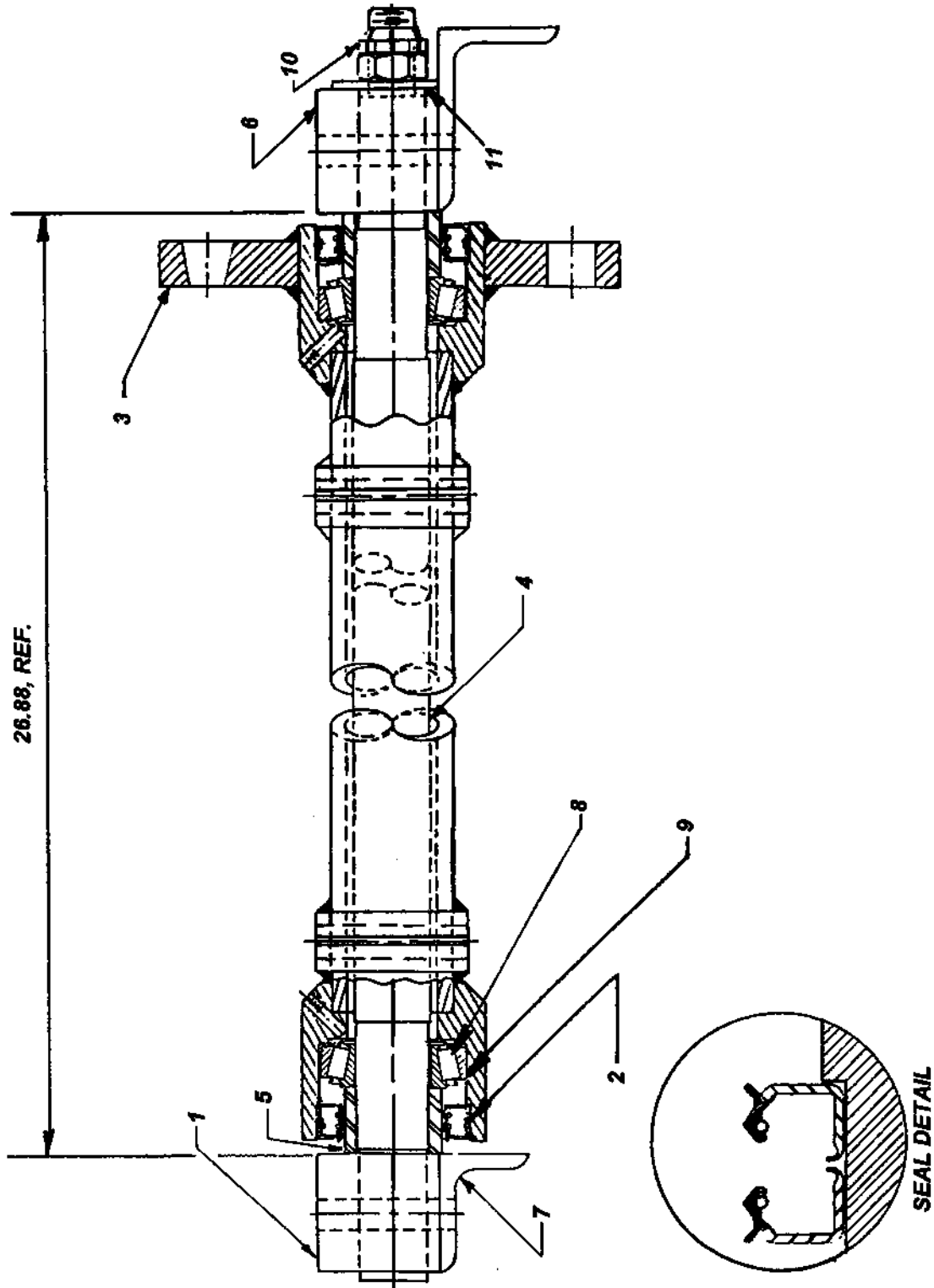

ALTERNATE ROOT CLEANING SYSTEMS
B5549, TIMKEN BEARINGS CLAMP STYLE HOUSINGS

OSCILLATING WITH SPLIT CLAMPS FOR SUPPORT RODS AND TIMKEN BEARINGS
B5551, B5552 B5553, AND B5554

<u>KEY</u>	<u>PART NO.</u>	<u>DESCRIPTION</u>
1	B1198	CLAMP (8)
2	B1659	SEAL
3	B2674	LEFT IDLER HOUSING WITH CLAMPS
	B5551	LEFT IDLER BAR ASSEMBLY, TIMKEN BEARING WITH CLAMPS
	B2675	LEFT DRIVE HOUSING WITH CLAMPS
	B5552	LEFT DRIVE BAR ASSY, TIMKEN BEARING WITH CLAMPS (SHOWN)
	B2676	RIGHT DRIVE HOUSING WITH CLAMPS
	B5553	RIGHT DRIVE BAR ASSEMBLY, TIMKEN BEARING WITH CLAMPS
	B2677	RIGHT IDLER HOUSING WITH CLAMPS
	B5554	RIGHT IDLER BAR ASSEMBLY, TIMKEN BEARING WITH CLAMPS
4	B2678	BEATER SHAFT, 31.75"
5	B2994	SPACER, 1" (8)
6	B3024	SHAFT CLAMP, ADJUSTABLE
7	B3025	FRAME, ADJUSTABLE SHAFT CLAMP
8	B5383	CONE, 1.1806" I.D. (8)
9	B5384	CUP, 2.4409" O.D. (8)
10	R10237	SELF LOCKING NUT, 3/4-16 UNF
11	X3D125075-3	MACHINERY BUSHING, 1-1/4" O.D. X 3/4" I.D. X #10 GA

NOT SHOWN:

<u>KEY</u>	<u>PART NO.</u>	<u>DESCRIPTION</u>
	B1908	TAPERED WASHER (32)
	B2421	FRONT SUPPORT ROD (8)
	B2422	REAR SUPPORT ROD (8)
	B2962	BEATER, 48" MYCARTA - STANDARD

OPTIONAL BEATERS

<u>KEY</u>	<u>PART NO.</u>	<u>DESCRIPTION</u>
	B2420	BEATER, UHMW POLYETHYLENE X 48"
	B3023	BEATER, 57" MYCARTA

ALTERNATE ROOT CLEANING SYSTEMS
B5555 WITH 57" BEATERS & B5563 WITH 48" BEATERS

OSCILLATING BEATER WITH ROD AND SLEEVE SUPPORTS AND TIMKEN BEARINGS
B5559, B5560, B5561 AND B5562

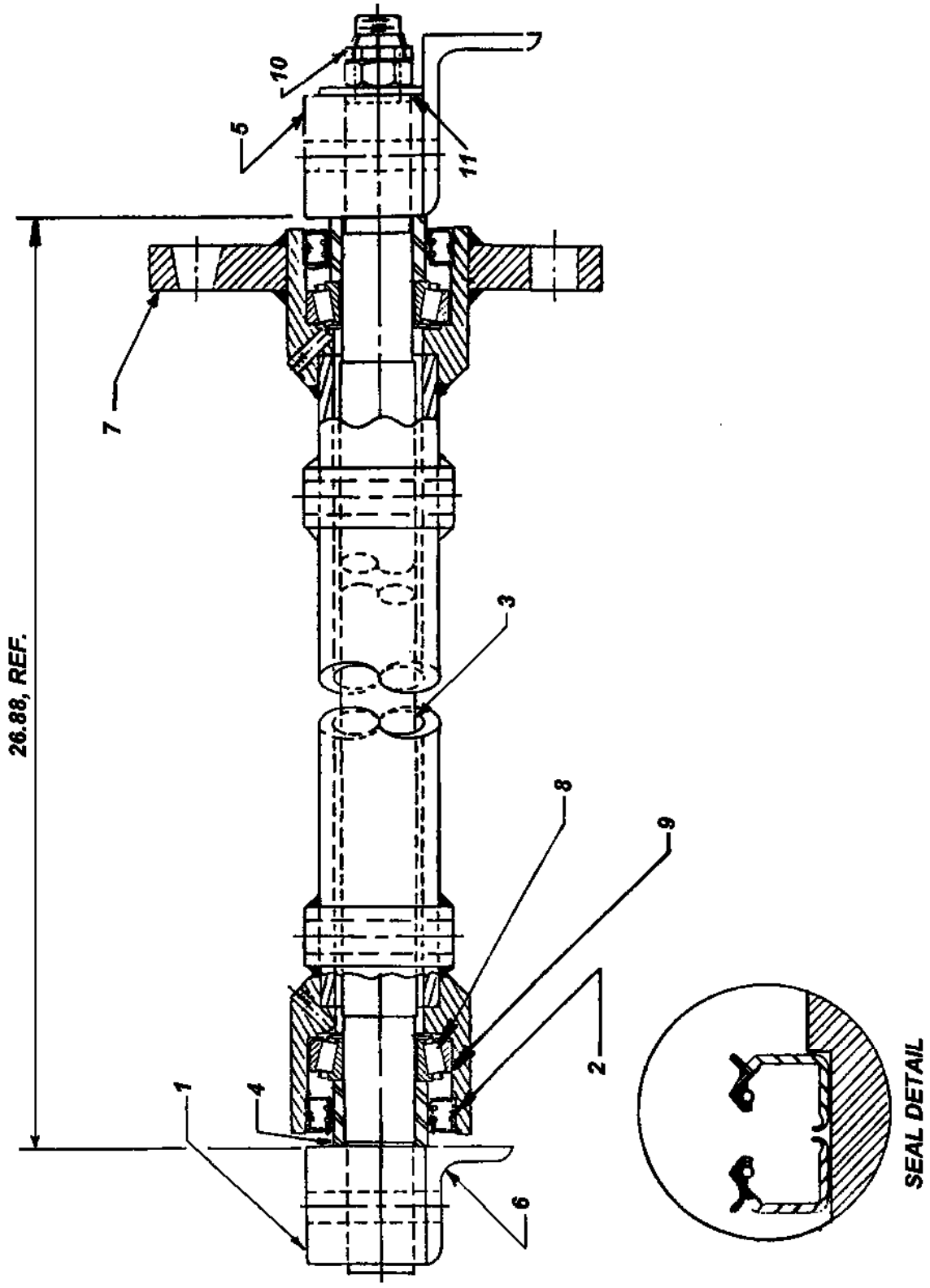

**ALTERNATE ROOT CLEANING SYSTEMS
B5555 WITH 57" BEATERS & B5563 WITH 48" BEATERS**

**OSCILLATING BEATER WITH ROD AND SLEEVE SUPPORTS AND TIMKEN BEARINGS
B5559, B5560, B5561 AND B5562**

<u>KEY</u>	<u>PART NO.</u>	<u>DESCRIPTION</u>
1	B1198	CLAMP (8)
2	B1659	SEAL
3	B2678	BEATER SHAFT, 31.75"
4	B2994	SPACER, 1"
5	B3024	SHAFT CLAMP, ADJUSTABLE
6	B3025	FRAME, ADJUSTABLE SHAFT CLAMP
7	B3031	LEFT IDLER HOUSING
	B5559	LEFT IDLER BAR ASSEMBLY
	B3032	LEFT DRIVE HOUSING
	B5560	LEFT DRIVE BAR ASSEMBLY (SHOWN)
	B3033	RIGHT DRIVE HOUSING
	B5561	RIGHT DRIVE BAR ASSEMBLY
	B3034	RIGHT IDLER HOUSING
	B5562	RIGHT IDLER BAR ASSEMBLY
8	B5383	CONE, 1.1806" I.D.
9	B5384	CUP, 2.4409" O.D.
10	R10237	SELF LOCKING NUT, 3/4-16 UNF
11	X3D125075-3	MACHINERY BUSHING, 1-1/4" O.D. X 3/4" I.D. X #10 GA

NOT SHOWN:

<u>KEY</u>	<u>PART NO.</u>	<u>DESCRIPTION</u>
	B2962	BEATER, 48" MYCARTA - STANDARD
	B3046	TOP CLAMP (8 EA), 1999 & LATER
	B3047	BOTTOM CLAMP (8 EA), 1999 & LATER
	B3048	SPACER (8 EA AT REAR), 1999 & LATER
	B3049	FRONT SLEEVE (8 EA), 1999 & LATER
	B3050	REAR SLEEVE (8 EA), 1999 & LATER
	B3053	FRONT BRACE (4) - 57" BEATER ONLY

OPTIONAL BEATERS

<u>KEY</u>	<u>PART NO.</u>	<u>DESCRIPTION</u>
	B2420	BEATER, UHMW POLYETHYLENE X 48"
	B3023	BEATER, 57" MYCARTA

ALTERNATE ROOT CLEANING SYSTEMS
B2554, BALL BEARING STYLE

OSCILLATING WITH BOLT AND SLEEVE SUPPORT RODS AND BALL BEARINGS
B5570, B5571, B5572, B5573

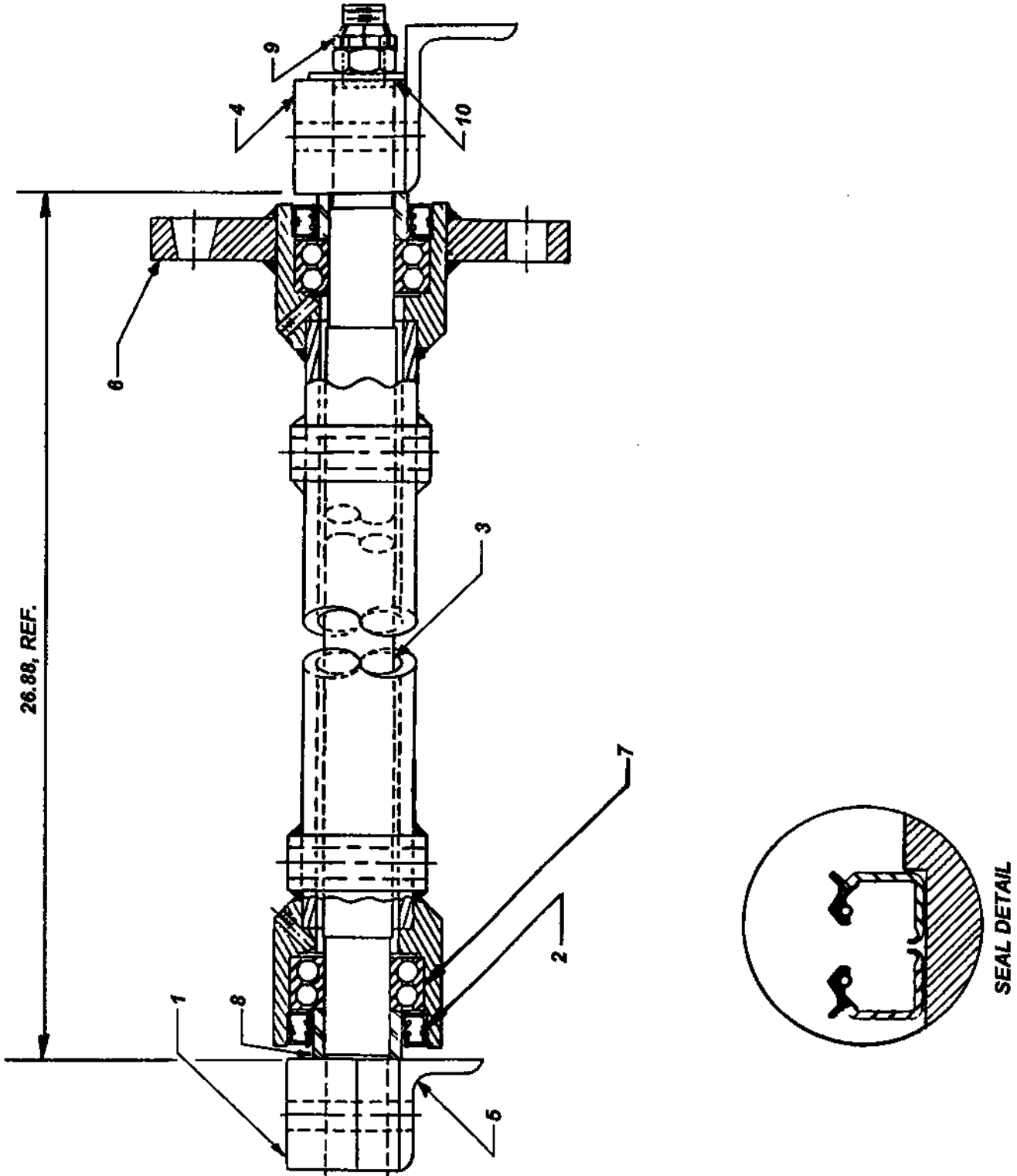

**ALTERNATE ROOT CLEANING SYSTEMS
B2554, BALL BEARING STYLE**

**OSCILLATING WITH BOLT AND SLEEVE SUPPORT RODS AND BALL BEARINGS
B5570, B5571, B5572 AND B5573**

<u>KEY</u>	<u>PART NO.</u>	<u>DESCRIPTION</u>
1	B1198	CLAMP (8)
2	B1659	SEAL
3	B2678	BEATER SHAFT, 31.75"
4	B3024	SHAFT CLAMP, ADJUSTABLE
5	B3025	FRAME, ADJUSTABLE SHAFT CLAMP
6	B3031	LEFT IDLER HOUSING
	B5570	LEFT IDLER BAR ASSEMBLY, BALL BEARING W/O CLAMPS
	B3032	LEFT DRIVE HOUSING
	B5571	LEFT DRIVE BAR ASSY, BALL BEARING W/O CLAMPS (SHOWN)
	B3033	RIGHT DRIVE HOUSING
	B5572	RIGHT DRIVE BAR ASSEMBLY, BALL BEARING W/O CLAMPS
	B3034	RIGHT IDLER HOUSING
	B5573	RIGHT IDLER BAR ASSEMBLY, BALL BEARING W/O CLAMPS
7	R 390	BEARING
8	R10139	SPACER, 7/8"
9	R10237	SELF LOCKING NUT, 3/4-16 UNF
10	X3D125075-3	MACHINERY BUSHING, 1-1/4" O.D. X 3/4" I.D. X #10 GA

NOT SHOWN:

<u>KEY</u>	<u>PART NO.</u>	<u>DESCRIPTION</u>
	B2962	BEATER, 48" MYCARTA - STANDARD
	B3046	TOP CLAMP (8 EA), 1999 & LATER
	B3047	BOTTOM CLAMP (8 EA), 1999 & LATER
	B3048	SPACER (8 EA AT REAR), 1999 & LATER
	B3049	FRONT SLEEVE (8 EA), 1999 & LATER
	B3050	REAR SLEEVE (8 EA), 1999 & LATER
	B3053	FRONT BRACE (4) - 57" BEATER ONLY

OPTIONAL BEATERS

<u>KEY</u>	<u>PART NO.</u>	<u>DESCRIPTION</u>
	B2420	BEATER, UHMW POLYETHYLENE X 48"
	B3023	BEATER, 57" MYCARTA

ROTARY ROOT CLEANING SYSTEM, B5550

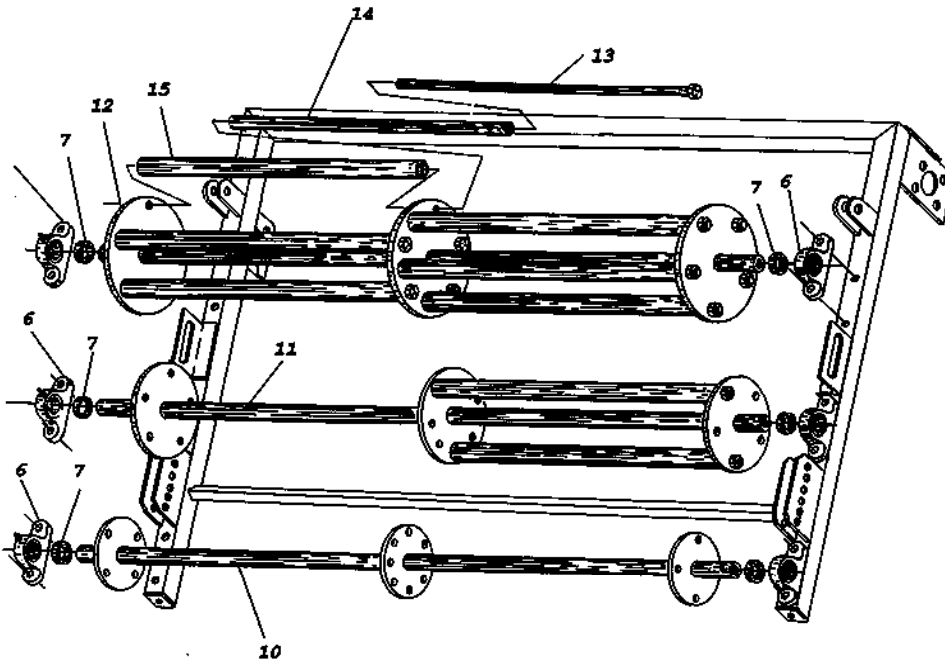
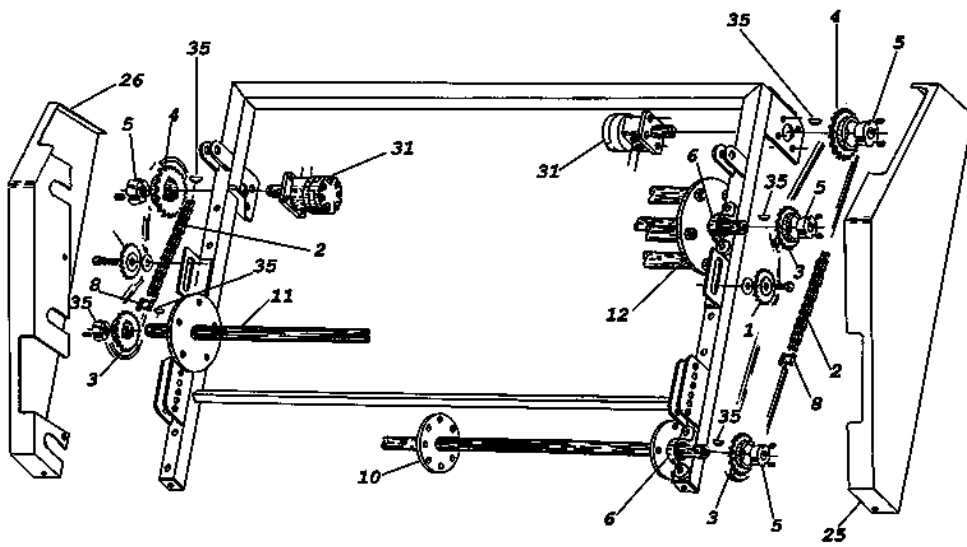
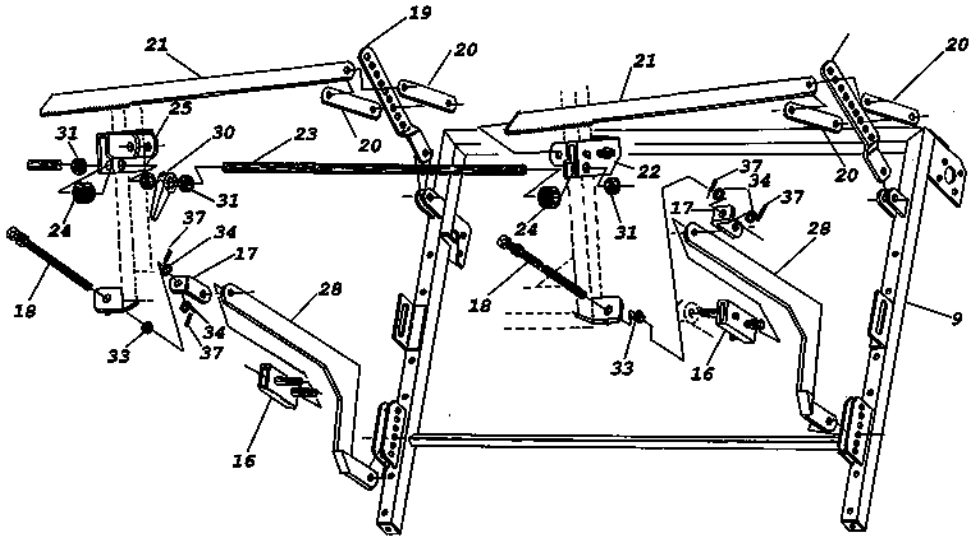

ROTARY ROOT CLEANING SYSTEM, B5550

<u>KEY</u>	<u>PART NO.</u>	<u>DESCRIPTION</u>
1	A1506	IDLER SPROCKET, #50 - 17 TOOTH (2)
2	A1671	ROLLER CHAIN, RC 50 - BOX @ 10 FT
3	B1519	SPROCKET, 50TLB16
4	B1521	SPROCKET, 50TLB22
5	B1522	BUSHING, TAPER LOCK X 1" BORE
6	B1597	PILLOW BLOCK BEARING, 1" BORE W/TRIPLE LIP SEALS (6)
7		ECCENTRIC LOCKING COLLAR
8	B1816	CONNECTOR LINK, RC 50
9	B3000	FRAME, ROTARY ROOT CLEANER
10	B3001	BEATER SHAFT, SMALL - 6" DIA.
11	B3002	BEATER SHAFT, MEDIUM - 8" DIA.
12	B3003	BEATER SHAFT, LARGE - 10" DIA.
13	B3004	ROLLER PIVOT ROD (28)
14	B3005	BEARING (28)
	B3006	ROLLER, HEAVY WALL
15	B3018	ROLLER, THIN WALL
16	B3007	FRONT SLIDE BOX (2)
17	B3008	LIFT EAR, FRONT ADJUSTMENT (2)
18	B3010	BOLT, ADJUSTING (2)
19	B3011	LIFT LINK, REAR LOWER (2)
20	B3012	LIFT LINK, REAR TOGGLE (4)
21	B3013	RACK LINK (2)
22	B3014	REAR SLIDE BOX, LEFT HAND
23	B3015	SHAFT, REAR ADJUSTING
24	B3016	SPUR GEAR, 32 TOOTH
25	B3017	REAR SLIDE BOX, RIGHT HAND
26	B3019	SHIELD, LEFT CHAIN
27	B3020	SHIELD, RIGHT CHAIN
28	B3021	LIFT LINK, FRONT LH
29	B3022	LIFT LINK, FRONT RH
30	B5379	RATCHET HANDLE
31	B5385	SET COLLAR, 3/4"
32	B5394	HYDRAULIC MOTOR, CLOCKWISE - O-RING PORTS (2)
33	X2C062	5/8-11 UNC HEX NUT (2)
34	X3C062	5/8 FLAT WASHER (4)
35	X3H606	WOODRUFF KEY, #606 - 3/16 X 3/4 (WAS B1819)
36	X3H809	WOODRUFF KEY, #809 - 1/4 X 1-1/8" (WAS B1822) (3)
37	X3G188-150	SPRING PIN, 3/16" X 1-1/2" (4)

ROTARY ROOT CLEANING SYSTEM, B5550, CONTINUED:

<u>KEY</u>	<u>PART NO.</u>	<u>DESCRIPTION</u>
NOT SHOWN:		
B1653		COUPLER, QUICK DISCONNECT - 3/4" X 3/4" NPTF
B1655		NIPPLE, QUICK DISCONNECT - 1/2" X 1/2" NPTM (3)
B1656		COUPLER, QUICK DISCONNECT - 1/2" X 1/2" NPTF (5)
B1815		OFF SET LINK, RC 50
B1932		TEST PORT NIPPLE
B1936		DUST CAP
B1961		HOSE ASSEMBLY, 3/4" X 32
B5048		HOSE ASSEMBLY, 1/2" X 30"
B5182		NIPPLE, QUICK DISCONNECT - 1/2" X 1/2" NPTF (2)
B5377		HOSE ASSY, 1/2" X 20" - #8 FJIC X 100R1 X #8 MJIC
B5399		FLOW CONTROL VALVE, #10 SAE WITH RELIEF
B5409		HOSE ASSY, 1/2" X 24" - #8 FJIC X 100R1 X 1/2" NPTM
F1212		HOSE ASSY, 1/2" X 20" - #8 FJIC X 100R1 X 1/2" NPTM
F1213		HOSE ASSY, 1/2" X 30" - #8 FJIC X 100R1 X 1/2" NPTM
F5386		HOSE ASSY, 1/2" X 44" - #8 FJIC X 100R1 X #8 FJIC