



**KCF4, KCF6, AND KCF8
KCG4, KCG6 AND KCG8**

**FLEXIBLE FLOATING SOLID PANEL CUTTERBAR
SOYBEAN CUTTERBARS**

**GARFIELD, WA 99130-0188
(509) 635-1321 ■ FAX: (509) 635-1434**

INDEX

LOVE FLEXIBLE FLOATING SOYBEAN CUTTERBARS SOLID PANEL CUTTERBARS - NO LIFTERS

FOREWORD AND WARRANTY.....	1
SAFETY INTRODUCTION.....	2
INTRODUCTIONS.....	3, 4
CUTTERBAR MASTER KEY	5, 6, 7, 8

KCF4, KCF6 AND KCG8

KCG4, KCG6 AND KCG8 CUTTERBAR PACKAGE. SECTION 1

KCF AND KCG COMMON PARTS	1-1, 2, 3
--------------------------------	-----------

SICKLE DRIVE ASSEMBLIES.

SECTION 2

SICKLE DRIVE ASSEMBLIES CHART.....	2-1
CF2304 POSI-GUIDE SICKLE DRIVE.....	2-2,3
CF2305 POSI-ROLLER GUIDE SICKLE DRIVE	2-4,5
CF2328 POSI-ROLLER GUIDE SICKLE DRIVE - DUAL BALL PITMAN ..	2-6,7
DUAL BALL JOINT DRIVE HEAD W/"CG" SICKLE	2-10
DUAL BALL JOINT DRIVE HEAD W/"CGB" SICKLE	2-11
DUAL BALL JOINT PITMANS.....	2-12, 13, 14, 15

SHOE ASSEMBLIES.

SECTION 3

SHOE ASSEMBLY CHART.....	3-1
CD7065 SHOE ASSEMBLY PARTS.....	3-2
CM4062 SHOE ASSEMBLY PARTS - JOHN DEERE 200 & 900.....	3-3
CM4063 SHOE ASSEMBLY PARTS - CASE, IHC & MASSEY FERGUSON.....	3-4

SPECIFIC MODEL KITS.

SECTION 4

THIS SECTION TO BE ADDED BY THE DEALER FOR COMBINE MAKE, MODEL AND HEADER WIDTH. REFER TO CUTTERBAR MASTER KEY TO IDENTIFY KITS.

FOREWORD

This book provides instructions and essential information in regards to ordering J. E. Love Company products. Close adherence to these instructions will result in better fulfillment of your order.

J. E. LOVE COMPANY WARRANTY

The J. E. Love Company warrants that it will repair F.O.B. its factory or furnish without charge F.O.B. its factory, a similar part to replace any material in its machinery which within one year after date of retail delivery or lease/rental is proved to the satisfaction of the Company to have been defective at the time it was delivered. Provided that all parts claimed defective shall be returned, properly identified, to the Company's branch having jurisdiction over the territory, charges prepaid.

This warranty to repairs applies only to new and unused machinery, which after shipment from the factory of the Company, has not been altered, changed, repaired or treated in any manner whatsoever, and does not extend to equipment or implements not manufactured by the J. E. Love Company, although sold or operated with the Company's Machinery.

THIS WARRANTY TO REPAIR IS THE ONLY WARRANTY EITHER EXPRESS, IMPLIED OR STATUTORY, UPON WHICH SAID MACHINERY IS SOLD. SPECIFICALLY, THE J. E. LOVE COMPANY DISCLAIMS ANY IMPLIED WARRANTY OF MERCHANTABILITY OR IMPLIED WARRANTY OF FITNESS FOR PURPOSE.

The Company's liability in connection with this transaction is expressly limited to the repair or replacement of defective parts; all other damages and warranties, statutory or otherwise, being hereby expressly waived by the purchaser.

No representative of the Company has the authority to change this warranty or this contract in any manner whatsoever, and no attempt to repair or promise to repair or improve the machinery covered by this contract by any representative of the Company shall waive any consideration of the contract or change or extend this warranty in any manner whatsoever.

The J. E. Love Company shall in no event be responsible or liable in damages for losses, delays or nonperformance caused by or due to current energy, fuel or material shortages or due to Labor Contracts beyond the control of the Company.

J.E. Love Company reserves the right to make improvement changes on any of its products without notice.

WARRANTY CLAIMS PROCEDURE

1. A warranty claim must be submitted in writing through the point of purchase.
2. Defective parts for which a warranty claim is made must be returned to the J. E. Love Company, transportation charges prepaid, within 30 days from the claim date.



SAFETY INTRODUCTION

THE SAFETY-ALERT SYMBOL MEANS ATTENTION! BECOME ALERT! YOUR SAFETY IS INVOLVED! THIS SYMBOL IDENTIFIES IMPORTANT SAFETY MESSAGES IN THIS MANUAL. WHEN YOU SEE THIS SYMBOL, BE ALERT TO THE POSSIBILITY OF PERSONAL INJURY AND CAREFULLY READ THE MESSAGE THAT FOLLOWS.



DANGER

**ROTATING SHAFTS CAN CAUSE DEATH OR SEVERE INJURY.
- KEEP CLEAR - DO NOT OPERATE WITHOUT SHIELDS IN PLACE.**



CAUTION

BLOCK SECURELY

DO NOT PLACE YOURSELF UNDER ANY EQUIPMENT SUSPENDED HYDRAULICALLY, WITH MECHANICAL STOPS, JACKS OR HOISTS, WITHOUT BLOCKING SECURELY. MAKE SURE MACHINE CANNOT ROLL.



CAUTION

BEFORE POWER STARTING - CHECK TO INSURE THAT ALL BOLTS ARE PROPERLY TIGHTENED AND REEL IS FREE TO ROTATE. KEEP ALL PARTS OF BODY, CLOTHING AND ALL PERSONNEL CLEAR.



CAUTION

DO NOT SERVICE EQUIPMENT WHILE IT IS RUNNING. SHUT OFF POWER TO ADJUST, SERVICE OR CLEAN.

INTRODUCTION

KCF4, KCF6, KCF8, KCG4, KCG6, AND KCG8 CUTTERBAR PACKAGES

This manual is presented in the following sections:

1. Cutterbar Packages

KCF0XXX, KCF4XXX, KCF6XXX, KCF8XXX, KCG4XXX, KCG6XXX AND KCG8XXX

2. Sickle Drives

CF2304, CF2305, AND CF2328

3. Shoe Assemblies

CF7065, CM4062 AND CM4063

4. Specific Model Kits

Kit numbers are listed in both the whole goods price list and the cutterbar master key. They may be ordered by combine make, model and header width.

Section 1. Cutterbar packages

J. E. Love Company uses an Alpha-numerical identification system to identify its products and their components. Each part of the identification system provides specific information. Cutterbar package information is listed on the cutterbar master key. This list identifies the cutterbar package by combine make/model, header number or series, header width and if needed by serial number.

Currently all cutterbar packages are for left end drive combines. Meaning the left end facing the operational direction of travel.

Solid Panel Soybean Cutterbar Packages will have an alpha identification of KCF or KCG, followed by a numerical identification of four (4) numbers. KCF and KCG cutterbar packages have the sickle drive location at guard holes 9, 10, 11, and 12.

The KCG cutterbar package has a dual ball joint pitman drive head. The KCF cutterbar package has a rubber bushing drive head.

Examples:

<u>KCF0240</u>	"0" indicates special order shoes. "240" indicates the length of the barback in inches.
<u>KCF4240</u>	"4" indicates CM4062 shoe assemblies (John Deere)
<u>KCF6240</u>	"6" indicates CM4063 shoe assemblies (AGCO, Case, IHC and Massey Ferguson)
<u>KCF8240</u>	"8" indicates CM4062 shoe assemblies (Angle Iron construction).
<u>KCG6240</u>	KCG indicates dual ball joint pitman drive. "6" indicates CM4063 shoes. "240" indicates the length of the barback in inches

Section 2.

SICKLE DRIVE ASSEMBLY CHART

The following chart will assist in identifying the different drive assemblies available on Love Flexible Floating Cutterbars and in clarifying which sickle drive head, sickles and components are used on which cutterbar packages.

<u>SICKLE DRIVE ASSEMBLY</u>	<u>SICKLE DRIVE HEAD</u>	<u>DRIVE SHIELD</u>	<u>CUTTERBAR PACKAGE</u>
CF2304 POSI-GUIDE REFER TO 361CF-2/95 JEL	CF2123	CF2181	KCF 1970 TO 1975
CF2305 POSI-GUIDE REFER TO 364CF-2/95 JEL	CF2123 & CF2770 1990 UTILIZE CF2770 INTERCHANGE W/CF2123	CF2181	KCF 1976 & LATER 1990 UTILIZE CF2770 INTERCHANGE W/CF2123
CF2328 POSI-ROLLER GUIDE REFER TO 366CF-3/95 JEL	CF2629	CF2325	KCG & KCQ

NOTE: Drive Head **CF2123** must be used on sickle drive assemblies equipped with CF2192 guide blocks.

Drive Head **CF2770** may be used in place of CF2123 on posi-roller guide assemblies.

Commencing 1995 Drive Head **CF2770** will replace Drive Head CQ2003.

Commencing 1995 Drive Head **CF2629** will replace Drive Head CQ2051.

Section 3.

SHOE ASSEMBLIES

Following the sickle drive information will be a shoe assembly chart identifying by shoe assembly the specific kit and which each shoe assembly will fit. Also by header width (feet), the number of shoes needed for that kit.

Section 4.

SPECIFIC MODEL KITS

Each combine make and model, header width and if needed serial number is identified by a specific model kit. Each kit contains mounting instructions and specific parts. These instructions may be ordered and added to this manual.

**SOLID PANEL CUTTERBARS, NO LIFTERS
KCF4, KCF6, KCF8, KCG4, KCG6 AND KCG8 CUTTERBAR MASTER KEY**

COMBINE MODEL	HEADER SIZE	CUTTERBAR PACKAGE	SPECIFIC MODEL KIT	DIVIDER OPTION	SLOWDOWN EQUIPMENT
A.C. GLEANER					
A, C, E, E3	12 ft.	KCF8144	AC-11		
A2, C2	12 ft.	KCF8144	AC-11		CD617
K	12 ft.	KCF8144	AC-11		CD1019
A, C, E, E3	13 ft.	KCF8156	AC-11		
A2, C2	13 ft.	KCF8156	AC-11		CD617
F, F2 G, K	13 ft.	KCF8156	AC-11		CD1019
L, M, M2	13 ft.	KCF8156	AC-12		
A, C	14 ft.	KCF8168	AC-11		
A2, C2	14 ft.	KCF8168	AC-11		CD617
F, F2, K	14 ft.	KCF8168	AC-11		CD1019
A, C	16 ft.	KCF8192	AC-11		
A2, C2	16 ft.	KCF8192	AC-11		CD617
F, F2	16 ft.	KCF8192	AC-11		CD1019
L, M, M2	16 ft.	KCF8192	AC-12		
F, F2, G	17 ft.	KCF8204	AC-11		CD1019
C	18 ft.	KCF8216	AC-11		
C2	18 ft.	KCF8216	AC-11		CD617
F, F2, G	18 ft.	KCF8216	AC-11		CD1019
L, M, M2	18 ft.	KCF8216	AC-12		
C	20 ft.	KCF8240	AC-11		
C2	20 ft.	KCF8240	AC-11		CD617
F, F2, G	20 ft.	KCF8240	AC-11		CD1019
L, L2, M, M2	20 ft.	KCF8240	AC-12		
L, L2, M, M2	22 ft.	KCF8264	AC-12		
G	23 ft.	KCF8276	AC-11		CD1019
C	24 ft.	KCF8288	AC-11		
C2	24 ft.	KCF8288	AC-11		CD617
L, L2	24 ft.	KCF8288	AC-12		
INTERNATIONAL HARVESTER (1974 thru 1981 Header (small auger) with 500 CPM sickle drive)					
615, 715, 815, 915, 1440, 1460, 1480	13 ft.	KCF6153	IH-18		CD1023*
615, 715, 815, 915, 1440, 1460, 1480	15 ft.	KCF6177	IH-15		CD1023*
715, 815, 915, 1440, 1460, 1480	16½ ft.	KCF6195	IH-18		CD1023*
715, 815, 915, 1440, 1460, 1480	17½ ft.	KCF6207	IH-18		CD1023*
715, 815, 915, 1440, 1460, 1480	20 ft.	KCF6237	IH-18+ IH-20		CD1023*
815, 915, 1440, 1460, 1480	22½ ft.	KCF6267	IH-18+ IH-24		CD1023*
815, 915, 1440, 1460, 1480	24 ft.	KCF6285	IH-18+ IH-24		CD1023*
INTERNATIONAL HARVESTER (1982 and later 810 Header (small auger) with 600 CPM sickle drive)					
1440, 1460, 1480	13 ft.	KCF6153	IH-18		CD1032+ CD1035V
1440, 1460, 1480	15 ft.	KCF6177	IH-15		CD1032+ CD1035V
1440, 1460, 1480	16½ ft.	KCF6195	IH-18		CD1032+ CD1035V
1440, 1460, 1480	17½ ft.	KCF6207	IH-18		CD1032+ CD1035V
1440, 1460, 1480	20 ft.	KCF6237	IH-18+ IH-20		CD1032+ CD1035V
1440, 1460, 1480	22½ ft.	KCF6267	IH-18+ IH-24		CD1032+ CD1035V
1440, 1460, 1480	24 ft.	KCF6285	IH-18+ IH-24		CD1032+ CD1035V

* NOTE: 810 Headers equipped with "D" width pulley require a CD 1029 Slowdown Pulley.

SOLID PANEL CUTTERBARS, NO LIFTERS KCF4, KCF6, KCF8, KCG4, KCG6 AND KCG8 CUTTERBAR MASTER KEY

COMBINE MODEL	HEADER SIZE	CUTTERBAR PACKAGE	SPECIFIC MODEL KIT	DIVIDER OPTION	SLOWDOWN EQUIPMENT
INTERNATIONAL HARVESTER (1983 and later 810 SPECIAL Header (large auger) with 600 CPM sickle drive)					
1440, 1460, 1480	13 ft.	KCF6153	IH-18+		CD1032+
			IH-37		RVC96
1440, 1460, 1480	15ft.	KCF6177	IH-15+		CD1032+
			IH-37		RVC96
1440, 1460, 1480	16½ ft.	KCF6195	IH-18+		CD1032+
			IH-37		RVC96
1440, 1460, 1480	17½ ft.	KCF6207	IH-18+		CD1032+
			IH-38		RVC96
1440, 1460, 1480	20 ft.	KCF6237	IH-18+		CD1032+
			IH-38		RVC96
1440, 1460, 1480	22½ ft.	KCF6267	IH-18+		CD1032+
			IH-39		RVC96
1440, 1460, 1480	24 ft.	KCF6285	IH-18+		CD1032+
			IH-39		RVC96
CASE-IH (with 1010 Header)					
1640, 1660, 1680	15 ft.	KCG6180	CA-15		NOTE (1)
1640, 1660, 1680	17½ ft.	KCG6210	CA-17		NOTE (1)
1640, 1660, 1680	20 ft.	KCG6240	CA-20		NOTE (1)
1640, 1660, 1680	22½ ft.	KCG6270	CA-22		NOTE (1)
1640, 1660, 1680	25 ft.	KCG6300	CA-25		NOTE (1)

⁽¹⁾1010 Header has 500 and 600 CPM options. If Header has the 600 CPM speed, replace the CASE-IH Pulley Assy. #1316045C1 with CASE-IH Pulley Assy. #1316047C1 to obtain the 500 CPM speed, recommended for operation with a LOVEBAR.

JOHN DEERE (Prior to 1976)

3300, 4400, 5500, 7700	14 ft.	KCF8165	JD-18		
3300, 4400, 6600, 6600SH, 7700	15 ft.	KCF8177	JD-18		
4400, 6600, 7700	16 ft.	KCF8189	JD-18		
4400, 6600, 6600SH 7700	18 ft.	KCF8213	JD-18		
4400, 6600, 7700	20 ft.	KCF8237	JD-18		
6600, 7700	22 ft.	KCF8261	JD-18		
7700	24 ft.	KCF8285	JD-18		

JOHN DEERE (1976 and Later Combine Models)

(3300, 4400, 4420, 6600, 6600 SideHill, 7700, 7720, 8820 with 200 Series Rigid Headers)

213	13 ft.	KCG4153	JD-90		CD1025
215	15 ft.	KCG4177	JD-90		CD1025
216	16 ft.	KCG4189	JD-90		CD1025
218	18 ft.	KCG4213	JD-90		CD1025
220	20 ft.	KCG4237	JD-90		CD1025
222	22 ft.	KCG4261	JD-90		CD1025
224	24 ft.	KCG4285	JD-90		CD1025

*NOTE: Beginning with 1991 production, LOVEBARS for John Deere 200 Series platforms will come equipped with 900 Series improvements which include heavier drive and bearing components and a double ball joint pitman. Older 200 Series LOVEBARS can be upgraded with the purchase of these parts.

JOHN DEERE (9400, 9500, 9600 with 900 Series Rigid Headers)

913	13 ft.	KCG4153	JD-90		SEE NOTE*
915	15 ft.	KCG4177	JD-90		SEE NOTE*
918	18 ft.	KCG4213	JD-90		SEE NOTE*
920	20 ft.	KCG4237	JD-90		SEE NOTE*
922	22 ft.	KCG4261	JD-90		SEE NOTE*
924	24 ft.	KCG4285	JD-90		SEE NOTE*
925	25 ft.	KCG4303	JD-90		SEE NOTE*

*NOTE: A John Deere change from round to hexagonal shafting for the sickle drive determines which 10 3/8" O.D. slowdown sheave to use. the LOVE CD1025 (round bore) is required on the following headers up to the serial number referenced: 913, - 925338; 915, - 625648; 918, - 625711; 920, - 626102; 922, - 626169; 924, - 626456; 9924HH, - 626169. 900 Series headers after serial number 635101 should be fitted with John Deere sheave #AH124526 (hex bore), 10 3/8" O.D.

SOLID PANEL CUTTERBARS, NO LIFTERS
KCF4, KCF6, KCF8, KCG4, KCG6 AND KCG8 CUTTERBAR MASTER KEY

COMBINE MODEL	HEADER SIZE	CUTTERBAR PACKAGE	SPECIFIC MODEL KIT	DIVIDER OPTION	SLOWDOWN EQUIPMENT
MASSEY FERGUSON (1968 thru 1976)					
MF 205 Ser. No. 1398 - 01162 and up; MF 300 Ser. No. 1167 - 13989 and up;					
MF 410 Ser. No. 1200 - 15063 and up; MF 510 Ser. No. 1201 - 09077 and up					
205, 300, 410, 510, 750 760	13 ft.	KCF8156	MF-18		CD1013+ CD1007V
300 410, 510, 750, 760	14 ft.	KCF8168	MF-18		CD1013+ CD1007V
410, 510, 750, 760	15 ft.	KCF8180	MF-18		CD1013+ CD1007V
410, 510, 750, 760	16 ft.	KCF8192	MF-18		CD1013+ CD1007V
410, 510, 750, 760	18 ft.	KCF8216	MF-18		CD1013+ CD1007V
510, 750, 760	20 ft.	KCF8240	MF-18+ MF-24		CD1013+ CD1007V
510, 750, 760	24 ft.	KCF8288	MF-18+ MF-24		CD1013+ CD1007V
MASSEY FERGUSON (1977 and Later with 1859 Series Headers)					
510, 540, 550, 750, 760, 850, 860	13 ft.	KCF8156	MF-20		CD1013+ CD1007V
510, 540, 550, 750, 760, 850, 860	14 ft.	KCF8168	MF-20		CD1013+ CD1007V
510, 540, 550, 750, 760, 850, 860	15 ft.	KCF8180	MF-20		CD1013+ CD1007V
510, 540, 550, 750, 760, 850, 860	16 ft.	KCF8192	MF-20		CD1013+ CD1007V
510, 540, 550, 750, 760, 850, 860	18 ft.	KCF8216	MF-20		CD1013+ CD1007V
510, 540, 550, 750, 760, 850, 860	20 ft.	KCF8240	MF-20+ MF-24		CD1013+ CD1007V
510, 540, 550, 750, 760, 850, 860	24 ft.	KCF8288	MF-20+ MF-24		CD1013+ CD1007V
MASSEY FERGUSON with 2381 Series Headers					
850, 860	20 ft.	KCF6240	MF-40		NOTE*
850, 860	22 ft.	KCF6264	MF-41		NOTE*
850, 860	24 ft.	KCF6288	MF-41		NOTE*
MASSEY FERGUSON with 9000 Series Headers					
850, 860	20 ft.	KCF6240	MF-42		NOTE*
850, 860	22 ft.	KCF6264	MF-43		NOTE*
850, 860	24 ft.	KCF6288	MF-43		NOTE*
*NOTE: Slowdown equipment for MF2381 and 9000 Series Headers is included in the Specific Model Kits. Specifically, the MF-40 and MF-41 Kits contain 1 - CD1034V Belt and 1 - CD1037 Pulley. The MF-42 and MF-43 Kits contain 1 - CD1035V Belt and 1 - CD1040 Pulley.					
NEW HOLLAND (Prior to 1968)					
980, 990	13 ft.	KCF8159	NH-11		
980, 990	14ft.	KCF8165	NH-11		
980, 990	15 ft.	KCF8183	NH-11		
980, 990	16 ft.	KCF8195	NH-11		
980, 990	17 ft.	KCF8207	NH-11		
980, 990	18 ft.	KCF8219	NH-11		
980, 990	19 ft.	KCF8231	NH-11		
980, 990	22 ft.	KCF8267	NH-11		

**SOLID PANEL CUTTERBARS, NO LIFTERS
KCF4, KCF6, KCF8, KCG4, KCG6 AND KCG8 CUTTERBAR MASTER KEY**

COMBINE MODEL	HEADER SIZE	CUTTERBAR PACKAGE	SPECIFIC MODEL KIT	DIVIDER OPTION	SLOWDOWN EQUIPMENT
NEW HOLLAND (1968 and Later Except 960 Quick Attach Header)					
975, 985, 995.....	13 ft.	KCF8159	NH-12		
975, 985, 995.....	15 ft.	KCF8183	NH-12		
985, 995.....	17 ft.	KCF8207	NH-12		
985, 995.....	19 ft.	KCF8231	NH-12		
995.....	22 ft.	KCF8267	NH-12		
NEW HOLLAND (1972 and Later with 960 Quick Attach Header)					
975, 985, 995.....	13 ft.	KCF8159	NH-13		
1400, 1500.....	13 ft.	KCF8159	NH-13		CD1022
TR70, TR75, TR85, TR95	13 ft.	KCF8159	NH-13		CD1027
975, 985, 995.....	15 ft.	KCF8183	NH-13		
1400, 1500.....	15 ft.	KCF8183	NH-13		CD1022
TR70, TR75, TR85, TR95	15 ft.	KCF8183	NH-13		CD1027
975, 985, 995.....	17 ft.	KCF8207	NH-13		
1400, 1500.....	17 ft.	KCF8207	NH-13		CD1022
TR70, TR75, TR85, TR95	17 ft.	KCF8207	NH-13		CD1027
985, 995.....	19 ft.	KCF8231	NH-13		
1400, 1500.....	19 ft.	KCF8231	NH-13		CD1022
TR70, TR75, TR85, TR95	19 ft.	KCF8231	NH-13		CD1027
985, 995.....	20 ft.	KCF8243	NH-13		
1400, 1500.....	20 ft.	KCF8243	NH-13		CD1022
TR70, TR75, TR85, TR95	20 ft.	KCF8243	NH-13		CD1027
995.....	22 ft.	KCF8267	NH-13		
1400, 1500.....	22 ft.	KCF8267	NH-13		CD1022
TR70, TR75, TR85, TR95	22 ft.	KCF8267	NH-13		CD1027

SECTION 1

CUTTERBAR PACKAGE

**KCF4, KCF6, KCF8, KCG4, KCG6 AND KCG8
CUTTERBAR PACKAGE
BARBACK, SICKLE AND ROW SKID**

<u>CUTTERBAR PACKAGE NUMBER</u>	<u>HEADER WIDTH (FEET)</u>	<u>BARBACK NUMBER</u>	<u>BLACK SICKLE NUMBER (1)</u>	<u>CHROME SICKLE NUMBER (1)</u>	<u>NO. OF SHOES</u>	<u>NO. OF ROW SKIDS</u>
-141	12	CF7141	CG12B	CG12C	4	1
-144	12	CF7144	CG12B	CG12C	4	1
-147	12-1/2	CF7147	CG12B	CG12C	4	1
-150	13	CF7150	CG13B	CG13C	4	1
-153	13	CF7153	CG13B	CG13C	4	1
-156	13	CF7156	CG13B	CG13C	4	1
-159	13	CF7159	CG13B	CG13C	4	1
-165	14	CF7165	CG14B	CG14C	4	1
-168	14	CF7168	CG14B	CG14C	4	1
-171	14	CF7171	CG14B	CG14C	4	1
-174	14-1/2	CF7174	CG15B	CG15C	5	2
-177	15	CF7177	CG15B	CG15C	5	2
-180	15	CF7180	CG15B	CG15C	5	2
-183	15	CF7183	CG15B	CG15C	5	2
-189	16	CF7189	CG16B	CG16C	5	2
-192	16	CF7192	CG16B	CG16C	5	2
-195	16-1/2	CF7195	CG16B	CG16C	5	2
-201	16-1/2	CF7201	CG17B	CG17C	6	2
-204	17	CF7204	CG17B	CG17C	6	2
-207	17-1/2	CF7207	CG17B	CG17C	6	2
-210	17/17-1/2	CF7210	CG17B	CG17C	6	2
-213	18	CF7213	CG18B	CG18C	6	3
-216	18	CF7216	CG18B	CG18C	6	3
-219	18	CF7219	CG18B	CG18C	6	3
-225	18-1/2/19	CF7225	CG19B	CG19C	6	3
-228	19	CF7228	CG19B	CG19C	6	3
-231	19	CF7231	CG19B	CG19C	6	3
-237	20	CF7237	CG20B	CG20C	6	4
-240	20	CF7240	CG20B	CG20C	6	4
-243	20	CF7243	CG20B	CG20C	6	4
-261	22	CF7261	CG22B	CG20C	7	4
-264	22	CF7264	CG22B	CG22C	7	4
-267	22-1/2	CF7267	CG22B	CG22C	7	4
-270	22-1/2	CF7270	CG22-1/2B	CG22-1/2C	7	4
-276	23	CF7276	CG23B	CG23C	7	4
-285	24	CF7285	CG24B	CG24C	7	4
-288	24	CF7288	CG24B	CG24C	7	4
-291	24	CF7291	CG25B	CG25C	7	4
-300	25	CF7300	CG25B	CG25C	7	4
-303	25	CF7303	CG25B	CG25C	7	4

(1) "B" SICKLES ARE BLACK SECTIONS
"C" SICKLES ARE CHROME SECTIONS

KCF4, KCF6, KCF8, KCG4, KCG6 AND KCG8 COMMON PARTS LISTING

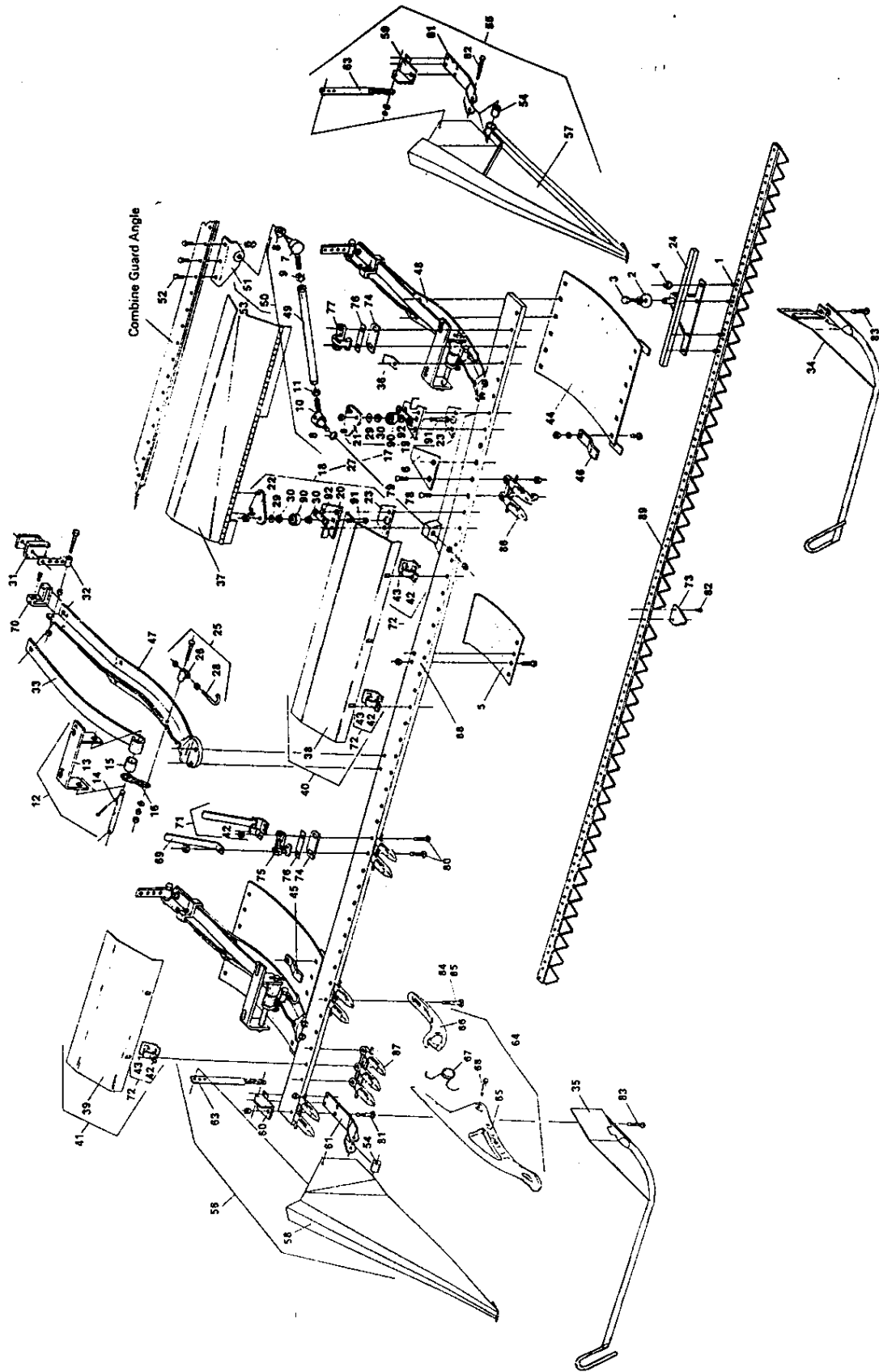

LEVEL LAND BARS
COMMON PARTS DIAGRAM

KCF4, KCF6, KCF8, KCG4, KCG6 AND KCG8 COMMON PARTS LISTING

KEY	PART NO.	DESCRIPTION	WEIGHT LBS.	KEY	PART NO.	DESCRIPTION	WEIGHT LBS.
1	CD203	Stud, sickle 7/16" dia.	1/16	62		7/16" UNC x 3/4 cap screw w/lock nut	1/4
2	CD218	Steel Washer	1/16	63	CF7080	Linkage, adjusting	1/4
3		Cap Screw, 1/2" x 1" w/LW	3/4	64	No. 2	Lifter, complete	3 3/4
4		7/16" Hex Nut, knife head	1/16	65		Head, lifter	2 1/4
5	CD250	Row Skid	4 1/2	66	E11	Shank, lifter	1
6	CD291	Wear Plate, knife head	3/4	67	E12	Spring, lifter	1/16
7	CD550	Balljoint, R.H.	1 3/4	68	E13	Bolt, lifter	1/16
8	CD550R	Seal, rubber	3/4	69	L5	Feather, fixed, optional	1/4
9	CD552	Nut, jam, R.H.	1/16	70	L17H	Clip, shoe spring	1/4
10	CD553	Balljoint, L.H.	1 3/4	71	L55	Feather, hinged, optional	3/4
11	CD574	Nut, jam, L.H.	1/16	72	L61	Hinge Assy., shield	1/4
12	CF2101	Front Shoe Hanger Assembly	2 3/4	73	L192D	Section, sickle, std. 25/box	4/box
13	CF2101A	Front Shoe Hanger Frame, only	1 1/2		L192DC	Section, sickle, chrome. 25/box	4/box
14	CF2101B	Front Shoe Hanger Pin w/cotter keys	3/4	74	L220	Wear Plate, std.	1/4
15	CF2101C	Front Shoe Hanger Spacer	1/2	75	L221*	Knife Clip, std.	3/4
16	CF2102	Chain, shoe suspension, 4 links	3/4	76	L221S	Shim, knife clip	1/16
17	CF2112	Roller Guide Assy., Left	3 1/2	77	L222*	Knife Clip, high bridge	3/4
18	CF2113	Roller Guide Assy., Right	3 1/2	78	L315	Guard Bolt, 7/16 x 1 1/4, 25/box	2 1/2
19	CF2114	Bottom Plate, left	1	79	L316	Guard Bolt, 7/16" x 1 3/4", 25/box	2 1/2
20	CF2115	Bottom Plate, right	1	80	L318	Guard Bolt, 7/16" x 1 3/4", 25/box	2 3/4
21	CF2116	Top Plate, left	1	81	L321	Guard Bolt, 7/16" x 1 3/4", 25/box	2 3/4
22	CF2117	Top Plate, right	1	82	L325B	Rivet, CSK 5/2 x 9/16", 1 lb./box	1
23	CF2119	Spacer Plate	3/4	83	L334	Bolt, carriage, 7/16" x 2", 25/box	3 1/2
24	CF2123	Knife Head, Posi-Guide w/CS & washer	6 3/4	84	L335	Bolt, carriage, 7/16" x 2 1/4", 25/box	3 3/4
25	CF2124	Shoe Lockup Assy.	3/4	85	L336	Bolt, carriage, 7/16" x 2 1/4", 25/box	4 1/2
26	CF2125	Swivel, shoe lockup	1	86	LB208**	Guard, drop forged, double	1 1/4
27	CF2126	Roller Guide Set	7	87	LB209**	Guard, drop forged, triple	1 3/4
28	CF2127	J-Bolt, shoe lockup	1	88		Barback (refer to make & model)	4-Ft.
29	CF2128	Machine Bushing	—	89		Sinkle (refer to make & model)	1 3/4-Ft.
30	CF2129	Bushing, bearing	1/16	90	H7022	Bearing, roller guide	1/4
31	CF2142	U-Clamp, rear mounting tube	1 1/2	91	CF2132	Bolt, carriage, 7/16" x 1 3/4" UNC	1/4
32	CF2143	Attaching Link, rear, 5"	1 1/2	92	CF2118	Wear Plate	1/4
33	CF2154	Short Shoe Spring, eye type	3				
34	CF2161	Divider, left, optional	3 3/4				
35	CF2162	Divider, right, optional	3 3/4				
36	CF2180	Shield Stop	1				
37	CF2181	Shield, LED, std.	9				
38	CF2185	Shield, std.	7				
39	CF2186	Shield, short	4 3/4				
40	CF2187	Shield Assy., std.	7 1/4				
41	CF2188	Shield Assy., short	5 1/2				
42	CF2189	Hinge Holddown, shield	1 1/2				
43	CF2190	Hinge, shield	1 1/2				
44	CF7005	Shoe Skid 18", std.	11 3/4				
45	CF7009	Skid Support Clip, std.	1 1/2				
46	CF7010	Skid Support Clip, drive end	1 1/2				
47	CF7023	Short Shoe, frame only	10 1/4				
48	CF7065	Short Shoe Assembly, 4"	14 3/4				
49	CF7034	Coupler, radius rod	2 1/2				
50	CF7035	Radius Rod Assembly	4 1/2				
51	CF7050	Header Anchor, radius rod	1 1/2				
52		3/8" x 1 1/4" Combine Guard Bolts, 3 used w/double nut	1 1/2				
53	CF7051	Radius Rod Assembly kit	7				
54	CF7069	Sleeve, outer divider pivot	1 1/2				
55	CF7070	Divider, left, complete	16				
56	CF7071	Divider, right, complete	16				
57	CF7072	Divider Frame, left	11 1/2				
58	CF7073	Divider Frame, right	11 1/2				
59	CF7074	Bracket, left top barback	3/4				
60	CF7075	Bracket, right top barback	3/4				
61	CF7076	Attaching Plate, guard	2 3/4				

KEY	PART NO.	DESCRIPTION
	CF2305	Posi-Roller Guide Sickle Drive Assembly
	NO. PART	
	USED NO.	
4	4	7/16" Hex Nut, knife head
24	1	CF2123 Knife Head, Posi-Guide
6	1	CD291 Wear Plate, knife head
27	1	CF2126 Roller Guide Set
37	1	CF2180 Shield Stop
38	1	CF2181 Drive Shield

* L221 Knife clip interchanges with L216
L222 Knife clip interchanges with L219

** LB208 & LB209 Drop forged guards may be used to replace LB205 Ledger plate guards. The LB205 Ledger plate guard will not replace LB208 or LB209 guards. One LB208 replaces two LB205 guards.

SECTION 2

SICKLE DRIVE ASSEMBLIES

KCF4, KCF6, KCF8, KCG4, KCG6 AND KCG8 SICKLE DRIVE ASSEMBLY CHART

LOVE FLEXIBLE FLOATING CUTTERBAR SICKLE DRIVE ASSEMBLY CHART

The following chart will assist in identifying the different drive assemblies available on Love Flexible Floating Cutterbars and clarifying which sickle drive head, sickles and components are used on which cutterbar packages.

<u>SICKLE DRIVE ASSEMBLY</u>	<u>SICKLE DRIVE HEAD</u>	<u>DRIVE SHIELD</u>	<u>CUTTERBAR PACKAGE</u>
CF2304 POSI-GUIDE REFER TO 361CF-2/95 JEL	CF2123	CF2181	KCF 1970 TO 1975
CF2305 POSI-ROLLER GUIDE REFER - 364CF-2/95 JEL	CF2123 & CF2770 1990 UTILIZE CF2770 INTERCHANGE W/CF2123	CF2181	KCF 1976 & LATER 1990 UTILIZE CF2770 INTERCHANGE W/CF2123
CF2328 POSI-ROLLER GUIDE REFER TO 366CF- 3/95 JEL	CF2629	CF2325	KCG AND KCQ

Note: Drive head CF2123 must be used on sickle drive assemblies equipped with CF2192 guide blocks.

Drive Head: CF2770 may be used in place of CF2123 on posi-roller guide assemblies.

Commencing 1995 Drive Head CF2770 will replace drive head CQ2003.

**KCF4, KCF6, KCF8, KCG4, KCG6 AND KCG8
POSI-GUIDE SICKLE DRIVE ASSEMBLY
CF2304**

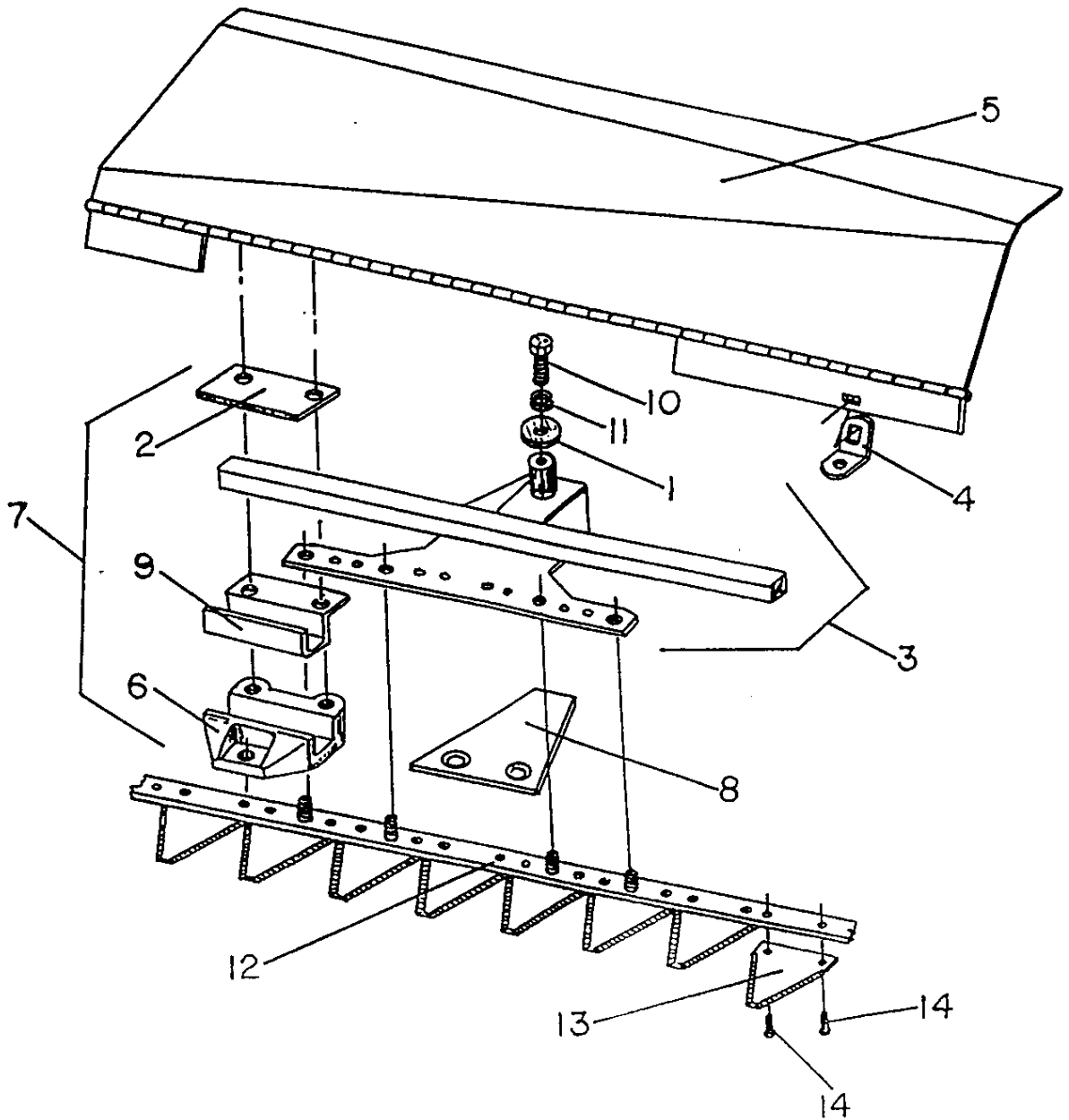

POSI-GUIDE SICKLE DRIVE ASSEMBLY

CF2304

USED ON LOVEBARS 1970 THROUGH 1975
(CF INDICATES DRIVE IS LOCATED AT GUARD HOLES 9, 10, 11, 12)

<u>KEY</u>	<u>PART NO</u>	<u>DESCRIPTION</u>
1	CD218	WASHER, STEEL
2	CD296	COVER PLATE, GUIDE
3	CF2123	KNIFE HEAD, W/C'S & WASHERS
4	CF2180	CLIP, HINGE STOP
5	CF2181	SHIELD, DRIVE STD.
6	CF2191	GUIDE, LESS COVER PLATE & SHIM
7	CF2192	GUIDE, W/COVER PLATE & SHIM, ALUMINUM
8	CQ2004	WEAR PLATE, DRIVE
9	R10361	SHIM, GUIDE BLOCK
10	X2A0500100	CAP SCREW, 1/2" X 1" UNC
11	X3B050	WASHER, LOCK 1/2"
12	CFXXB	SICKLE, L192D SECTIONS OF "XX" LENGTH
	CFXXC	SICKLE, L192DC SECTIONS OF "XX" LENGTH IN FT.
13	L192D	SECTION, BLACK
	L192DC	SECTION, CHROME
14	L325B	RIVET, 5-1/2 X 3/4 CSK
12	CGXXB	SICKLE, L193 SECTIONS OF "XX" LENGTH IN FT.
	CGXXC	SICKLE, L193C SECTIONS OF "XX" LENGTH IN FT.
13	L193	SECTION, BLACK
	L193C	SECTION, CHROME
14	L326C	RIVET, ROUND HEAD

POSI-ROLLER GUIDE SICKLE DRIVE ASSEMBLY
CF2305
USED ON LOVE BARS 1976 & LATER
(CF INDICATES DRIVE IS LOCATED AT GUARD HOLES 9, 10, 11, 12)

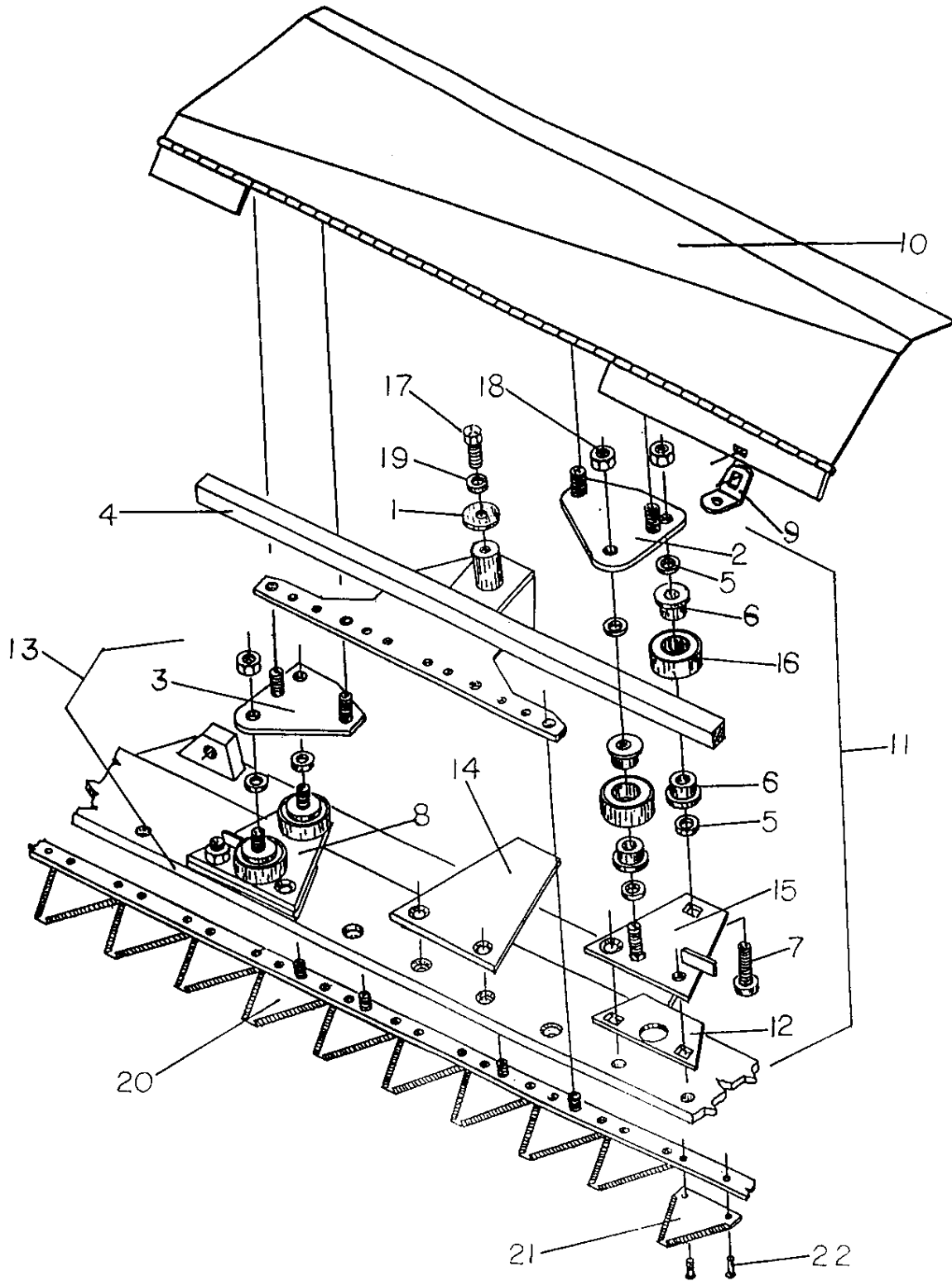

POSI-ROLLER GUIDE SICKLE DRIVE ASSEMBLY CF2305

USED ON LOVE BARS 1976 & LATER
(CF INDICATES DRIVE IS LOCATED AT GUARD HOLES 9, 10, 11, 12)

<u>KEY</u>	<u>PART NO</u>	<u>DESCRIPTION</u>
1	CD218	WASHER, STEEL
2	CF2116	TOP PLATE, LEFT SIDE
3	CF2117	TOP PLATE, RIGHT SIDE
4	CF2123	DRIVE HEAD, SICKLE (MUST USE WITH CF2192 GUIDE)
	CF2770	DRIVE HEAD, SICKLE (OPTIONAL WITH POSI-ROLLER GUIDE DRI
5	CF2128	MACHINE BUSHING
6	CF2129	BEARING BUSHING
7	CF2132	CARRIAGE BOLT, 7/16-14 UNC, MODIFIED
8	CF2146	BOTTOM PLATE, RIGHT SIDE
9	CF2180	CLIP, HINGE STOP
10	CF2181	SHIELD, DRIVE STD.
11	CF2212	GUIDE ASSEMBLY, LEFT SIDE
12	CF2219	SPACER PLATE
13	CF2245	GUIDE ASSEMBLY, RIGHT SIDE
14	CQ2004	WEAR PLATE, DRIVE HEAD
15	CQ2005	BOTTOM PLATE, LEFT SIDE
16	H7022	BEARING
17	X2A0500100	CAP SCREW, 1/2" X 1"
18	X2E043	NUT, JAM 7/16-14 UNC
19	X3B050	WASHER, 1/2"

NOTE:

CF SICKLES Are assembled with flat head rivets L325B and uses L192D sections which are countersunk. L192D sections with L325B rivets can be used on CG sickles as replacement parts. Both CF & CG sickles drive head locations are at 9, 10, 11, 12 sections in from left end (first sickle stud at 25-1/2" from left end.)

20	CFXXB	SICKLE, L192D SECTIONS OF "XX" LENGTH
	CFXXC	SICKLE, L192DC SECTIONS OF "XX" LENGTH IN FT.
21	L192D	SECTION, BLACK
	L192DC	SECTION, CHROME
22	L325B	RIVET, 5-1/2 X 3/4 CSK

CG SICKLES Are assembled with oval head rivets instead of flat head rivets. The sickles use L193 sections which are not countersunk. CG sickles are interchangeable with CF sickles on Cutterbars equipped with LB214 guards.

20	CGXXB	SICKLE, L193 SECTIONS OF "XX" LENGTH IN FT.
	CGXXC	SICKLE, L193C SECTIONS OF "XX" LENGTH IN FT.
21	L193	SECTION, BLACK
	L193C	SECTION, CHROME
22	L326C	RIVET, ROUND HEAD

**KCG-LEVEL LAND SOYBEAN CUTTERBAR PACKAGE
 POSI-ROLLER GUIDE SICKLE DRIVE ASSEMBLY - CF2328
 USED ON DUAL BALL JOINT DRIVES
 (CF INDICATES DRIVE IS LOCATED AT GUARD HOLES 9, 10, 11, 12)**

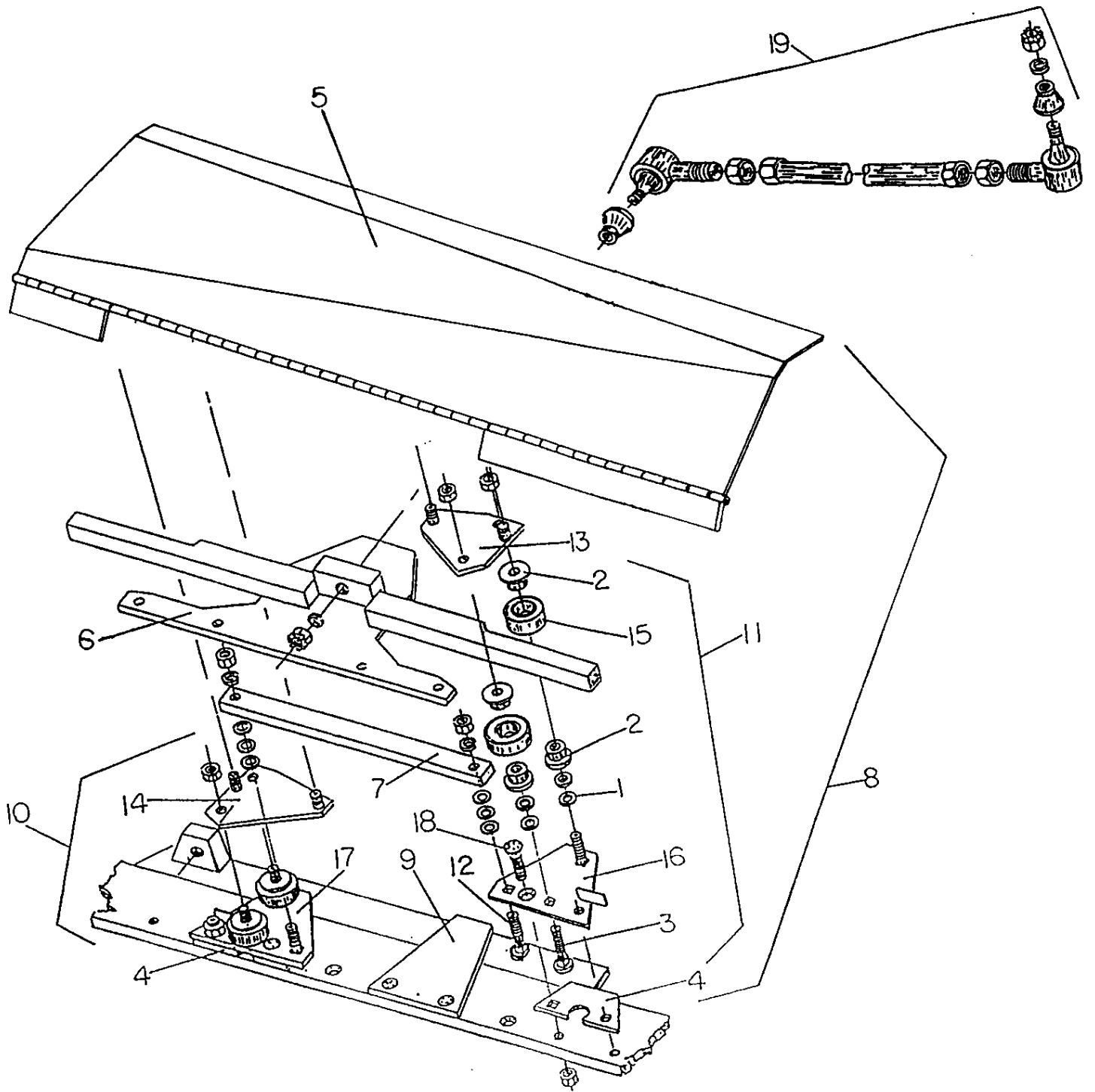

**POSI-ROLLER GUIDE SICKLE DRIVE ASSEMBLY - CF2328
USED ON DUAL BALL JOINT DRIVES**

<u>KEY</u>	<u>PART NO</u>	<u>DESCRIPTION</u>
1	CF2128	MACHINE BUSHING
2	CF2129	BEARING BUSHING
3	CF2132	CARRIAGE BOLT, 7/16-14 UNC X 1-3/4", MODIFIED
4	CF2219	SPACER PLATE
5	CF2325	SHIELD, DRIVE END
6	CF2629	DRIVE HEAD, SICKLE, DUAL BALL JOINT
7	CF2649	BAR, SICKLE HEAD HOLD DOWN
8	CF2328	POSI-ROLLER GUIDE SICKLE DRIVE ASSEMBLY
9	CQ2004	WEAR PLATE, DRIVE HEAD
10	CQ2053	POSI-ROLLER GUIDE ASSY., RIGHT SIDE
11	CQ2054	POSI-ROLLER GUIDE ASSY., LEFT SIDE
12	CQ2055	CARRIAGE BOLT, 7/16"-14 UNC X 1-1/2", MODIFIED
13	CQ2056	TOP PLATE, LEFT SIDE
14	CQ2057	TOP PLATE, RIGHT SIDE
15	CQ2060	BEARING, POSI-ROLLER GUIDE
16	CQ2061	BOTTOM PLATE, LEFT SIDE
17	CQ2062	BOTTOM PLATE, RIGHT SIDE
18	L318	GUARD BOLT, 7/16 UNF X 1-5/8"
19		PITMAN, DUAL BALL JOINT (NOT INCLUDED IN PRG. ASSEMBLY CF2328, REFER TO SPECIFIC MODEL KIT.)

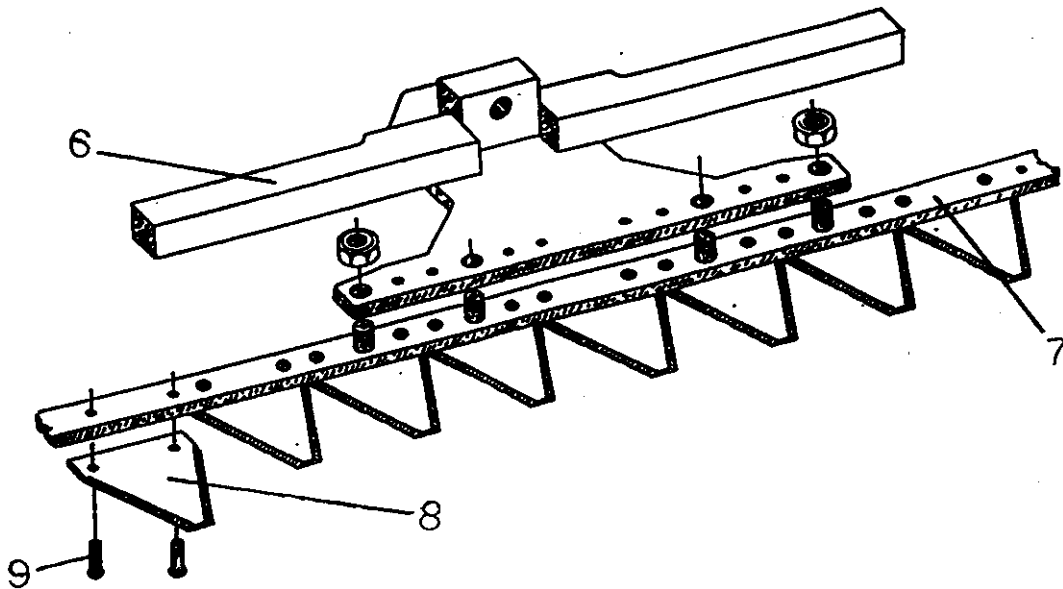

CF SICKLES Are assembled with flat head rivets L325B and uses L192D sections which are countersunk. L192D sections with L325B rivets can be used on CG sickles as replacement parts. Both CF & CG sickles drive head locations are at 9, 10, 11, 12 sections in from left end (first sickle stud at 25-1/2" from left end.)

7	CFXXB	SICKLE, L192D SECTIONS OF "XX" LENGTH
	CFXXC	SICKLE, L192DC SECTIONS OF "XX" LENGTH IN FT.
8	L192D	SECTION, BLACK
	L192DC	SECTION, CHROME
9	L325B	RIVET, 5-1/2 X 3/4 CSK

**POSI-ROLLER GUIDE SICKLE DRIVE ASSEMBLY - CF2328, CONTINUED:
USED ON DUAL BALL JOINT DRIVES**

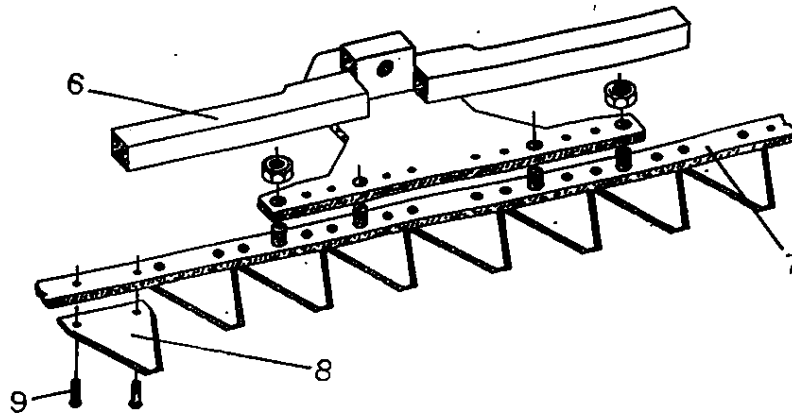

KEY	PART NO.	DESCRIPTION
6	CF2629	DRIVE HEAD, POSI-ROLLER GUIDE (COMMENCING 1995 CF2629 WILL REPLACE CQ2051)

CG SICKLES Are assembled with oval head rivets instead of flat head rivets. The sickles use L193 sections which are not countersunk. CG sickles are interchangeable with CF sickles on Cutterbars equipped with LB214 guards.

KEY	PART NO.	DESCRIPTION
7	CGXXB	SICKLE, L193 SECTIONS OF "XX" LENGTH IN FT.
	CGXXC	SICKLE, L193C SECTIONS OF "XX" LENGTH IN FT.
8	L193	SECTION, BLACK
	L193C	SECTION, CHROME
9	L326C	RIVET, ROUND HEAD

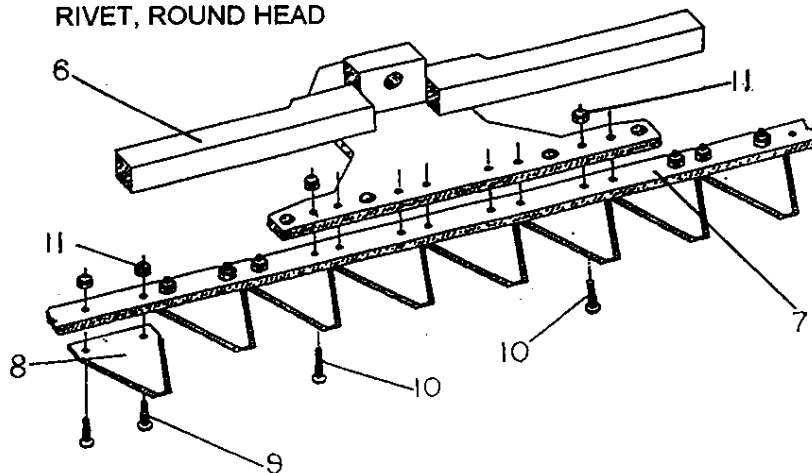

CGB SICKLES Are assembled with section bolts instead of rivets. The sickles use L193 sections which are not countersunk. CGB sickles are interchangeable with CF & CG sickles on Cutterbars equipped with LB214 guards and L221A knife clips. Sickle drive head must be able to accommodate section bolts as the CGB sickle does not have 4 studs for sickle drive head. Commencing 1995 CF2770 Drive Heads will replace CQ2003 Drive Heads.

7	CGBXXB	SICKLE, BOLT ON L193 SECTIONS OF "XX" LENGTH IN FEET
	CGBXXC	SICKLE, BOLT ON L193C SECTIONS OF "XX" LENGTH IN FEET
8	L193	SECTION, BLACK
	L193C	SECTION, CHROME PLATED
9	X2NS1	BOLT, SECTION
10	X2NS3	BOLT, DRIVE HEAD
11	X2NS2	NUT, SECTION & DRIVE HEAD

**SPECIFIC MODEL
DUAL BALL JOINT PITMAN DRIVE
AGCO - SERIES 3 HEADERS
SER. NO 19301 & LATER**

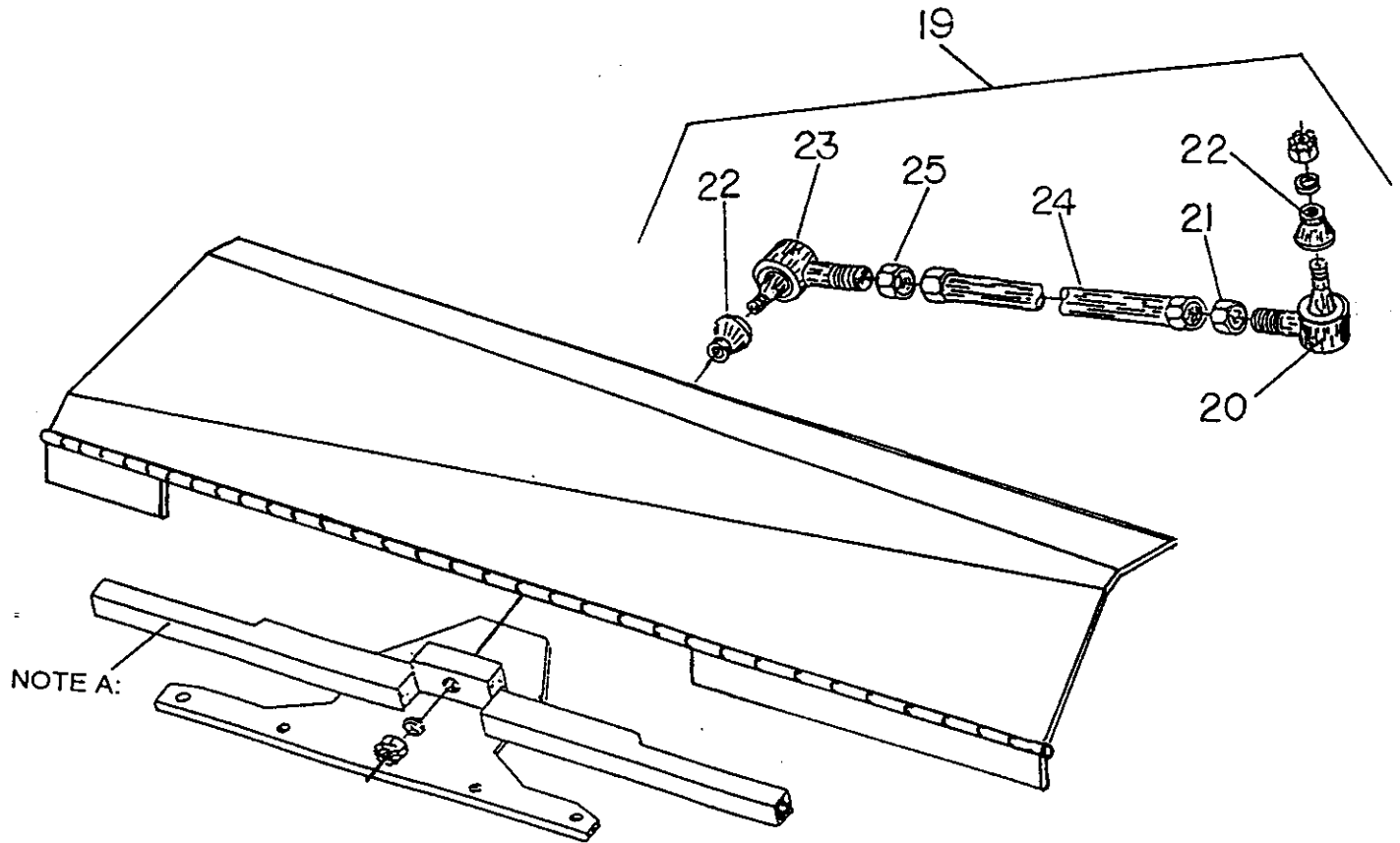

<u>KEY</u>	<u>PART NO.</u>	<u>DESCRIPTION</u>
19	CF2656	PITMAN, COMPLETE
20	CD500	BALL JOINT, 7/8" -18 RH
21	CD500A	JAM NUT, 7/8 -18 RH
22	CD500R	RUBBER SEAL
23	CD565	BALL JOINT, 7/8" -18 LH
24	CF2655	PITMAN, TUBE ONLY
25	R10128	JAM NUT, 7/8" -18 LH

NOTE A: COMMENCING 1995 CF2629 DRIVE HEAD POSI-ROLLER GUIDE WILL REPLACE DRIVE HEAD CQ2051.

**SPECIFIC MODEL
DUAL BALL JOINT PITMAN DRIVE
CASE/IH 1010 HEADERS**

CA-15 THROUGH CA-25

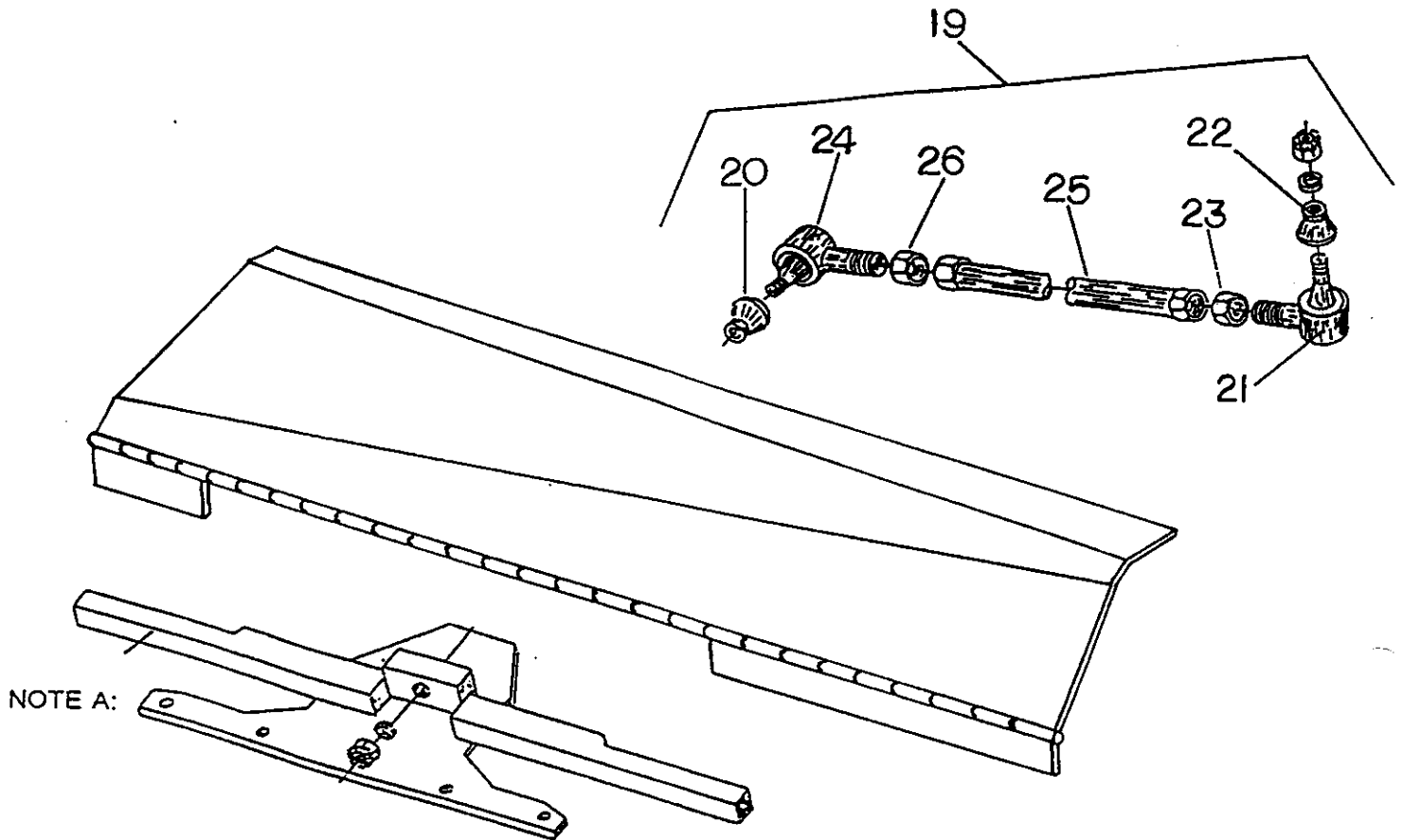

<u>KEY</u>	<u>PART NO.</u>	<u>DESCRIPTION</u>
19	CF2637	PITMAN, COMPLETE
20	CD500R	RUBBER SEAL
21	CD535	BALL JOINT, 1" -16 RH
22	CD535R	RUBBER SEAL
23	CD537	JAM NUT, 1" -16 RH
24	CD565	BALL JOINT, 7/8" -18 LH
25	CF2631	PITMAN, TUBE ONLY
26	R10128	JAM NUT, 7/8" -18 LH

NOTE A: COMMENCING 1995 CF2629 DRIVE HEAD POSI-ROLLER GUIDE WILL REPLACE DRIVE HEAD CQ2051.

**SPECIFIC MODEL
DUAL BALL JOINT PITMAN DRIVE
JOHN DEERE 200 & 900 SERIES HEADERS**

JD 90

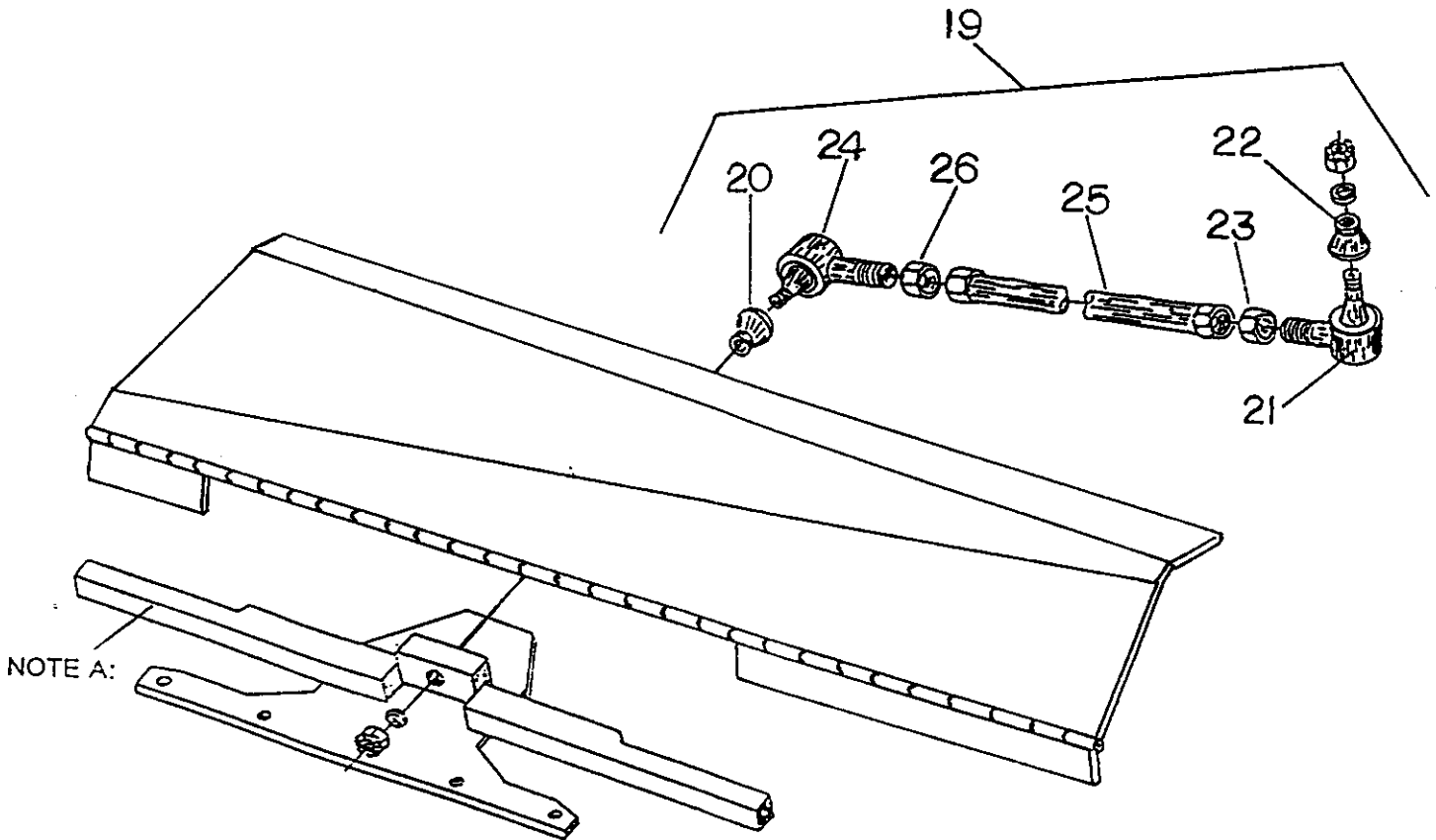

<u>KEY</u>	<u>PART NO</u>	<u>DESCRIPTION</u>
19	CF2652	PITMAN, COMPLETE
20	CD500R	RUBBER SEAL
21	CD535	BALL JOINT, 1" -16 RH
22	CD535R	RUBBER SEAL
23	CD537	JAM NUT, 1" -16 RH
24	CD565	BALL JOINT, 7/8" -18 LH
25	CF2653	PITMAN, TUBE ONLY
26	R10128	JAM NUT, 7/8" -18 LH

NOTE A: COMMENCING 1995 CF2629 DRIVE HEAD POSI-ROLLER GUIDE WILL REPLACE DRIVE HEAD CQ2051.

SECTION 3

SHOE ASSEMBLIES

KCF4, KCF6, KCF8, KCG4, KCG6 AND KCG8 SHOE ASSEMBLY CHART

SHOE ASSEMBLY CF7065

CUTTERBAR ASSY NUMBER	HEADER WIDTH (FT)	NUMBER OF SHOES	CUTTERBAR ASSY NUMBER	HEADER WIDTH (FT)	NUMBER OF SHOES
KCF,KCG8081	7	2	KCF,KCG8192	16	5
KCF,KCG8096	8	3	KCF,KCG8195	16-1/2	5
KCF,KCG8099	8	3	KCF,KCG8201	16-1/2	5
KCF,KCG8105	9	3	KCF,KCG8204	17	6
KCF,KCG8111	9	3	KCF,KCG8207	17-1/2	6
KCF,KCG8117	10	3	KCF,KCG8210	17	6
KCF,KCG8120	10	3	KCF,KCG8213	18	6
KCF,KCG8123	10	3	KCF,KCG8216	18	6
KCF,KCG8126	10	3	KCF,KCG8219	18	6
KCF,KCG8132	11	3	KCF,KCG8225	18-1/2	6
KCF,KCG8135	11	3	KCF,KCG8228	19	6
KCF,KCG8141	12	4	KCF,KCG8231	19	4
KCF,KCG8144	12	4	KCF,KCG8237	20	6
KCF,KCG8147	12-1/2	4	KCF,KCG8240	20	6
KCF,KCG8150	13	4	KCF,KCG8243	20	6
KCF,KCG8153	13	4	KCF,KCG8261	22	7
KCF,KCG8156	13	4	KCF,KCG8264	22	7
KCF,KCG8159	13	4	KCF,KCG8267	22-1/2	7
KCF,KCG8165	14	4	KCF,KCG8270	22-1/2	7
KCF,KCG8168	14	4	KCF,KCG8276	23	7
KCF,KCG8171	14	4	KCF,KCG8285	24	7
KCF,KCG8174	14-1/2	4	KCF,KCG288	24	7
KCF,KCG8177	14-1/2	5	KCF,KCG8291	24	7
KCF,KCG8180	15	5	KCF,KCG8300	25	7
KCF,KCG8183	15	5	KCF,KCG8303	25	7
KCF,KCG8189	16	5			

SHOE ASSEMBLY CM4062

SHOE ASSEMBLY CM4063

CUTTERBAR ASSY NUMBER	HEADER WIDTH (FT)	NUMBER OF SHOES	CUTTERBAR ASSY NUMBER	HEADER WIDTH (FT)	NUMBER OF SHOES
KCF,KCG4153	13	4	KCF,KCG6117	10	3
KCF,KCG4177	15	5	KCF,KCG6147	12	4
KCF,KCG4189	16	5	KCF,KCG6153	13	4
KCF,KCG4213	18	6	KCF,KCG6177	14-1/2	5
KCF,KCG4237	20	6	KCF,KCG6195	16-1/2	5
KCF,KCG4261	22	6	KCF,KCG6207	17-1/2	6
KCF,KCG4285	24	7	KCF,KCG6210	17-1/2	6
KCF,KCG4303	25	7	KCF,KCG6237	20	6
			KCF,KCG6240	20	6
			KCF,KCG6246	21	6
			KCF,KCG6264	22	7
			KCF,KCG6267	22-1/2	7
			KCF,KCG6270	22-1/2	7
			KCF,KCG6285	24	7
			KCF,KCG6288	24	7
			KCF,KCG6300	25	7

KCF4, KCF6, KCF8, KCG4, KCG6 AND KCG8 CF7065 SHOE ASSEMBLY

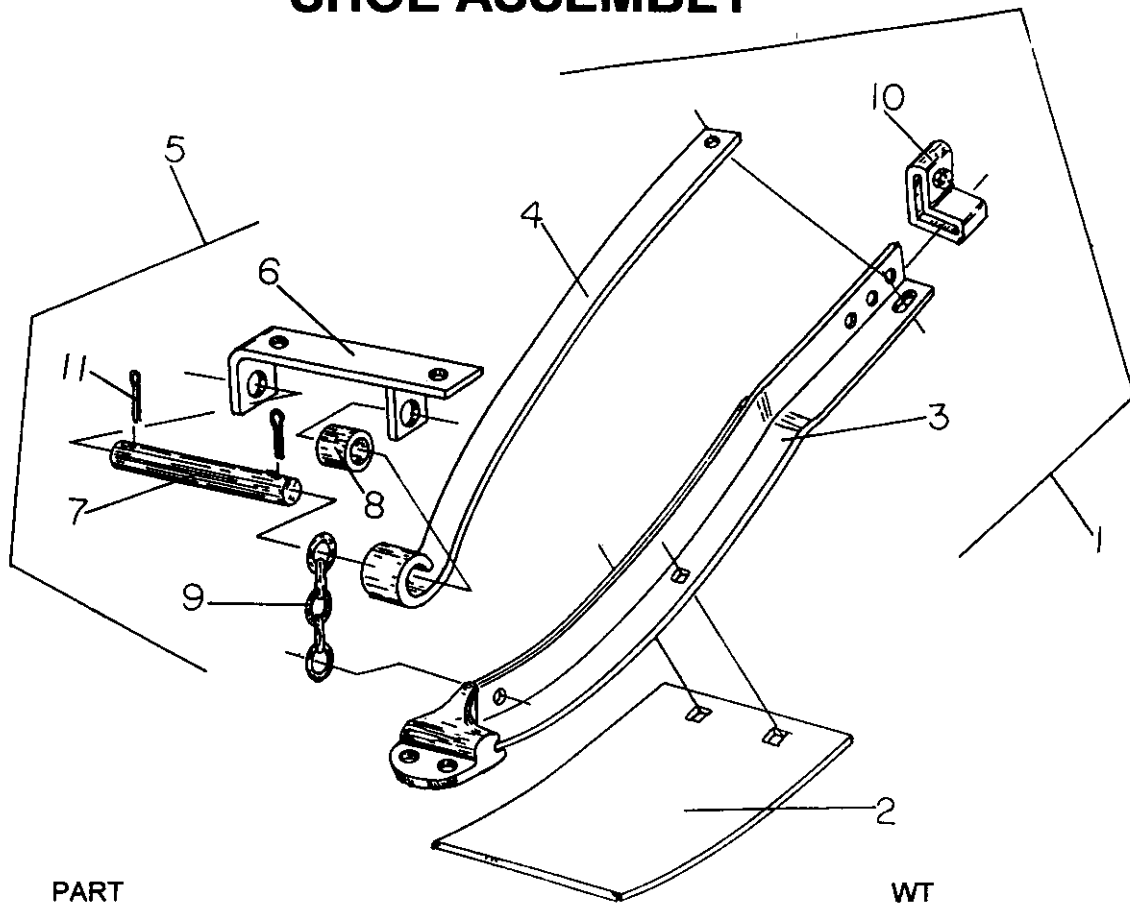

<u>KEY</u>	<u>PART NUMBER</u>	<u>DESCRIPTION</u>	<u>WT LBS.</u>
1	CF7065	SHOE ASSEMBLY	19.00
2	CF7005	SHOE SKID, 18"	11.70
3	CF7023	SHORT SHOE FRAME	13.0
4	CM4001	SPRING, 27" OAL	3.50
5	CF2101	SHOE HANGER, FRONT - ASSEMBLY	2.40
6	CF2101A	FRAME, SHOE HANGER	1.50
7	CF2101B	PIN, SHOE HANGER	0.75
8	CF2101C	SPACER, SHOE HANGER	0.15
9	CF2102	CHAIN, SHOE	0.25
10	L17H	CLIP, SHOE SPRING	0.25
11	X3A25-125	COTTER PIN, 1/4 X 1-1/4'	
N.S.	CF2124	SHOE LOCKUP ASSEMBLY	1.50
N.S.	CF2143	LINK, SHOE TAIL	

KCF4, KCF6, KCF8, KCG4, KCG6 AND KCG8 CM4062 SHOE ASSEMBLY

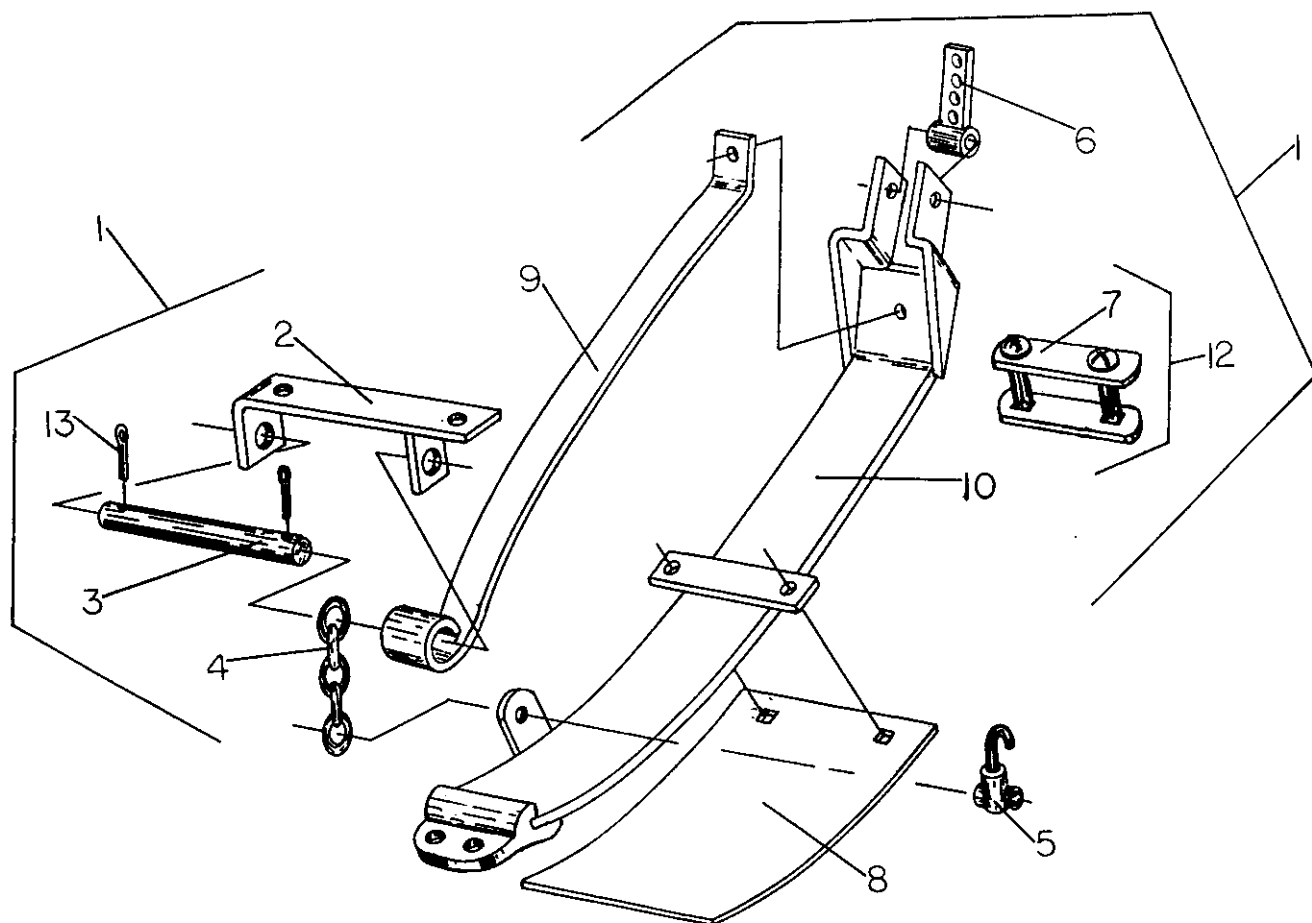

<u>KEY</u>	<u>PART NUMBER</u>	<u>DESCRIPTION</u>	<u>WT LBS.</u>
1	CF2101	ASSEMBLY, FRONT SHOE HANGER	2.4
2	CF2101A	SHOE HANGER FRAME	1.5
3	CF2101B	SHOE HANGER PIN	0.75
4	CF2102	SHOE CHAIN	0.25
5	CF2124	SHOE LOCK UP ASSEMBLY (OPTIONAL)	1.05
6	CF2621	SHOE TAIL, JOHN DEERE	0.50
7	CM4006	CLIP, SHOE SPRING	0.25
8	CF7005	SHOE SKID, 18" (OPTIONAL)	11.7
9	CM4048	SHOE SPRING, JD	3.5
10	CM4049	SHOE FRAME WELDMENT	14.0
11	CM4062	SHOE ASSEMBLY, WITH LOCK UP W/O SKID	20.5
12	CM4064	SHOE SPRING CLAMP ASSEMBLY	0.75
13	X3A25-125	COTTER PIN, 1/4 X 1-1/4	

KCF4, KCF6, KCF8, KCG4, KCG6 AND KCG8 CM4063 SHOE ASSEMBLY

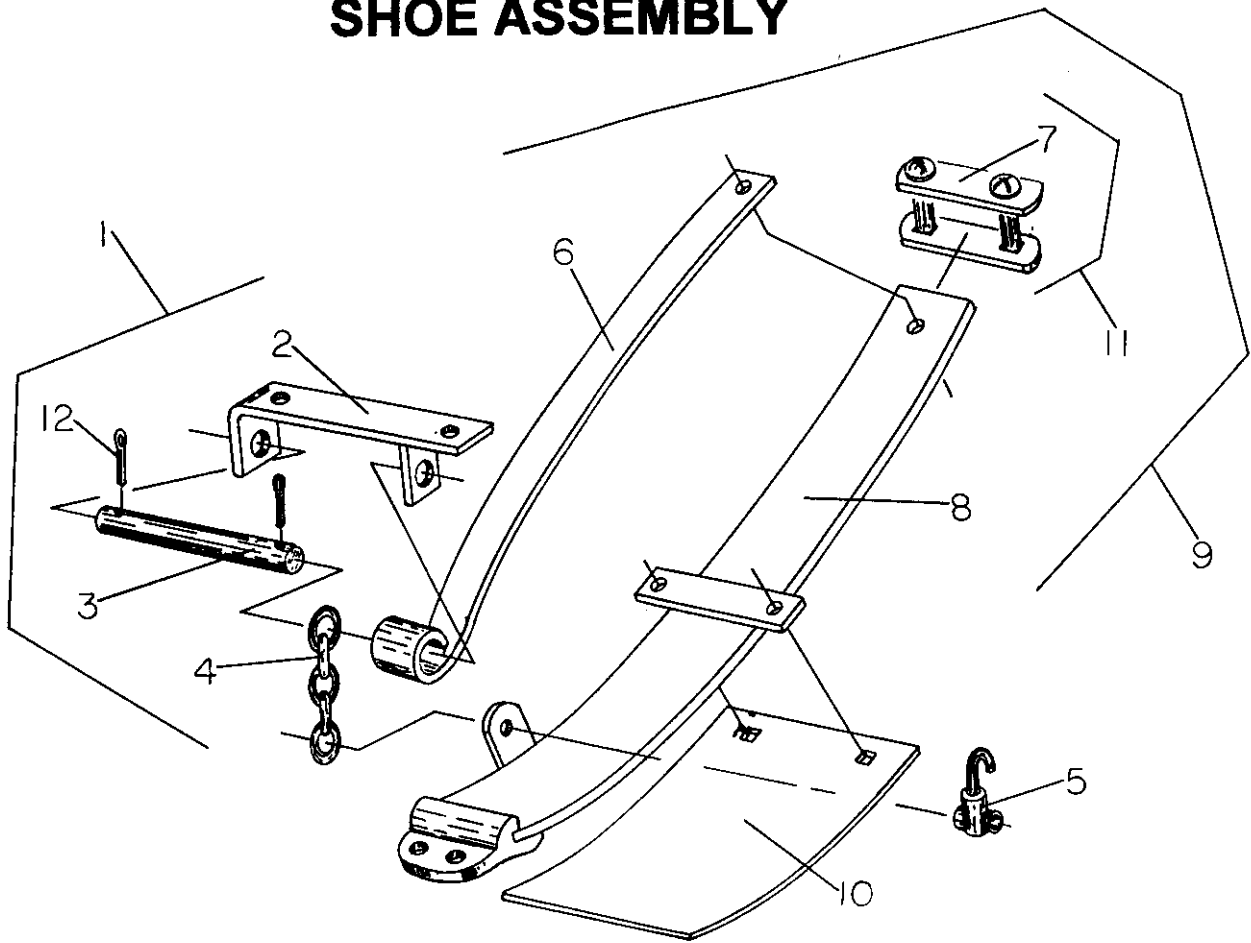

<u>KEY</u>	<u>PART NUMBER</u>	<u>DESCRIPTION</u>	<u>WT LBS.</u>
1	CF2101	ASSEMBLY, FRONT SHOE	2.4
2	CF2101A	SHOE HANGER FRAME	1.5
3	CF2101B	SHOE HANGER PIN	0.75
4	CF2102	SHOE CHAIN	0.25
5	CF2124	SHOE LOCK UP ASSEMBLY (OPTIONAL)	1.50
6	CM4001	SHOE SPRING, 27"	3.50
7	CM4006	CLIP, SHOE SPRING	0.25
8	CM4017	FLAT ARC SHOE FRAME, WELDMENT	13.0
9	CM4063	SHOE ASSEMBLY, WITH LOCK UP W/O SKID	20.0
10	CF7005	SHOE SKID, 18"	11.70
11	CM4064	SHOE SPRING CLAMP ASSEMBLY	0.75
12	X3A25-125	COTTER PIN, 1/4 X 1-1/4	