

J.E. LOVE COMPANY
LOVE®

309 CALIFORNIA STREET
GARFIELD, WASHINGTON 99130-0188
(509)635-1321 FAX: (509)635-1434

PICK UP REEL

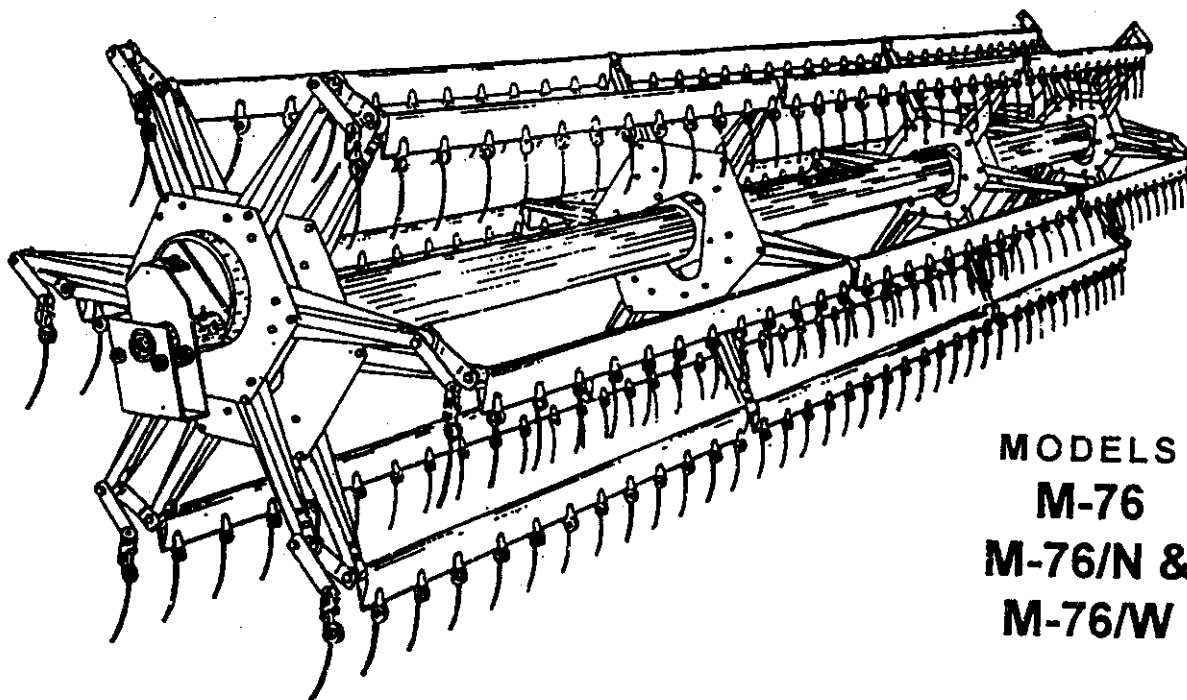

MODELS
M-76
M-76/N &
M-76/W

**OPERATING INSTRUCTIONS
SETTING UP DIRECTIONS
& PARTS ILLUSTRATIONS**

J.E. LOVE CO.

309 CALIFORNIA STREET
GARFIELD, WASHINGTON 99130-0188
(509)635-1321 FAX: (509)635-1434

APPROXIMATE SHIPPING WEIGHTS

LOVE REEL Models M-76, M-76/N & M-76/W

Header Length	5-Bat Weight	6-Bat Weight
10 ft.	335#	403#
11 ft.	363#	421#
12 ft.	380#	437#
13 ft.	395#	473#
14 ft.	421#	499#
15 ft.	440#	530#
16 ft.	460#	556#
17 ft.	480#	582#
18 ft.	500#	608#
19 ft.	520#	634#
20 ft.	540#	660#
22 ft.	525#	755#
24 ft.	670#	810#
25 ft.	695#	840#
27 ft.	755#	910#
30 ft.	840#	1010#

LOVE PICKUP REELS

GENERAL INFORMATION

SECTION A

FORWARD AND WARRANTY.....	A1-1
SAFETY INTRODUCTION.....	A1-2
OPERATING INSTRUCTIONS.....	A1-3, A1-4
SHIPMENT INSPECTION INFORMATION.....	A1-5
SETTING UP DIRECTIONS.....	A1-6, A1-7
ORDERING PROCEDURES & PACKAGING SYSTEM.....	A1-9, A1-10
PICKUP REEL SPECIFICATIONS.....	A1-11 - A1-16

COMMON PARTS

REEL PACKAGE

SECTION B

LOVE REEL PARTS REFERENCE CHARTS.....	B1-1
LOVE PICKUP REEL DIAGRAM.....	B1-2
REEL PACKAGE PARTS.....	B1-3 - B1-7
TINES & OUTBOARD FINGERS.....	B1-8, B1-9
JOURNALS, CRANK - LH & RH.....	B1-10, B1-11

SPIDER BUNDLES

SECTION C

SPIDER BUNDLE REFERENCE CHART.....	C1-1
SPIDER PARTS, 6" DIA. CENTER TUBE.....	C1-2 C1-3
SPIDER PARTS, 8" & 10" DIA. CENTER TUBES.....	C1-4, C1-5

SPECIFIC MODELS

SECTION D

DRIVE AND ATTACHING KITS

NOTICE: This section will be provided with LOVE Pickup Reels and upon request. Upon receipt, pages are to be inserted in Section D.

INDEX



SAFETY INTRODUCTION

THE SAFETY-ALERT SYMBOL MEANS ATTENTION! BECOME ALERT! YOUR SAFETY IS INVOLVED! THIS SYMBOL IDENTIFIES IMPORTANT SAFETY MESSAGES IN THIS MANUAL. WHEN YOU SEE THIS SYMBOL, BE ALERT TO THE POSSIBILITY OF PERSONAL INJURY AND CAREFULLY READ THE MESSAGE THAT FOLLOWS.



DANGER

**ROTATING SHAFTS CAN CAUSE DEATH OR SEVERE INJURY.
- KEEP CLEAR - DO NOT OPERATE WITHOUT SHIELDS IN PLACE.**



CAUTION

BLOCK SECURELY

DO NOT PLACE YOURSELF UNDER ANY EQUIPMENT SUSPENDED HYDRAULICALLY, WITH MECHANICAL STOPS, JACKS OR HOISTS, WITHOUT BLOCKING SECURELY. MAKE SURE MACHINE CANNOT ROLL.



CAUTION

BEFORE POWER STARTING - CHECK TO INSURE THAT ALL BOLTS ARE PROPERLY TIGHTENED AND REEL IS FREE TO ROTATE.



CAUTION

DO NOT SERVICE EQUIPMENT WHILE IT IS RUNNING. SHUT OFF POWER TO ADJUST, SERVICE OR CLEAN.

How to measure combine to determine reel number:

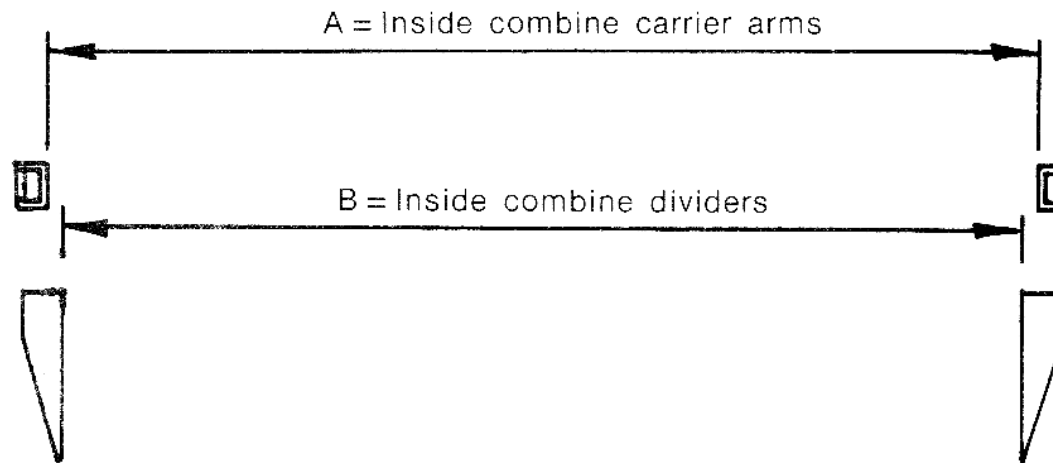

Reel Number (X) = A or B (whichever is smaller) Minus 5 5/8".

See Page 3 for Reel No. which is nearest "X". Use smaller Reel No. if larger Reel No. Minus "X" exceeds 1/2". If not use larger Reel No.

EXAMPLE: B = 188 3/4
X = 188 3/4 - 5 5/8 = 183 1/8
Reel Nos. nearest 182 & 185
185 - 183 1/8 = 1 7/8 use smaller

*End of combine is always determined by looking from operators platform in direction of travel.

"T" = Measurement from outside flange to outside flange of center tube. Then see Page 3 under Center Tube Length column for "T" and read across to Reel No. (X).

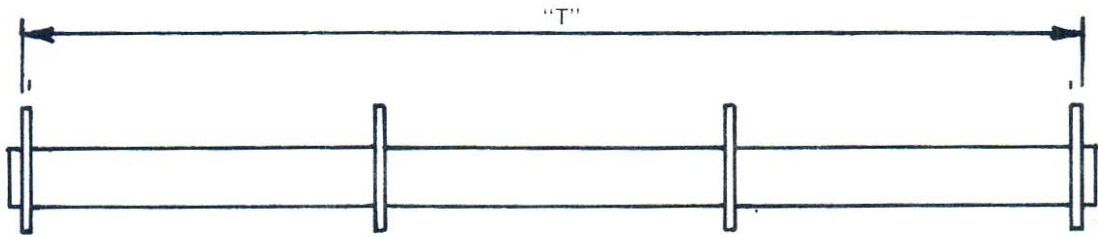

Batshaft:

"S" = Measurement from outside of crank arm to outside of crank arm. Then see Page 3 under Batshaft Length Column "S" and read across to Reel No. (X).

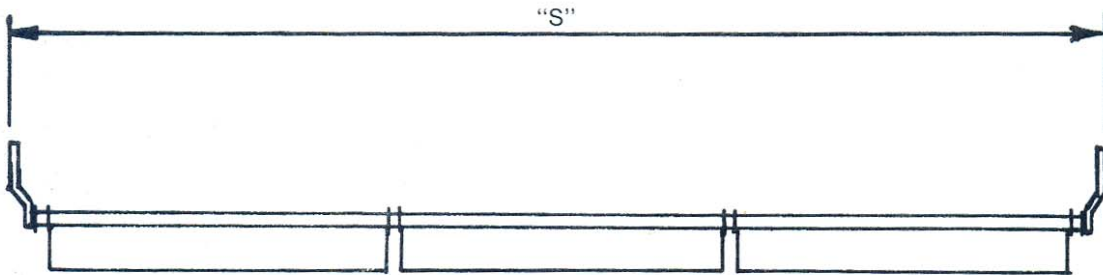

Bat Length:

LOOKING IN DIRECTION OF TRAVEL FROM OPERATOR'S PLATFORM

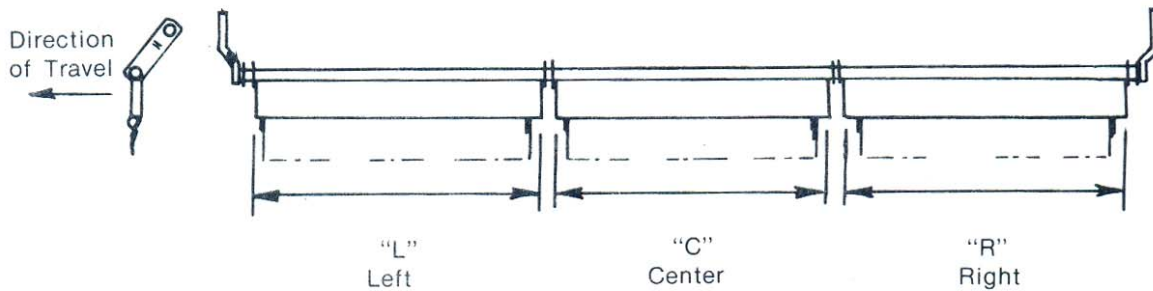

Measure all bats and compare with Bat Length Column on Page 3 when you read across to Reel No. (X).

All nylon tine bats are 3/8" short of chart lengths.

Nominal Header Length	Reel No. "X"	Bat Length "R"- "C"- "L"	Reel Center Tube Length "T"	Bat Shaft Length [Approx.] "S"
9'	96	46-1/2" - 40-1/2"	90-3/8"	93
9'	99	45" - 45"	93-3/8"	96
8' & 9'	102	46-1/2" - 46-1/2"	96-3/8"	99
10'	105	51" - 45"	99-3/8"	102
10'	108	52-1/2" - 46-1/2"	102-3/8"	105
10'	111	51" - 51"	105-3/8"	108
10'	114	52-1/2" - 52-1/2"	108-3/8"	111
10'	117	57" - 51"	111-3/8"	114
10'	123	57" - 57"	117-3/8"	120
11'	126	58-1/2" - 58-1/2"	120-3/8"	123
11'	129	63" - 57"	123-3/8"	126
12'	132	64-1/2" - 58-1/2"	126-3/8"	129
12'	135	63" - 63"	129-3/8"	132
12'	138	64-1/2" - 64-1/2"	132-3/8"	135
12'	141	69" - 63"	135-3/8"	138
13'	144	70-1/2" - 64-1/2"	138-3/8"	141
13'	147	69" - 69"	141-3/8"	144
13'	150	70-1/2" - 70-1/2"	144-3/8"	147
13'	153	75" - 69"	147-3/8"	150
14'	156	76-1/2" - 70-1/2"	150-3/8"	153
14'	159	75" - 75"	153-3/8"	156
14'	162	78" - 75"	156-3/8"	159
14'	165	81" - 75"	159-3/8"	162
15'	167	51" - 54" - 51"	160-7/8"	164
15'	168	81" - 78"	162-3/8"	165
15'	170	51" - 57" - 51"	163-7/8"	167
15'	171	81" - 81"	165-3/8"	168
15'	173	57" - 48" - 57"	166-7/8"	170
16'	176	57" - 51" - 57"	169-7/8"	173
16'	179	57" - 54" - 57"	172-7/8"	176
16'	182	57" - 57" - 57"	175-7/8"	179
16'	185	57" - 60" - 57"	178-7/8"	182
16'	188	57" - 63" - 57"	181-7/8"	185
17'	194	57" - 69" - 57"	187-7/8"	191
17'	197	63" - 60" - 63"	190-7/8"	194
18'	200	63" - 63" - 63"	193-7/8"	197
18'	203	63" - 66" - 63"	196-7/8"	200
18'	206	69" - 57" - 69"	199-7/8"	203
18'	209	69" - 60" - 69"	202-7/8"	206
18'	212	69" - 63" - 69"	205-7/8"	209
18'	215	69" - 66" - 69"	208-7/8"	212
19'	218	69" - 69" - 69"	211-7/8"	215
19'	221	69" - 72" - 69"	214-7/8"	218
19'	224	69" - 75" - 69"	217-7/8"	221
20'	227	69" - 78" - 69"	220-7/8"	224
20'	230	69" - 81" - 69"	223-7/8"	227
20'	233	81" - 60" - 81"	226-7/8"	230
20'	236	81" - 63" - 81"	229-7/8"	233
20-1/2'	242	81" - 69" - 81"	235-7/8"	239
21'	248	81" - 75" - 81"	241-7/8"	245
22'	249	63" - 54" - 54" - 63"	243-7/8"	246
21'	251	81" - 78" - 81"	244-7/8"	248
22'	252	63" - 57" - 57" - 63"	246-3/8"	249
22'	254	81" - 81" - 81"	247-7/8"	251
22'	255	63" - 58-1/2" - 58-1/2" - 63"	249-3/8"	252
22'	258	69" - 54" - 54" - 69"	252-3/8"	255
22-1/2'	261	66" - 58-1/2" - 58-1/2" - 66"	255-3/8"	258
23'	267	69" - 58-1/2" - 58-1/2" - 69"	261-3/8"	263
24'	273	69" - 60" - 63" - 69"	267-3/8"	270
24'	276	69" - 63" - 63" - 69"	270-3/8"	273
24'	288	69" - 69" - 69" - 69"	282-3/8"	285
24-1/2'	294	69" - 69" - 75" - 69"	288-3/8"	291

J. E. LOVE COMPANY

**Common
Drive and Attaching Kit Nos.**

Note 1: Attaching parts on the eccentric and drive ends of the Love Pickup Reels are included in Drive & Attaching Kits. Check the Pickup Reel and D.A. kit to insure that the proper parts are with the Pickup Reel and D.A. kit when shipped.

**8 ft. thru 21 ft. Combine and Swather Reels
with 6" Center Tube use DA8000 Kits**

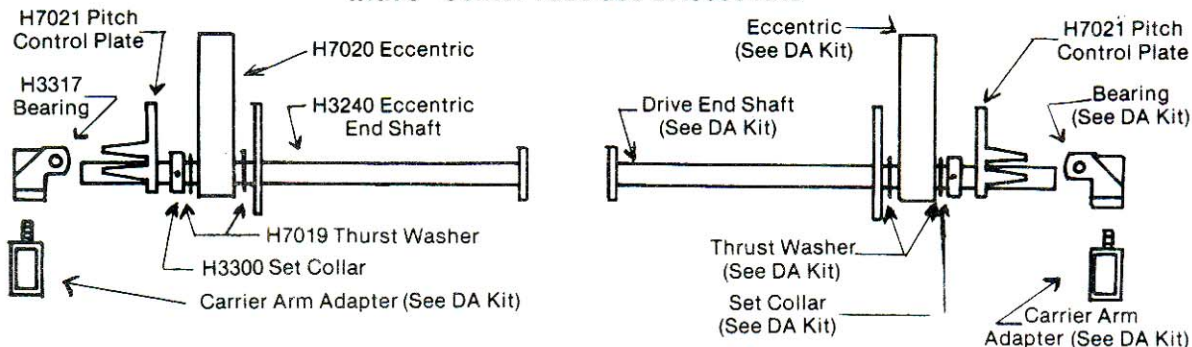

**22 ft. thru 24 ft. Combine Reels with 8"
Center Tube use DA 9000 Kits**

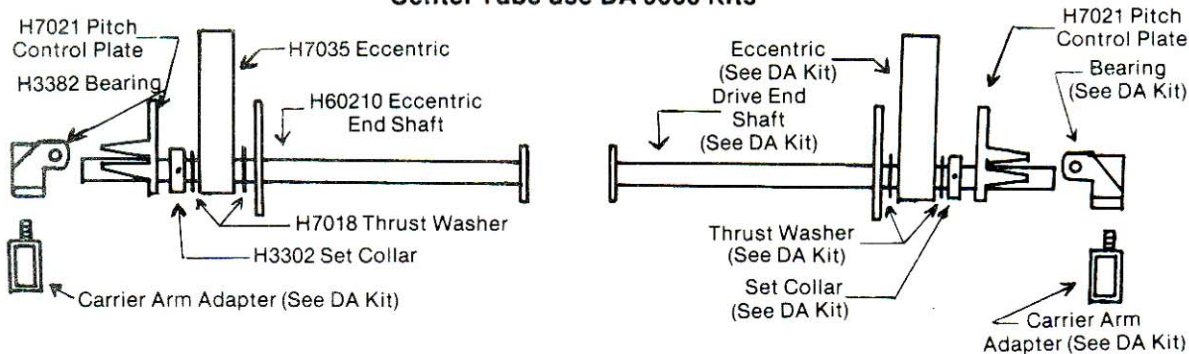

**MM76 Double End Drive Reels (California Rice)
with 6" Center Tube use DA8500 Kits**

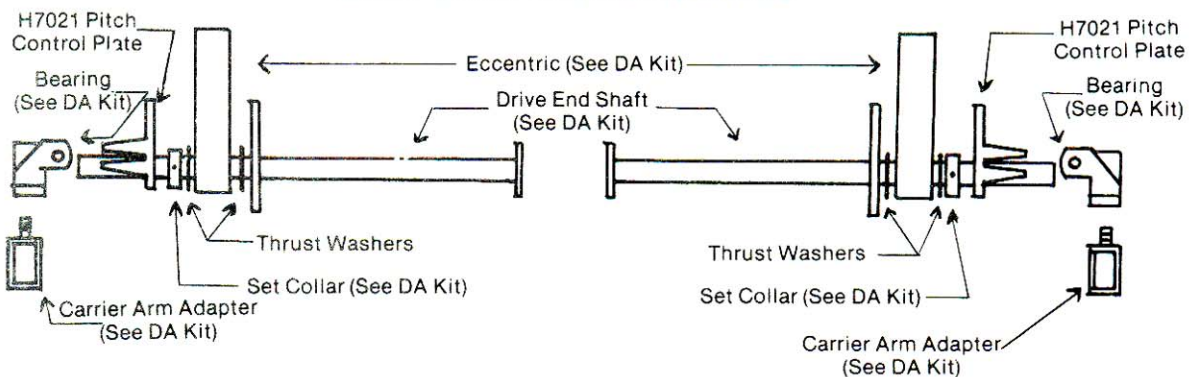

LOVEREEL PICK-UP REEL OPERATION & ADJUSTMENT

PLACEMENT OF REEL ON COMBINE OR SWATHER:

1. Reel center should be forward of cutterbar 5" to 9".
2. Do not set Reel too far ahead of cutterbar as it will strip the crop.
3. Set Reel center forward the same on both ends.
4. Be sure the header is completely down against the cutterbar when adjusting tine clearance.
5. Tines should pick up the crop, sweep the cutterbar and deposit the crop under the auger. Tine clearance of the auger will vary with conditions.
6. Reel center height should be the same on both ends.
7. Reel should be straight so tines will clear sickle as it revolves.

SPEED OF THE REEL:

1. Reel speed should be slightly faster than ground speed.
2. Proper Reel speeds may be obtained by purchasing a larger sheave or sprocket to slow the Reel down or a smaller sheave or sprocket to increase speed. Some machines are equipped with variable reel speed drives.



SHUT OFF POWER TO ADJUST, SERVICE OR CLEAN

LUBRICATION:

1. Use good grade pressure gun grease on all zerk fittings **DAILY**.

FIELD OPERATION & TROUBLE FINDING CHART

Most troubles are caused by improper installation or adjustment. The following suggested remedies are shown to familiarize you with the adjustments that may be made for the most common difficulties encountered in the field.

A sincere effort should be made to understand your Combine and Love Pick-up Reel. Carefully observe the effect of all adjustments. Soon you will have a thorough understanding of both pieces of equipment and no trouble in deciding what to adjust or what adjustment will solve the problem.

TROUBLE	SUGGESTED REMEDY
Reel not picking up the crop.	Reel Tine pitch is not steep enough to lift the crop. Increase the pitch of the tines. Increase the speed of the Reel in relation to the ground speed.
Stripping and Shattering the crop.	Reel is too high. Lower the Reel slightly. Decrease the Reel speed in relation to the ground speed. Either change Reel drive sprockets or increase ground speed.
Excessive breakage of Reel Tines and bats.	Reel too far forward of cutterbar. Move in toward the machine. Reel Tines may be striking or digging into the ground. Raise the Reel.
Crop wrapping or carrying around the Reel.	Reel too far forward of the cutterbar. Move toward the machine. Reel speed in ratio to ground speed is too great. Decrease Reel speed or increase ground speed. Reel Tine pitch is too steep. Decrease the Tine pitch by adjusting the Tine pitch control plate. The Reel should deposit the cut crop forward and below the auger. In standing crop the Reel is too far down thus bending stalks over tops of batshafts. Raise the Reel slightly.

Positioning Love Reel on Combine with Love Bar

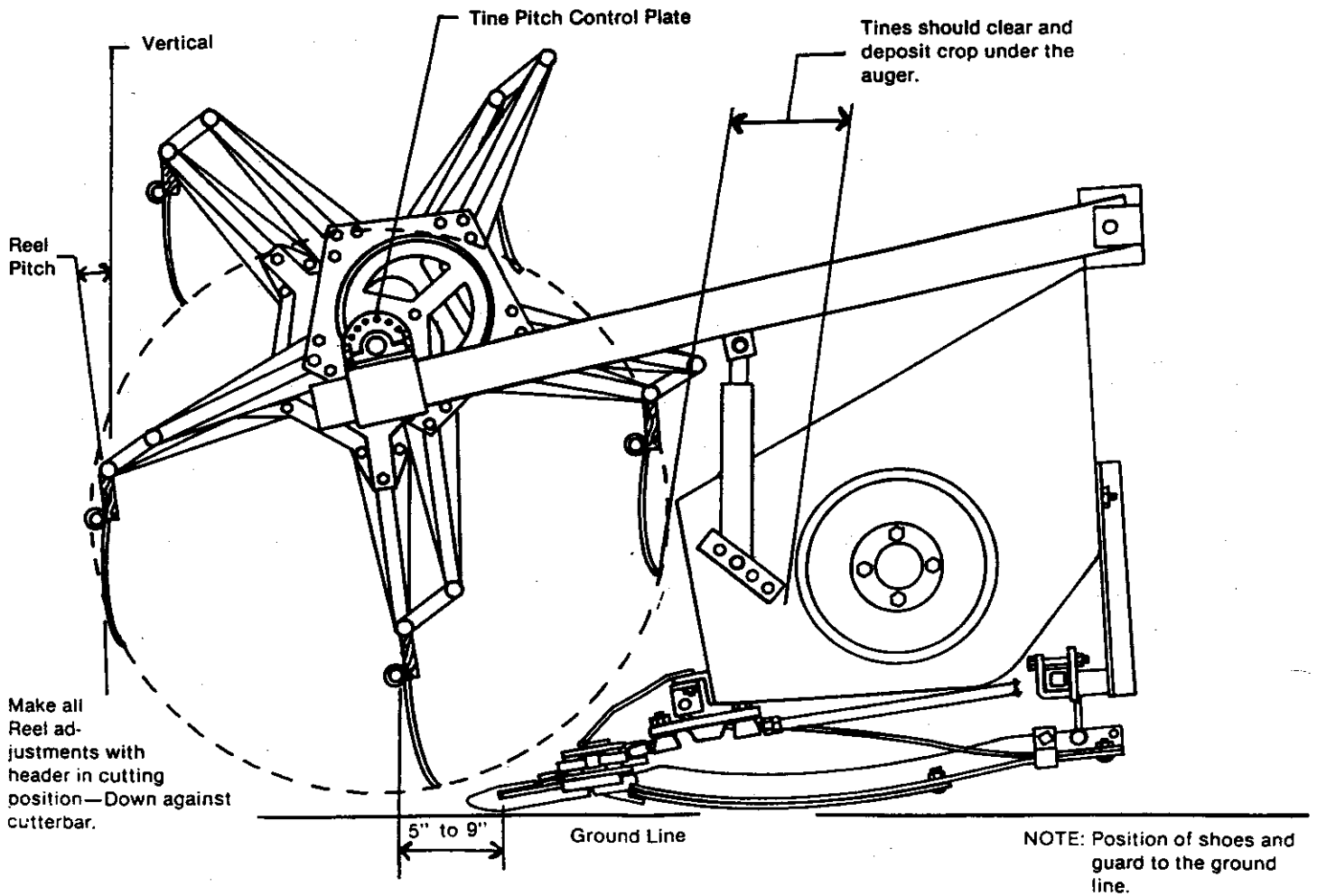

POSITIONING LOVE REEL ON HEADER WITHOUT LOVE BAR

Same positioning rules apply, only use guard placement on rigid bar as guide point. Watch to insure tines clear the auger.

J.E. LOVE CO.

309 CALIFORNIA STREET
GARFIELD, WASHINGTON 99130-0188
(509)635-1321 FAX: (509)635-1434

INSPECT REEL SHIPPING PACKAGE FOR THE FOLLOWING:

- **MANUAL** - OPERATING INSTRUCTIONS, SETTING UP DIRECTIONS & PARTS ILLUSTRATIONS.

- 1. **REEL PACKAGE** - REEL CENTER TUBE, BATSHAFT ASSEMBLIES AND OUTBOARD FINGERS. (REEL NUMBER SHOULD CORRESPOND TO REEL SPECIFICATION LIST FOR MAKE, MODEL & HEADER LENGTH, ALSO CHECK NUMBER OF BATS - 5 BAT/6BAT.)

- 2. **SPIDER BUNDLE** - 5 BAT/6 BAT CORRECT NUMBER TO CORRESPOND WITH REEL PACKAGE, BOLT SACK IS ATTACHED TO THIS BUNDLE.

- 3. **DRIVE & ATTACHING KIT** - DA--- KIT NUMBER AS LISTED ON REEL SPECIFICATION LIST FOR MAKE, MODEL AND HEADER LENGTH. (KIT MAYBE PARTIALLY INSTALLED ON REELS SHIPPED DIRECT FROM FACTORY.)

- **IF ANY SHORTAGE NOTED. PLEASE NOTIFY J.E. LOVE CO. IMMEDIATELY.**

SETTING UP DIRECTIONS

LOVE PICK UP REEL

J.E. LOVE COMPANY
309 CALIFORNIA ST.
GARFIELD, WA 99130-0188

MODELS
M-76
M-76/N
M-76/W

IMPORTANT!!!

ASSEMBLE COMPLETELY BEFORE TIGHTENING BOLTS THAT SECURE SPIDER ASSEMBLIES TO CENTER TUBE FLANGES. ROTATE REEL ALLOWING IT TO ALIGN - THEN TIGHTEN BOLTS LENGTHWISE ALONG CENTER TUBE - ROTATE AND REPEAT PROCEDURE. REEL SHOULD ROTATE FREELY WHEN FOLLOWING THIS PROCEDURE.

SET-UP PROCEDURE

(PLEASE NOTE: THE ALPHA-NUMERICAL LISTING OF THE FOLLOWING DIRECTIONS CORRESPONDS WITH THOSE SHOWN ON THE DIAGRAM.)

1. INSTALL SPIDER ASSEMBLIES ON CENTER TUBE

(TO AID INSTALLATION SET REEL CENTER ON STAND)



- A. PLACE SPIDER ASSEMBLIES ON CENTER TUBE WITH LARGE SPIDER PLATE FACING OUTBOARD (TOWARDS ENDS).
- B. STRADDLE SPIDER PLATES ON CENTER TUBE FLANGE, ROTATE TO ALIGN HOLES BE SURE ALL REEL ARMS OF THE SPIDER ASSEMBLIES ARE IN LINE.

2. INSTALL END SHAFTS INTO CENTER TUBE.

(DRIVE END SHAFT TO MATCH WITH HEADER DRIVE COMPONENTS.)



- A. PLACE FLAT SIDE OF CENTERING PLATE TO CLEAR INSIDE SEAM OF CENTER TUBE.
- B. HOLD END SHAFT AT AN ANGLE TO CENTER TUBE AS IT IS SLID INTO PLACE, ROTATE TO ALIGN HOLES, IF REEL END SHAFTS ARE INSTALLED FROM THE FACTORY THERE MAY BE A SHIPPING SPACER BETWEEN END SHAFTS AND REEL CENTER FLANGES. IF THERE IS REMOVE AND DISCARD.

3. INSTALL BATSHAFT ASSEMBLIES ON SPIDERS.

- A. SEPARATE MACHINE BUSHINGS TO ALLOW PLASTIC BEARINGS TO FIT BETWEEN.
- B. PLACE BATSHAFT ASSEMBLIES IN BEARING BASE WITH TINES FACING FORWARD, AS ILLUSTRATED BY DIAGRAM.
- C. INSTALL BEARING CAP AND U-CLIP.
- D. SECURE WITH 5/16 X 1-3/4 BOLT AND SELF LOCKING NUT.

4. INSTALL ECCENTRIC SPIDERS & OUTBOARD FINGERS.

- A. SLIDE ECCENTRIC ON TO END STEMS.
- B. PLACE ECCENTRIC SPIDER OVER END SHAFT AND ON TO ECCENTRIC.
- C. INSTALL OUTBOARD FINGER THRU ECCENTRIC SPIDER ARMS AND SECURE TO CRANK ARM OF BATSHAFT ASSEMBLY. THE MACHINE BUSHING IS LOCATED ON OUTSIDE OF PLASTIC BEARING AND POSITION CLIP ON INSIDE.

5. **INSTALL END BEARINGS & ADAPTERS.**
 - A. REFER TO DA— KIT FOR SPECIFIC MAKE, MODEL AND HEADER LENGTH FOR COMPONENTS AND CORRECT ASSEMBLY.

6. **INSTALL ON HEADER.**
 (INSERT STOP PIN OR BOLT SO REEL CANNOT SLIDE OFF ARMS.)
 - A. CENTER REEL BETWEEN CARRIER ARMS OR DIVIDERS.
 - B. ROTATE REEL BY HAND AND TIGHTEN ALL BOLTS. TIGHTEN POSITION BOLTS ON TINE PITCH CONTROL, WHEN SET TO DESIRED POSITION.
 - C. INSTALL DRIVE PULLEY OR SPROCKET.
 - D. ROTATE REEL TO INSURE CLEARANCE, PLACE IN RUNNING POSITION AND SECURE.



INSTALL ALL SAFETY SHIELDS AND ALWAYS OPERATE SAFELY.



GREASE ZERKS DAILY

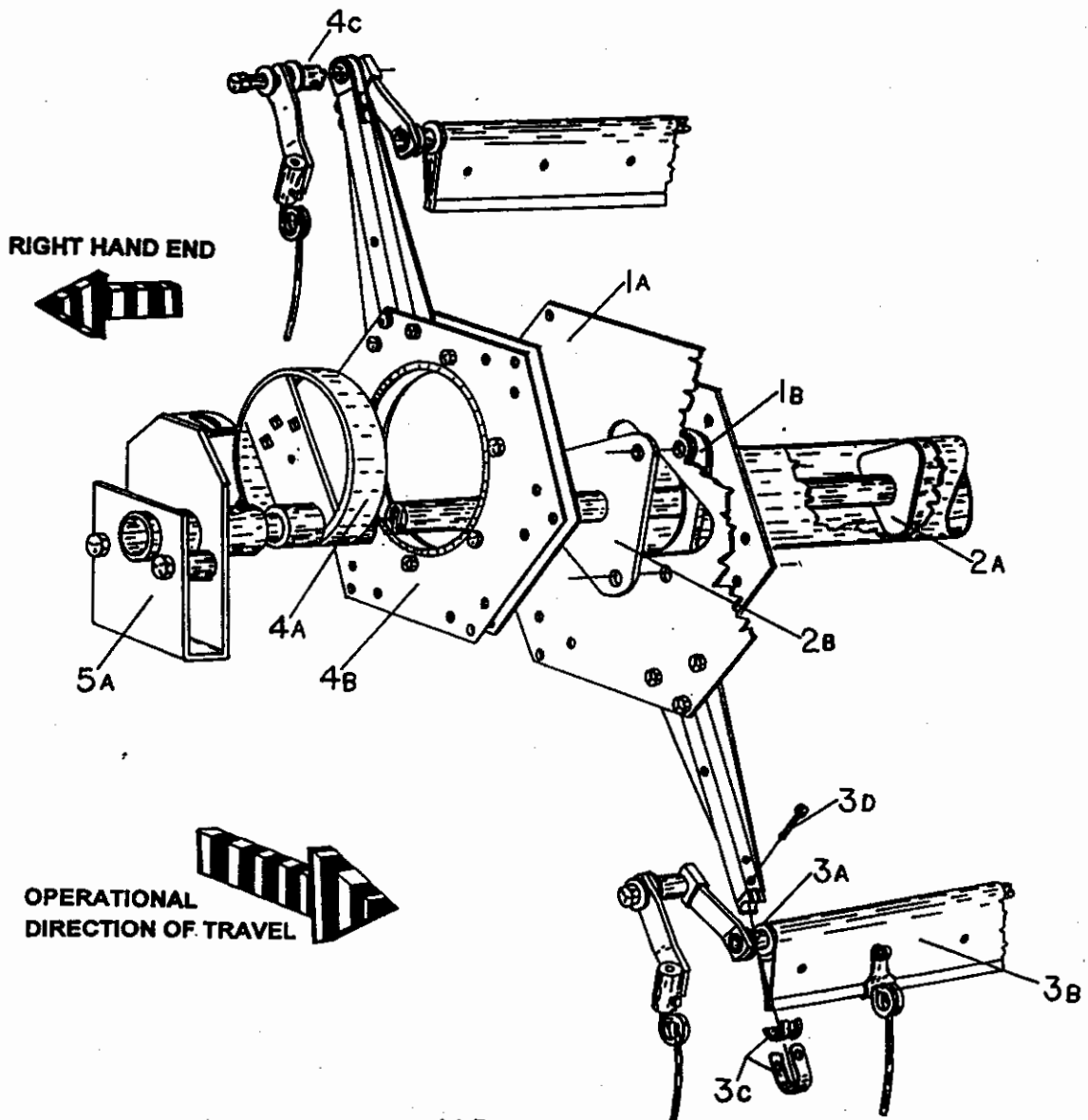

LOVEREEL ORDERING PROCEDURE & PACKAGING SYSTEM

J.E. LOVE Company offers Pick-up Reels for most makes & models of combines and swathers. LOVEREELS are available with the following features: 5 or 6 batshafts, 37", 41" (std) 45" and 53" diameter. Tine options - NOTE: Tines determine model number - please refer to the following chart.

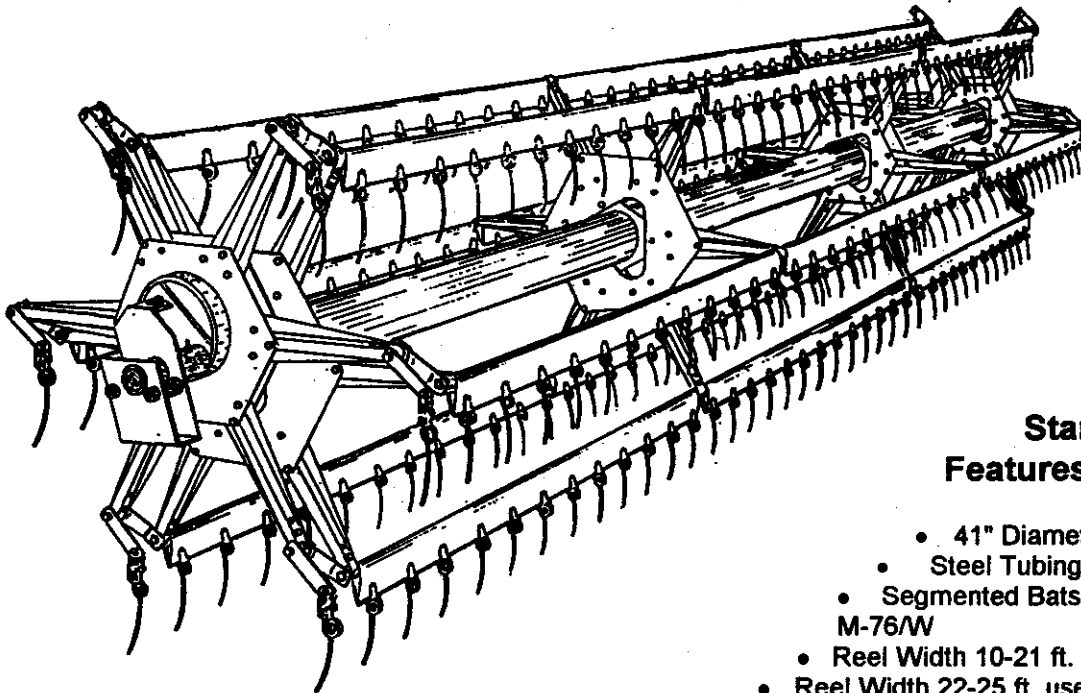

**MODELS
M-76
M-76/N &
M-76/W**

Standard Features Included:

- 41" Diameter
- Steel Tubing Batshafts on M-76
- Segmented Batshaft Assemblies on M-76/N & M-76/W
- Reel Width 10-21 ft. use 6" Centertube
- Reel Width 22-25 ft. use 8" Centertube
- Reel Width 27-30 ft. use 10" Centertube
- Double Plate, Steel Spider Hub Assemblies
- Precise, Smooth Eccentric Mechanism
- Positive Tine Pitch Control

REEL MODELS / BAT TYPES / TINE CHOICES

Model	Type of Bat	Tine Choice	Tine Description	Tine Spacing
M-76	Selected	'A'	Coiled, Steel, 6" Straight	4"
	Hardwood.....	'F'	Spike, Steel, 4" Straight	3"
		'M'	Coiled, Steel, 8" Curved	4"
M-76/N	Inverted			
	Tear-Shaped	'N'	Molded, Polymer, 8" Curved	4"
M-76/W	Steel			
	Inverted	'W4'	Coiled, Steel, 4" Curved	4"
	Tear-Shaped	'W6'	Coiled, Steel, 6" Curved	4"
	Steel	'W8'	Coiled, Steel, 8" Curved	4"

ORDERING PROCEDURE:

Specify combine or swather make, model, year, header model and width. Then select the LOVEREEL model by its corresponding choice of tine.

Indicate 5 or 6 batshafts and diameter (41" dia. standard).

PACKAGING SYSTEM.

The LOVEREEL Three (3) Packaging System is comprised of the following:

1. Reel Package
2. Spider Bundle
3. Drive & Attaching Kit

1. **REEL PACKAGE** - Combine or swather make, model, header model & width determines the reel length. The number of batshafts and the choice of tines completes the identification for the reel package.

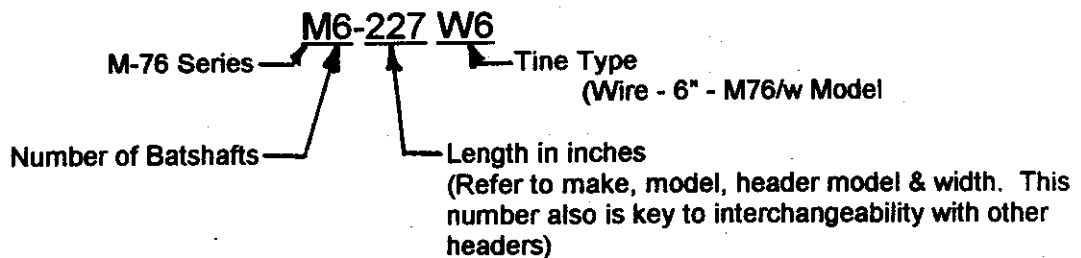

2. **SPIDER BUNDLES** - Determining factors for the spider bundle are: reel length, number of batshafts and reel diameter. (41" dia. std.)

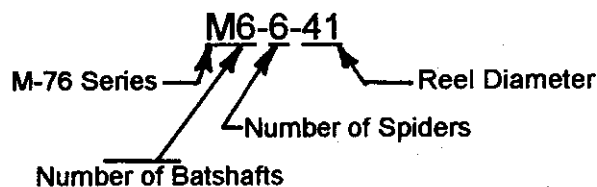

The length of the reel determines the diameter of the reel center tube 6", 8" or 10" diameter. 8" and 10" diameter use the same spider. The length also is key to the number of bats per batshaft. (Refer to bat length column on center tube reel parts pages).

NOTE: The Reel Package and Spider Bundle comprise the common parts of the LOVEREEL.

3. **DRIVE & ATTACHING KIT** - is comprised of the parts to mount and drive the LOVEREEL on a specific combine or swather. When the LOVEREEL is shipped direct from the factory these parts may be attached to the reel. To identify the drive & attaching kit required please refer to the Pick-up Reel Specification pages. Drive & Attaching Kit Parts Information will be found in the D & A Kit supplement for common parts manual.

NOTE: "Right-hand" (RH) and "Left-hand" (LH) drive is determined by facing in the direction the combine or swather will travel when in use.

LOVE REEL

J.E. LOVE CO.

309 CALIFORNIA STREET
GARFIELD, WASHINGTON 99130-0188
(509)635-1321 FAX: (509)635-1434

PICKUP REEL SPECIFICATIONS

(NOTE: RH=RIGHT HAND, LH=LEFT HAND)

HEADER LENGTH, FEET	NUMBER BATS	REEL PACKAGE	SPIDER BUNDLE	DRIVE & ATTACHING KIT	DRIVE END RH OR LH
<u>AGCO (GLENER/DEUTZ ALLIS)</u>					
MODELS: L2, L3, M, M2, M3, MH, MH2, MH3, NS, N6, N7. <u>W/SERIES 2 HEADERS</u>					
13	5	M5-147(-)	M5-5-41	DA8074	RH
	6	M6-147(-)	M6-5-41	DA8074	RH
15	5	M5-170(-)	M5-6-41	DA8074	RH
	6	M6-170(-)	M6-6-41	DA8074	RH
16	5	M5-182(-)	M5-6-41	DA8074	RH
	6	M6-182(-)	M6-6-41	DA8074	RH
18	5	M5-206(-)	M5-6-41	DA8074	RH
	6	M6-206(-)	M6-6-41	DA8074	RH
20	5	M5-230(-)	M5-6-41	DA8074	RH
	6	M6-230(-)	M6-6-41	DA8074	RH
22	5	M5-255(-)	M5-7-41	DA9001	RH
	6	M6-255(-)	M6-7-41	DA9001	RH
24	5	M5-279(-)	M5-7-41	DA9001	RH
	6	M6-279(-)	M6-7-41	DA9001	RH
MODELS: L3, M3, MH3, N5, N6, N7, R40, R450, R460 & R70 <u>W/SERIES 3 HEADERS</u>					
15	5	M5-170(-)	M5-6-41	DA8523	RH
	6	M6-170(-)	M6-6-41	DA8523	RH
16	5	M5-182(-)	M5-6-41	DA8523	RH
	6	M6-182(-)	M6-6-41	DA8523	RH
18	5	M5-206(-)	M5-6-41	DA8523	RH
	6	M6-206(-)	M6-6-41	DA8523	RH
20	5	M5-230(-)	M5-6-41	DA8523	RH
	6	M6-230(-)	M6-6-41	DA8523	RH
22	5	M5-255(-)	M5-7-41	DA9512	RH
	6	M6-255(-)	M6-7-41	DA9512	RH
24	5	M5-279(-)	M5-7-41	DA9512	RH
	6	M6-279(-)	M6-7-41	DA9512	RH
27	5	M5-315(-)	M5-7-41	DA9754	RH
	6	M6-315(-)	M6-7-41	DA9754	RH
30	5	M5-351(-)	M5-7-41	DA9754	RH
	6	M6-351(-)	M6-7-41	DA9754	RH

AGCO(CONTINUED)
400 SERIES HEADER

(NOTE: RH=RIGHT HAND, LH=LEFT HAND)

HEADER LENGTH, FEET	NUMBER BATS	REEL PACKAGE	SPIDER BUNDLE	DRIVE & ATTACHING KIT	DRIVE END RH OR LH
15	5	M5-170(--)	M5-6-41	DA8537	RH
	6	M6-170(--)	M6-6-41	DA8537	RH
16	5	M5-182(--)	M5-6-41	DA8537	RH
	6	M6-182(--)	M6-6-41	DA8537	RH
18	5	M5-206(--)	M5-6-41	DA8537	RH
	6	M6-206(--)	M6-6-41	DA8537	RH
20	5	M5-230(--)	M5-6-41	DA8537	RH
	6	M6-230(--)	M6-6-41	DA8537	RH
22	5	M5-255(--)	M5-7-41	DA9527	RH
	6	M6-255(--)	M6-7-41	DA9527	RH
25	5	M5-291(--)	M5-7-41	DA9527	RH
	6	M6-291(--)	M6-7-41	DA9527	RH
27	5	M5-315(--)	M5-7-41	DA9766	RH
	6	M6-315(--)	M6-7-41	DA9766	RH
30	5	M5-351(--)	M5-7-41	DA9766	RH
	6	M6-351(--)	M6-7-41	DA9766	RH

CASE/IH

MODELS 1420, 1440, 1460, 1470 & 1480 W/810 & 820 HEADERS (1979 & LATER)

13	5	M5-144(--)	M5-5-41	DA8524	RH
	6	M6-144(--)	M6-5-41	DA8524	RH
15	5	M5-170(--)	M5-6-41	DA8524	RH
	6	M6-170(--)	M6-6-41	DA8524	RH
16½	5	M5-188(--)	M5-6-41	DA8524	RH
	6	M6-188(--)	M6-6-41	DA8524	RH
17½	5	M5-200(--)	M5-6-41	DA8524	RH
	6	M6-200(--)	M6-6-41	DA8524	RH
20	5	M5-230(--)	M5-6-41	DA8524	RH
	6	M6-230(--)	M6-6-41	DA8524	RH
22½	5	M5-258(--)	M5-7-41	DA9511	RH
	6	M6-258(--)	M6-7-41	DA9511	RH
24	5	M5-276(--)	M5-7-41	DA9511	RH
	6	M6-276(--)	M6-7-41	DA9511	RH
30	5	M5-348(--)	M5-7-41	DA9755	RH
	6	M6-348(--)	M6-7-41	DA9755	RH

CASE/IH (CONTINUED)**CASE/IH 1010 & 1020 HEADERS, PRIOR TO P.I.N. JJC0200001**

(NOTE: RH=RIGHT HAND, LH=LEFT HAND)

HEADER LENGTH, FEET	NUMBER BATS	REEL PACKAGE	SPIDER BUNDLE	DRIVE & ATTACHING KIT	DRIVE END RH OR LH
15	5	M5-171(--)	M5-6-41	DA8532	RH
	6	M6-171(--)	M6-6-41	DA8532	RH
17½	5	M5-201(--)	M5-6-41	DA8532	RH
	6	M6-201(--)	M6-6-41	DA8532	RH
20	5	M5-231(--)	M5-6-41	DA8532	RH
	6	M6-231(--)	M6-6-41	DA8532	RH
22½	5	M5-261(--)	M5-7-41	DA9519	RH
	6	M6-261(--)	M6-7-41	DA9519	RH
25	5	M5-291(--)	M5-7-41	DA9519	RH
	6	M6-291(--)	M6-7-41	DA9519	RH
30	5	M5-351(--)	M5-7-41	DA9761	RH
	6	M6-351(--)	M6-7-41	DA9761	RH

FOR REPAIR PARTS ON DRIVE AND ATTACHING KITS WITH LOVE REEL SERIAL NO. G06059 & PRIOR, THE FOLLOWING DA KIT NUMBERS SHOULD BE REQUESTED. 15' THRU 20': DA8527, 22-1/2 THRU 25': DA9514 AND 30': DA9758.

**CASE/IH 1010 & 1020 HEADERS, P.I.N. JJC0200001 & AFTER
LOVE REEL SERIAL NO. G06060 & LATER**

15	5	M5-171(--)	M5-6-41	DA8538	RH
	6	M6-171(--)	M6-6-41	DA8538	RH
17½	5	M5-201(--)	M5-6-41	DA8538	RH
	6	M6-201(--)	M6-6-41	DA8538	RH
20	5	M5-231(--)	M5-6-41	DA8538	RH
	6	M6-231(--)	M6-6-41	DA8538	RH
22½	5	M5-261(--)	M5-7-41	DA9528	RH
	6	M6-261(--)	M6-7-41	DA9528	RH
25	5	M5-291(--)	M5-7-41	DA9528	RH
	6	M6-291(--)	M6-7-41	DA9528	RH
30	5	M5-351(--)	M5-7-41	DA9767	RH
	6	M6-351(--)	M6-7-41	DA9767	RH

JOHN DEERE

(NOTE: RH=RIGHT HAND, LH=LEFT HAND)

HEADER LENGTH, FEET	NUMBER BATS	REEL PACKAGE	SPIDER BUNDLE	DRIVE & ATTACHING KIT	DRIVE END RH OR LH
---------------------	-------------	--------------	---------------	-----------------------	--------------------

200 SERIES HEADERS (EQUIPPED W/JD FLAT BAT REEL DRIVE COMPONENTS)

REQUIRE JOHN DEERE BUNDLES BH76873 & BH76690 TO COMPLETE MOUNTING.

13	5	M5-144(--)	M5-5-41	DA8519	RH
	6	M6-144(--)	M6-5-41	DA8519	RH
15	5	M5-167(--)	M5-6-41	DA8519	RH
	6	M6-167(--)	M6-6-41	DA8519	RH
16	5	M5-179(--)	M5-6-41	DA8519	RH
	6	M6-179(--)	M6-6-41	DA8519	RH
18	5	M5-203(--)	M5-6-41	DA8519	RH
	6	M6-203(--)	M6-6-41	DA8519	RH
20	5	M5-227(--)	M5-6-41	DA8519	RH
	6	M6-227(--)	M6-6-41	DA8519	RH
22	5	M5-252(--)	M5-7-41	DA9501	RH
	6	M6-252(--)	M6-7-41	DA9501	RH
24	5	M5-276(--)	M5-7-41	DA9501	RH
	6	M6-276(--)	M6-7-41	DA9501	RH
30	5	M5-348(--)	M5-7-41	DA9751	RH
	6	M6-348(--)	M6-7-41	DA9751	RH

200 SERIES HEADERS (EQUIPPED W/JOHN DEERE PICK-UP REEL DRIVE COMPONENTS)

REQUIRES JOHN DEERE BUNDLES BH76691, BH77559 & BH76689 TO COMPLETE MOUNTING.

15	5	M5-167(--)	M5-6-41	DA8518	RH
	6	M6-167(--)	M6-6-41	DA8518	RH
16	5	M5-179(--)	M5-6-41	DA8518	RH
	6	M6-179(--)	M6-6-41	DA8518	RH
18	5	M5-203(--)	M5-6-41	DA8518	RH
	6	M6-203(--)	M6-6-41	DA8518	RH
20	5	M5-227(--)	M5-6-41	DA8518	RH
	6	M6-227(--)	M6-6-41	DA8518	RH
22	5	M5-249(--)	M5-7-41	DA9503	RH
	6	M6-249(--)	M6-7-41	DA9503	RH
24	5	M5-273(--)	M5-7-41	DA9503	RH
	6	M6-273(--)	M6-7-41	DA9503	RH

JOHN DEERE (CONTINUED)

(NOTE: RH=RIGHT HAND, LH=LEFT HAND)

HEADER LENGTH, FEET	NUMBER BATS	REEL PACKAGE	SPIDER BUNDLE	DRIVE & ATTACHING KIT	DRIVE END RH OR LH
13	5	M5-144(--)	M5-5-41	DA8531	RH
	6	M6-144(--)	M6-5-41	DA8531	RH
15	5	M5-167(--)	M5-6-41	DA8531	RH
	6	M6-167(--)	M6-6-41	DA8531	RH
18	5	M5-203(--)	M5-6-41	DA8531	RH
	6	M6-203(--)	M6-6-41	DA8531	RH
20	5	M5-227(--)	M5-6-41	DA8531	RH
	6	M6-227(--)	M6-6-41	DA8531	RH
22	5	M5-252(--)	M5-7-41	DA9521	RH
	6	M6-252(--)	M6-7-41	DA9521	RH
24	5	M5-276(--)	M5-7-41	DA9521	RH
	6	M6-276(--)	M6-7-41	DA9521	RH
25	5	M5-294(--)	M5-7-41	DA9520	RH
	6	M6-294(--)	M6-7-41	DA9520	RH
30	5	M5-348(--)	M5-7-41	DA9762	RH
	6	M6-348(--)	M6-7-41	DA9762	RH

FOR REPAIR PARTS ON DRIVE & ATTACHING KITS WITH LOVE REEL SERIAL NO. G06059 & PRIOR, THE FOLLOWING DA KIT NUMBERS SHOULD BE REQUESTED. 13'-20': DA8529, 22'-25': DA9516 AND 30': DA9759.

900 SERIES HEADERS (EQUIPPED W/JOHN DEERE FLAT BAT DRIVE COMPONENTS)

13	5	M5-144(--)	M5-5-41	DA8533	RH
	6	M6-144(--)	M6-5-41	DA8533	RH
15	5	M5-167(--)	M5-6-41	DA8533	RH
	6	M6-167(--)	M6-6-41	DA8533	RH
18	5	M5-203(--)	M5-6-41	DA8533	RH
	6	M6-203(--)	M6-6-41	DA8533	RH
20	5	M5-227(--)	M5-6-41	DA8533	RH
	6	M6-227(--)	M6-6-41	DA8533	RH
22	5	M5-252(--)	M5-7-41	DA9522	RH
	6	M6-252(--)	M6-7-41	DA9522	RH
24	5	M5-276(--)	M5-7-41	DA9522	RH
	6	M6-276(--)	M6-7-41	DA9522	RH
25	5	M5-294(--)	M5-7-41	DA9523	RH
	6	M6-294(--)	M6-7-41	DA9523	RH
30	5	M5-348(--)	M5-7-41	DA9763	RH
	6	M6-348(--)	M6-7-41	DA9763	RH

JOHN DEERE (CONTINUED)

(NOTE: RH=RIGHT HAND, LH=LEFT HAND)

HEADER LENGTH, FEET	NUMBER BATS	REEL PACKAGE	SPIDER BUNDLE	DRIVE & ATTACHING KIT	DRIVE END RH OR LH
13	5	M5-144(--)	M5-5-41	DA8534	RH
	6	M6-144(--)	M6-5-41	DA8534	RH
15	5	M5-167(--)	M5-6-41	DA8534	RH
	6	M6-167(--)	M6-6-41	DA8534	RH
18	5	M5-203(--)	M5-6-41	DA8534	RH
	6	M6-203(--)	M6-6-41	DA8534	RH
20	5	M5-227(--)	M5-6-41	DA8534	RH
	6	M6-227(--)	M6-6-41	DA8534	RH
22	5	M5-252(--)	M5-7-41	DA9524	RH
	6	M6-252(--)	M6-7-41	DA9524	RH
24	5	M5-276(--)	M5-7-41	DA9524	RH
	6	M6-276(--)	M6-7-41	DA9524	RH
25	5	M5-294(--)	M5-7-41	DA9525	RH
	6	M6-294(--)	M6-7-41	DA9525	RH
30	5	M5-348(--)	M5-7-41	DA9765	RH
	6	M6-348(--)	M6-7-41	DA9765	RH

SPECIAL ORDERS:

Pickup reels for combine or swather makes and models other than those listed can be furnished in most cases. Please check with the Engineering Department, J.E. Love Company, Garfield, Washington, U.S.A. 99130-0188, for a pickup reel for your favorite combine or swather.

**LOVE REEL PACKAGE PARTS REFERENCE
6" DIA CENTER TUBES, 2 BATS/BATSHAFT**

NOMINAL HEADER LENGTH	REEL NUMBER	BAT LENGTH LEFT - RIGHT	REEL CENTER TUBE	MODEL M76 "A", F, M TINE BATSHAFT NO.	MODEL M76/N & M76/W BATSHAFT ASSY. NO.
10'	105	45" - 41"	H7105	H24105	H8105
10'	108	46-1/2" - 52-1/2"	H7108	H24108	H8108
10'	111	51" - 51"	H7111	H24111	H8011
10'	114	52-1/2" - 52-1/2"	H7114	H24114	H8114
10'	117	51" - 57"	H7117	H24117	H8117
11'	126	58-1/2" - 58-1/2"	H7126	H24126	H8126
12'	132	59-1/2" - 64-1/2"	H7132	H24132	H8132
12'	135	63" - 63"	H7135	H24135	H8135
12'	138	64-1/2" - 64-1/2"	H7138	H24138	H8138
12'	141	63" - 69"	H7141	H24141	H8141
13'	144	64-1/2" - 70-1/2"	H7144	H24144	H8144
13'	147	69" - 69"	H7147	H24147	H8147
13'	150	70-1/2" - 70-1/2"	H7150	H24150	H8150
13'	153	69" - 75"	H7153	H24153	H8153
14'	156	70-1/2" - 76-1/2"	H7156	H24156	H8156
14'	159	75" - 75"	H7159	H24159	H8159
14'	162	75" - 78"	H7162	H24162	H8162
14'	165	75" - 81"	H7165	H24165	H8165

6" DIA CENTER TUBES, 3 BATS/BATSHAFT

NOMINAL HEADER LENGTH	REEL NUMBER	BAT LENGTH LEFT - CTR - RIGHT	REEL CENTER TUBE	MODEL M76 "A", F, M TINE BATSHAFT NO.	MODEL M76/N & M76/W BATSHAFT ASSY. NO.
15'	167	51" - 54" - 51"	H7167	H24167	H8167
15'	170	51" - 57" - 51"	H7170	H24170	H8170
15'	171	51" - 58" - 51"	H7171	H24171	H8171
15'	173	57" - 48" - 57"	H7173	H24173	H8173
16'	176	57" - 51" - 57"	H7176	H24176	H8176
16'	179	57" - 54" - 57"	H7179	H24179	H8179
16'	182	57" - 57" - 57"	H7182	H24182	H8182
16'	185	57" - 60" - 57"	H7185	H24185	H8185
16'	188	57" - 63" - 57"	H7188	H24188	H8188
16'	189	57" - 64" - 57"	H7189	H24189	H8189
17'	194	57" - 69" - 57"	H7194	H24194	H8194
17'	197	63" - 60" - 63"	H7197	H24197	H8197
18'	200	63" - 63" - 63"	H7200	H24200	H8200
18'	201	63" - 64" - 63"	H7201	H24201	H8201
18'	203	63" - 66" - 63"	H7203	H24203	H8203
18'	206	69" - 57" - 69"	H7206	H24206	H8206
18'	209	69" - 60" - 69"	H7209	H24209	H8209
18'	212	69" - 63" - 69"	H7212	H24212	H8212
18'	215	69" - 66" - 69"	H7215	H24215	H8215
19'	218	69" - 69" - 69"	H7218	H24218	H8218
19'	221	69" - 72" - 69"	H7221	H24221	H8221
19'	224	69" - 75" - 69"	H7224	H24224	H8224
20'	227	69" - 78" - 69"	H7227	H24227	H8227
20'	230	69" - 81" - 69"	H7230	H24230	H8230
20'	231	72" - 76" - 72"	H7231	H24231	H8231
20'	233	81" - 60" - 69"	H7233	H24233	H8233
20'	236	81" - 63" - 81"	H7236	H24236	H8236
20-1/2'	242	81" - 69" - 81"	H7242	H24242	H8242
21'	245	81" - 72" - 81"	H7245	H24245	H8245
21'	248	81" - 75" - 81"	H7248	H24248	H8248

8" DIA CENTER TUBES, 4 BATS/BATSHAFT

NOMINAL HEADER LENGTH	REEL NUMBER	BAT LENGTH LEFT - CTR - CTR - RIGHT	REEL CENTER TUBE	MODEL M76 "A", F, M TINE BATSHAFT NO.	MODEL M76/N & M76/W BATSHAFT ASSY. NO.
22'	249	63" - 57" - 54" - 63"	H60249	H24249	H8249
22'	252	63" - 57" - 57" - 63"	H60252	H24252	H8252
22'	255	63" - 58½" - 58½" - 63"	H60255	H24255	H8255
22'	258	69" - 54" - 54" - 69"	H60258	H24258	H8258
23'	261	66" - 58" - 58" - 66"	H60261	H24261	H8261
23'	267	69" - 58½" - 58½" - 69"	H60267	H24267	H8267
24'	273	69" - 63" - 60" - 69"	H60273	H24273	H8273
24'	276	69" - 63" - 63" - 69"	H60276	H24276	H8276
24'	279	69" - 64½" - 64½" - 69"	H60279	H24279	H8279
24'	282	69" - 66" - 66" - 69"	H60282	H24282	H8282
24'	288	69" - 69" - 69" - 69"	H60288	H24288	H8288
25'	291	70½" - 69" - 69" - 70½"	H60291	H24291	H8291
25'	294	70½" - 70½" - 70½" - 70½"	H60294	H24294	H8294

10" DIA CENTER TUBES, 4 BATS/BATSHAFT

NOMINAL HEADER LENGTH	REEL NUMBER	BAT LENGTH LEFT - CTR - CTR - RIGHT	REEL CENTER TUBE	MODEL M76 "A", F, M TINE BATSHAFT NO.	MODEL M76/N & M76/W BATSHAFT ASSY. NO.
27'	315	75" - 76½" - 76½" - 75"	H60315	H24315	H8315
30'	348	84" - 84" - 84" - 84"	H60348	H24348	H8348
30'	351	84½" - 84½" - 84½" - 84½"	H60351	H24351	H8351

SPECIAL ORDER LOVE REELS

10" DIA CENTER TUBES, 5 BATS/BATSHAFT

NOMINAL HEADER LENGTH	REEL NUMBER	BAT LENGTH LEFT - CTR - CTR - CTR - RIGHT	REEL CENTER TUBE	MODEL M76/N & M76 W BATSHAFT ASSY. NO.
30'	348	69" - 65½" - 65½" - 65½" - 69"	H65348	H9348
30'	351	70" - 65½" - 65½" - 65½" - 70"	H65351	H9351

LOVE PICKUP REEL DIAGRAM

MODELS
M-76
M-76/N &
M-76/W

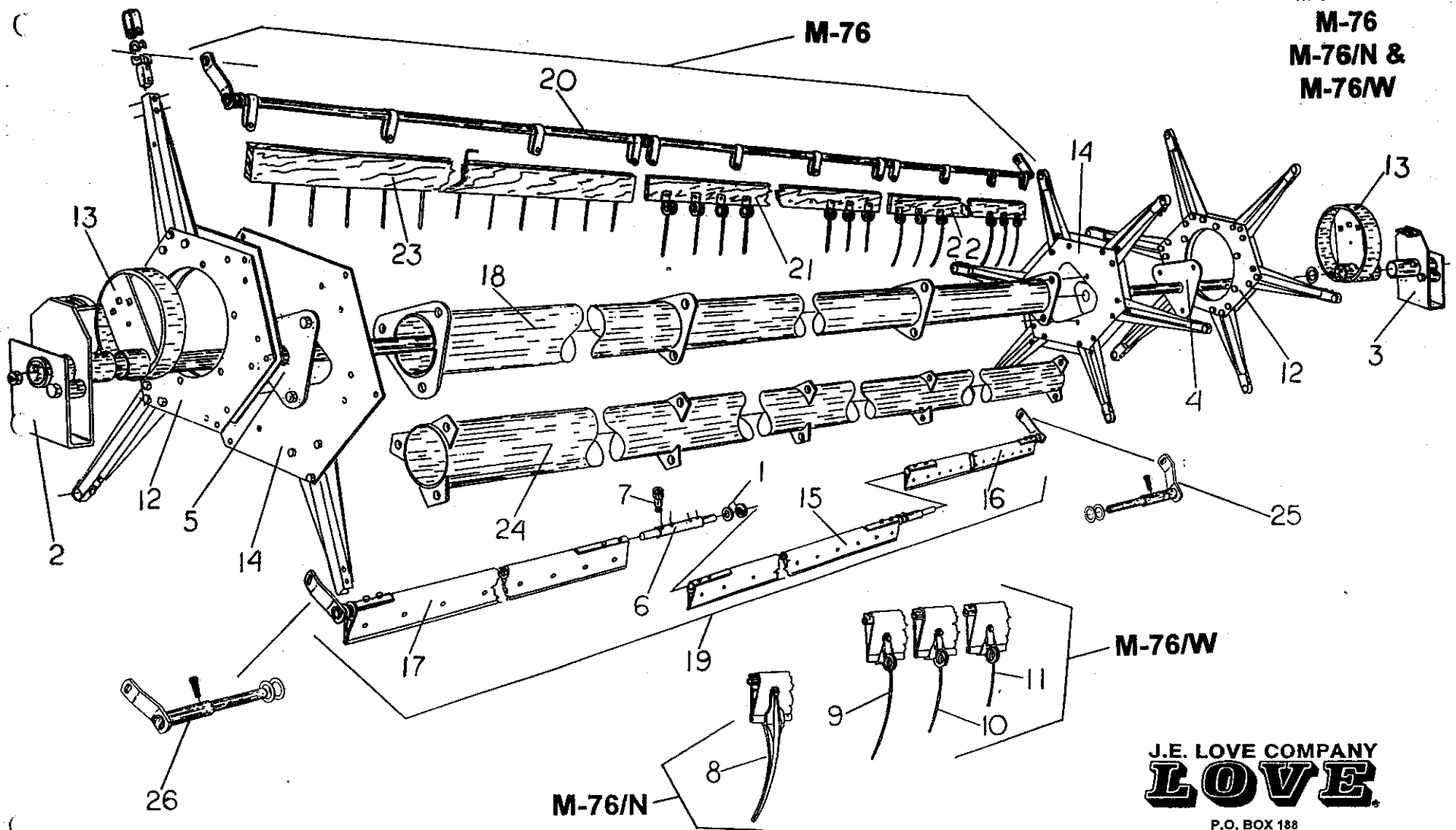

M-76/W

M-76/N

J.E. LOVE COMPANY
LOVE

P.O. BOX 188
GARFIELD, WA 99130-0188
(509) 635-1321 FAX (509) 635-1434

252R-3/96

KEY	PART NUMBER	DESCRIPTION
1	H39B X3D13790-3	MACHINERY BUSHING (USE X3D13790-3) MACHINERY BUSHING, 1-3/8" X 7/8" X #10
2		SUPPORT, REEL RH (REFER TO SPECIFIC MODEL, DRIVE & ATTACHING KIT SECTION D1-1)
3		SUPPORT, REEL LH (REFER TO SPECIFIC MODEL, DRIVE & ATTACHING KIT, SECTION D1-1)
4		SHAFT, ECCENTRIC END. (REFER TO SPECIFIC MODEL, DRIVE & ATTACHING KIT, SECTION D1-1)
5		SHAFT, DRIVE END. (REFER TO SPECIFIC MODEL, DRIVE & ATTACHING KIT, SECTION D1-1)
6	H1103	JOURNAL, SECTIONAL BATSHAFT
7	X2NS11	SCREW, HEX SOCKET HEAD SHOULDER 3/8
8	H3411 H3452	TINE, COMPOSITE. M76/N PICK UP REEL PACKAGE OF 10 H3411 TINES
9	H3433	TINE, METAL ON METAL BAT, 8" M76/W8 PICK UP REEL
10	H3460	TINE, METAL ON METAL BAT 6" M76/W6 PICK UP REEL
11	H3461	TINE, METAL ON METAL BAT 4" M76/W4 PICK UP REEL
12		ECCENTRIC SPIDER ASSEMBLY (REFER TO SPIDER BUNDLE PARTS, SECTION C1-1 NOTE 5 BAT - 6 BAT & CENTER TUBE DIA.)
13		ECCENTRIC (REFER TO SPECIFIC MODEL DRIVE & ATTACHING KIT. SECTION D1-1)
14		SPIDER ASSEMBLY (REFER TO SPIDER BUNDLE PARTS. SECTION C1-1 NOTE 5 BAT, 6 BAT & CENTER TUBE DIA.)
15	H6348 H6351 H6354 H6357 H6358 H6360 H6363 H6365½ H6364 H6366 H6369 H6370 H6372 H6375 H6376 H6378 H6381 H6384 H6385	METAL BAT, CENTER - 48" METAL BAT, CENTER - 51" METAL BAT, CENTER - 54" METAL BAT, CENTER - 57" METAL BAT, CENTER - 58-1/2" METAL BAT, CENTER - 60" METAL BAT, CENTER - 63" METAL BAT, CENTER - 65-1/2" METAL BAT, CENTER - 64-1/2" METAL BAT, CENTER - 66" METAL BAT, CENTER - 69" METAL BAT, CENTER - 70-1/2" METAL BAT, CENTER - 72" METAL BAT, CENTER - 75" METAL BAT, CENTER - 76-1/2" METAL BAT, CENTER - 78" METAL BAT, CENTER - 81" METAL BAT, CENTER - 84" METAL BAT, CENTER - 84-3/4"
16	H6445 H6446 H6451 H6452 H6457 H6458 H6463 H6464 H6466 H6469 H6470 H6472 H6475 H6478 H6481 H6484 H6485	METAL BAT, OUTSIDE LEFT END - 45" METAL BAT, OUTSIDE LEFT END - 46-1/2" METAL BAT, OUTSIDE LEFT END - 51" METAL BAT, OUTSIDE LEFT END - 52-1/2" METAL BAT, OUTSIDE LEFT END - 57" METAL BAT, OUTSIDE LEFT END - 58-1/2" METAL BAT, OUTSIDE LEFT END - 63" METAL BAT, OUTSIDE LEFT END - 64-1/2" METAL BAT, OUTSIDE LEFT END - 66" METAL BAT, OUTSIDE LEFT END - 69" METAL BAT, OUTSIDE LEFT END - 70-1/2" METAL BAT, OUTSIDE LEFT END - 72" METAL BAT, OUTSIDE LEFT END - 75" METAL BAT, OUTSIDE LEFT END - 78" METAL BAT, OUTSIDE LEFT END - 81" METAL BAT, OUTSIDE LEFT END - 84" METAL BAT, OUTSIDE LEFT END - 85"

252R-3/96

LOVE PICKUP REEL

<u>KEY</u>	<u>PART NUMBER</u>	<u>DESCRIPTION</u>
17	H6541	METAL BAT, OUTSIDE RIGHT END - 41"
	H6545	METAL BAT, OUTSIDE RIGHT END - 45"
	H6546	METAL BAT, OUTSIDE RIGHT END - 46-1/2"
	H6551	METAL BAT, OUTSIDE RIGHT END - 51"
	H6552	METAL BAT, OUTSIDE RIGHT END - 52-1/2"
	H6557	METAL BAT, OUTSIDE RIGHT END - 57"
	H6563	METAL BAT, OUTSIDE RIGHT END - 63"
	H6564	METAL BAT, OUTSIDE RIGHT END - 64-1/2"
	H6566	METAL BAT, OUTSIDE RIGHT END - 66"
	H6569	METAL BAT, OUTSIDE RIGHT END - 69"
	H6570	METAL BAT, OUTSIDE RIGHT END - 70-1/2"
	H6572	METAL BAT, OUTSIDE RIGHT END - 72"
	H6575	METAL BAT, OUTSIDE RIGHT END - 75"
	H6576	METAL BAT, OUTSIDE RIGHT END - 76-1/2"
	H6578	METAL BAT, OUTSIDE RIGHT END - 78"
	H6581	METAL BAT, OUTSIDE RIGHT END - 81"
	H6584	METAL BAT, OUTSIDE RIGHT END - 84"
	H6585	METAL BAT, OUTSIDE RIGHT END - 84-3/4"

6" DIA. CENTER TUBE

<u>KEY</u>	<u>PART NUMBER</u>	<u>DESCRIPTION</u>
18	H7105	105" REEL CENTER TUBE, 6" DIA - 2 BATS/BATSHAFT
	H7108	108" REEL CENTER TUBE, 6" DIA - 2 BATS/BATSHAFT
	H7111	111" REEL CENTER TUBE, 6" DIA - 2 BATS/BATSHAFT
	H7114	114" REEL CENTER TUBE, 6" DIA - 2 BATS/BATSHAFT
	H7117	117" REEL CENTER TUBE, 6" DIA - 2 BATS/BATSHAFT
	H7126	126" REEL CENTER TUBE, 6" DIA - 2 BATS/BATSHAFT
	H7132	132" REEL CENTER TUBE, 6" DIA - 2 BATS/BATSHAFT
	H7135	135" REEL CENTER TUBE, 6" DIA - 2 BATS/BATSHAFT
	H7138	138" REEL CENTER TUBE, 6" DIA - 2 BATS/BATSHAFT
	H7141	141" REEL CENTER TUBE, 6" DIA - 2 BATS/BATSHAFT
	H7144	144" REEL CENTER TUBE, 6" DIA - 2 BATS/BATSHAFT
	H7147	147" REEL CENTER TUBE, 6" DIA - 2 BATS/BATSHAFT
	H7150	150" REEL CENTER TUBE, 6" DIA - 2 BATS/BATSHAFT
	H7153	153" REEL CENTER TUBE, 6" DIA - 2 BATS/BATSHAFT
	H7156	156" REEL CENTER TUBE, 6" DIA - 2 BATS/BATSHAFT
	H7159	159" REEL CENTER TUBE, 6" DIA - 2 BATS/BATSHAFT
	H7162	162" REEL CENTER TUBE, 6" DIA - 2 BATS/BATSHAFT
	H7165	165" REEL CENTER TUBE, 6" DIA - 2 BATS/BATSHAFT
	H7167	167" REEL CENTER TUBE, 6" DIA - 3 BATS/BATSHAFT
	H7170	170" REEL CENTER TUBE, 6" DIA - 3 BATS/BATSHAFT
	H7171	171" REEL CENTER TUBE, 6" DIA - 3 BATS/BATSHAFT
	H7173	173" REEL CENTER TUBE, 6" DIA - 3 BATS/BATSHAFT
	H7176	176" REEL CENTER TUBE, 6" DIA - 3 BATS/BATSHAFT
	H7179	179" REEL CENTER TUBE, 6" DIA - 3 BATS/BATSHAFT
	H7182	182" REEL CENTER TUBE, 6" DIA - 3 BATS/BATSHAFT
	H7185	185" REEL CENTER TUBE, 6" DIA - 3 BATS/BATSHAFT
	H7188	188" REEL CENTER TUBE, 6" DIA - 3 BATS/BATSHAFT
	H7189	189" REEL CENTER TUBE, 6" DIA - 3 BATS/BATSHAFT
	H7194	194" REEL CENTER TUBE, 6" DIA - 3 BATS/BATSHAFT
	H7197	197" REEL CENTER TUBE, 6" DIA - 3 BATS/BATSHAFT
	H7200	200" REEL CENTER TUBE, 6" DIA - 3 BATS/BATSHAFT
	H7201	201" REEL CENTER TUBE, 6" DIA - 3 BATS/BATSHAFT
	H7203	203" REEL CENTER TUBE, 6" DIA - 3 BATS/BATSHAFT
	H7206	206" REEL CENTER TUBE, 6" DIA - 3 BATS/BATSHAFT
	H7209	209" REEL CENTER TUBE, 6" DIA - 3 BATS/BATSHAFT
	H7212	212" REEL CENTER TUBE, 6" DIA - 3 BATS/BATSHAFT
	H7215	215" REEL CENTER TUBE, 6" DIA - 3 BATS/BATSHAFT
	H7218	218" REEL CENTER TUBE, 6" DIA - 3 BATS/BATSHAFT
	H7221	221" REEL CENTER TUBE, 6" DIA - 3 BATS/BATSHAFT
	H7224	224" REEL CENTER TUBE, 6" DIA - 3 BATS/BATSHAFT
	H7227	227" REEL CENTER TUBE, 6" DIA - 3 BATS/BATSHAFT
	H7230	230" REEL CENTER TUBE, 6" DIA - 3 BATS/BATSHAFT
	H7231	231" REEL CENTER TUBE, 6" DIA - 3 BATS/BATSHAFT
	H7233	233" REEL CENTER TUBE, 6" DIA - 3 BATS/BATSHAFT
	H7236	236" REEL CENTER TUBE, 6" DIA - 3 BATS/BATSHAFT
	H7242	242" REEL CENTER TUBE, 6" DIA - 3 BATS/BATSHAFT
	H7245	245" REEL CENTER TUBE, 6" DIA - 3 BATS/BATSHAFT
	H7248	248" REEL CENTER TUBE, 6" DIA - 3 BATS/BATSHAFT

252R-3/96

METAL BATSHAFT ASSEMBLY, THE LAST 3 DIGITS OF THE ASSEMBLY CORRESPOND WITH THE REEL NUMBER.

2 BATS PER BATSHAFT.

<u>KEY</u>	<u>PART #</u>	<u>LEFT</u>	<u>RIGHT</u>
19	H8105	H6445	H6541
	H8108	H6446	H6552
	H8111	H6451	H6551
	H8114	H6452	H6552
	H8117	H6451	H6557
	H8126	H6458-1/2	H6558-1/2
	H8132	H6458-1/2	H6564
	H8135	H6463	H6563
	H8138	H6464	H6564
	H8141	H6463	H6569
	H8144	H6464	H6570
	H8147	H6469	H6569
	H8150	H6470	H6570
	H8153	H6469	H6575
	H8156	H6470	H6576
	H8159	H6475	H6575
	H8162	H6475	H6578
	H8165	H6475	H6581

3 BATS PER BATSHAFT

<u>KEY</u>	<u>PART #</u>	<u>LEFT</u>	<u>CENTER</u>	<u>RIGHT</u>
19	H8167	H6451	H6354	H6551
	H8170	H6451	H6357	H6551
	H8171	H6451	H6358	H6551
	H8173	H6457	H6348	H6557
	H8176	H6457	H6351	H6557
	H8179	H6457	H6354	H6557
	H8182	H6457	H6357	H6557
	H8185	H6457	H6360	H6557
	H8188	H6457	H6363	H6557
	H8189	H6457	H6364	H6557
	H8194	H6457	H6369	H6557
	H8197	H6463	H6360	H6563
	H8200	H6463	H6363	H6563
	H8201	H6463	H6364	H6563
	H8203	H6463	H6366	H6563
	H8206	H6469	H6357	H6563
	H8209	H6469	H6360	H6569
	H8212	H6469	H6363	H6569
	H8215	H6469	H6366	H6569
	H8218	H6469	H6369	H6569
	H8221	H6469	H6372	H6569
	H8224	H6469	H6375	H6569
	H8227	H6469	H6378	H6569
	H8230	H6469	H6381	H6569
	H8231	H6472	H6376	H6572
	H8233	H6481	H6360	H6581
	H8236	H6481	H6363	H6581
	H8242	H6481	H6369	H6581
	H8245	H6481	H6372	H6581
	H8248	H6481	H6375	H6581

4 BATS PER BATSHAFT

<u>KEY</u>	<u>PART #</u>	<u>LEFT</u>	<u>CENTER</u>	<u>CENTER</u>	<u>RIGHT</u>
19	H8249	H6463	H6357	H6354	H6563
	H8252	H6463	H6357	H6357	H6563
	H8255	H6463	H6358	H6358	H6563
	H8258	H6469	H6354	H6354	H6569
	H8261	H6466	H6358	H6358	H6566
	H8267	H6469	H6358	H6358	H6569
	H8273	H6469	H6363	H6360	H6569
	H8276	H6469	H6363	H6363	H6569
	H8279	H6469	H6364	H6364	H6569
	H8282	H6469	H6366	H6366	H6569
	H8291	H6470	H6369	H6369	H6570
	H8294	H6470	H6370	H6370	H6570
	H8315	H6475	H6376	H6376	H6575
	H8348	H6484	H6384	H6384	H6584
	H8351	H6485	H6385	H6385	H6585

LOVE PICKUP REEL

BATSHAFTS FOR REEL MODEL M76

<u>KEY</u>	<u>PART #</u>	<u>DESCRIPTION</u>	<u>KEY</u>	<u>PART #</u>	<u>DESCRIPTION</u>
20	H24105	105" BATSHAFT	20	H24203	203" BATSHAFT
	H24108	108" BATSHAFT		H24206	206" BATSHAFT
	H24111	111" BATSHAFT		H24209	209" BATSHAFT
	H24114	114" BATSHAFT		H24212	212" BATSHAFT
	H24117	117" BATSHAFT		H24215	215" BATSHAFT
	H24126	126" BATSHAFT		H24218	218" BATSHAFT
	H24132	132" BATSHAFT		H24221	221" BATSHAFT
	H24135	135" BATSHAFT		H24224	224" BATSHAFT
	H24138	138" BATSHAFT		H24227	227" BATSHAFT
	H24141	141" BATSHAFT		H24230	230" BATSHAFT
	H24144	144" BATSHAFT		H24231	231" BATSHAFT
	H24147	147" BATSHAFT		H24233	233" BATSHAFT
	H24150	150" BATSHAFT		H24236	236" BATSHAFT
	H24153	153" BATSHAFT		H24242	242" BATSHAFT
	H24156	156" BATSHAFT		H24245	245" BATSHAFT
	H24159	159" BATSHAFT		H24548	248" BATSHAFT
	H24162	162" BATSHAFT		H24249	249" BATSHAFT
	H24165	165" BATSHAFT		H24252	252" BATSHAFT
	H24167	167" BATSHAFT		H24255	255" BATSHAFT
	H24170	170" BATSHAFT		H24258	258" BATSHAFT
	H24171	171" BATSHAFT		H24261	261" BATSHAFT
	H24173	173" BATSHAFT		H24267	267" BATSHAFT
	H24176	176" BATSHAFT		H24273	273" BATSHAFT
	H24179	179" BATSHAFT		H24276	276" BATSHAFT
	H24182	182" BATSHAFT		H24279	279" BATSHAFT
	H24185	185" BATSHAFT		H24282	282" BATSHAFT
	H24188	188" BATSHAFT		H24288	288" BATSHAFT
	H24189	189" BATSHAFT		H24291	291" BATSHAFT
	H24194	194" BATSHAFT		H24294	294" BATSHAFT
	H24197	197" BATSHAFT		H24315	315" BATSHAFT
	H24200	200" BATSHAFT		H24348	348" BATSHAFT
	H24201	201" BATSHAFT		H24351	351" BATSHAFT

BATS, LESS TINES FOR "A" & "M" TINES (M-76 REEL MODELS) LAST 2 DIGITS & FRACTION SAME AS BAT LENGTH FOR (M76 MODELS) 4" TINE SPACING

<u>KEY</u>	<u>PART NUMBER</u>	<u>DESCRIPTION</u>
21 & 22	H51440-1/2	40-1/2" HARDWOOD BAT - LESS TINES 3/4" X 2-3/4"
	H51445	45" HARDWOOD BAT - LESS TINES 3/4" X 2-3/4"
	H51446-1/2	46-1/2" HARDWOOD BAT - LESS TINES 3/4" X 2-3/4"
	H51448	48" HARDWOOD BAT - LESS TINES 3/4" X 2-3/4"
	H51451	51" HARDWOOD BAT - LESS TINES 3/4" X 2-3/4"
	H51452-1/2	52-1/2" HARDWOOD BAT - LESS TINES 3/4" X 2-3/4"
	H51454	54" HARDWOOD BAT - LESS TINES 3/4" X 2-3/4"
	H51457	57" HARDWOOD BAT - LESS TINES 3/4" X 2-3/4"
	H51458-1/2	58-1/2" HARDWOOD BAT - LESS TINES 3/4" X 2-3/4"
	H51460	60" HARDWOOD BAT - LESS TINES 3/4" X 2-3/4"
	H51463	63" HARDWOOD BAT - LESS TINES 3/4" X 2-3/4"
	H51464-1/2	64-1/2" HARDWOOD BAT - LESS TINES 3/4" X 2-3/4"
	H51466	66" HARDWOOD BAT - LESS TINES 3/4" X 2-3/4"
	H51469	69" HARDWOOD BAT - LESS TINES 3/4" X 2-3/4"
	H51470-1/2	70-1/2" HARDWOOD BAT - LESS TINES 3/4" X 2-3/4"
	H51472	72" HARDWOOD BAT - LESS TINES 3/4" X 2-3/4"
	H51475	75" HARDWOOD BAT - LESS TINES 3/4" X 2-3/4"
	H51476-1/2	76-1/2" HARDWOOD BAT - LESS TINES 3/4" X 2-3/4"
	H51478	78" HARDWOOD BAT - LESS TINES 3/4" X 2-3/4"
	H51481	81" HARDWOOD BAT - LESS TINES 3/4" X 2-3/4"
	H51484	84" HARDWOOD BAT - LESS TINES 3/4" X 2-3/4"
	H51484-3/4	84-3/4" HARDWOOD BAT - LESS TINES 3/4" X 2-3/4"

NOTE: WHEN ORDERING BAT WITH TINES, ADD THE TINE LETTER TO THE PART NUMBER OF THE BAT LESS TINES.

**EXAMPLE: H51469 BAT LESS TINES
 H51469A BAT WITH TINES
 H51469M BAT WITH TINES**

FOR CORRECT BAT LENGTH REFER TO REEL NUMBER, THEN TO BAT LENGTH AS INDICATED ON REEL PARTS REFERENCE, CHART PAGE B1-1

252R-3/96

**BATS LESS TUBES FOR "F" TINE, (M76 REEL MODELS)
LAST 2 DIGITS & FRACTION SAME AS BAT LENGTH. (FOR M76 MODELS) 3" SPACING.**

<u>KEY</u>	<u>PART NUMBER</u>	<u>DESCRIPTION</u>
23	H53340-1/2	40-1/2" HARDWOOD BAT - LESS TINES 3/4" X 3-3/4"
	H53345	45" HARDWOOD BAT - LESS TINES 3/4" X 3-3/4"
	H53346-1/2	46-1/2" HARDWOOD BAT - LESS TINES 3/4" X 3-3/4"
	H53348	48" HARDWOOD BAT - LESS TINES 3/4" X 3-3/4"
	H53351	51" HARDWOOD BAT - LESS TINES 3/4" X 3-3/4"
	H53352-1/2	52-1/2" HARDWOOD BAT - LESS TINES 3/4" X 3-3/4"
	H53354	54" HARDWOOD BAT - LESS TINES 3/4" X 3-3/4"
	H53357	57" HARDWOOD BAT - LESS TINES 3/4" X 3-3/4"
	H53358-1/2	58" HARDWOOD BAT - LESS TINES 3/4" X 3-3/4"
	H53360	60" HARDWOOD BAT - LESS TINES 3/4" X 3-3/4"
	H53363	63" HARDWOOD BAT - LESS TINES 3/4" X 3-3/4"
	H53364-1/2	64-1/2" HARDWOOD BAT - LESS TINES 3/4" X 3-3/4"
	H53366	66" HARDWOOD BAT - LESS TINES 3/4" X 3-3/4"
	H53369	69" HARDWOOD BAT - LESS TINES 3/4" X 3-3/4"
	H53370-1/2	70-1/2" HARDWOOD BAT - LESS TINES 3/4" X 3-3/4"
	H53372	72" HARDWOOD BAT - LESS TINES 3/4" X 3-3/4"
	H53375	75" HARDWOOD BAT - LESS TINES 3/4" X 3-3/4"
	H53376-1/2	76-1/2" HARDWOOD BAT - LESS TINES 3/4" X 3-3/4"
	H53378	78" HARDWOOD BAT - LESS TINES 3/4" X 3-3/4"
	H53381	81" HARDWOOD BAT - LESS TINES 3/4" X 3-3/4"
	H53384	84" HARDWOOD BAT - LESS TINES 3/4" X 3-3/4"
	H53384-3/4	84-3/4" HARDWOOD BAT - LESS TINES 3/4" X 3-3/4"

NOTE: WHEN ORDERING BAT WITH TINES ADD THE TINE LETTER TO THE PART NUMBER OF THE BAT LESS TINE.

EXAMPLE: H53369 BAT LESS TINE

H53369F BAT WITH "F" TINES

FOR CORRECT BAT LENGTH REFER TO REEL NUMBER, THEN TO THE BAT LENGTH AS INDICATED ON REEL PARTS REFERENCE CHART, PAGE B1-1

8" AND 10" DIA. CENTER TUBES

<u>KEY</u>	<u>PART NUMBER</u>	<u>DESCRIPTION</u>
24	H60249	249" CENTER TUBE 8" DIA 4 BATS/BATSHAFT
	H60252	252" CENTER TUBE 8" DIA 4 BATS/BATSHAFT
	H60255	255" CENTER TUBE 8" DIA 4 BATS/BATSHAFT
	H60258	258" CENTER TUBE 8" DIA 4 BATS/BATSHAFT
	H60261	261" CENTER TUBE 8" DIA 4 BATS/BATSHAFT
	H60267	267" CENTER TUBE 8" DIA 4 BATS/BATSHAFT
	H60273	273" CENTER TUBE 8" DIA 4 BATS/BATSHAFT
	H60276	276" CENTER TUBE 8" DIA 4 BATS/BATSHAFT
	H60279	279" CENTER TUBE 8" DIA 4 BATS/BATSHAFT
	H60282	282" CENTER TUBE 8" DIA 4 BATS/BATSHAFT
	H60288	288" CENTER TUBE 8" DIA 4 BATS/BATSHAFT
	H60291	291" CENTER TUBE 8" DIA 4 BATS/BATSHAFT
	H60294	294" CENTER TUBE 8" DIA 4 BATS/BATSHAFT
24	H60315	315" CENTER TUBE 10" DIA 4 BATS/BATSHAFT
	H60348	348" CENTER TUBE 10" DIA 4 BATS/BATSHAFT
	H60351	351" CENTER TUBE 10" DIA 4 BATS/BATSHAFT
25	H7600	JOURNAL, LH CRANK - SLOTTED
26	H7601	JOURNAL, RH CRANK - SLOTTED

TINES AND OUTBOARD FINGERS

M76

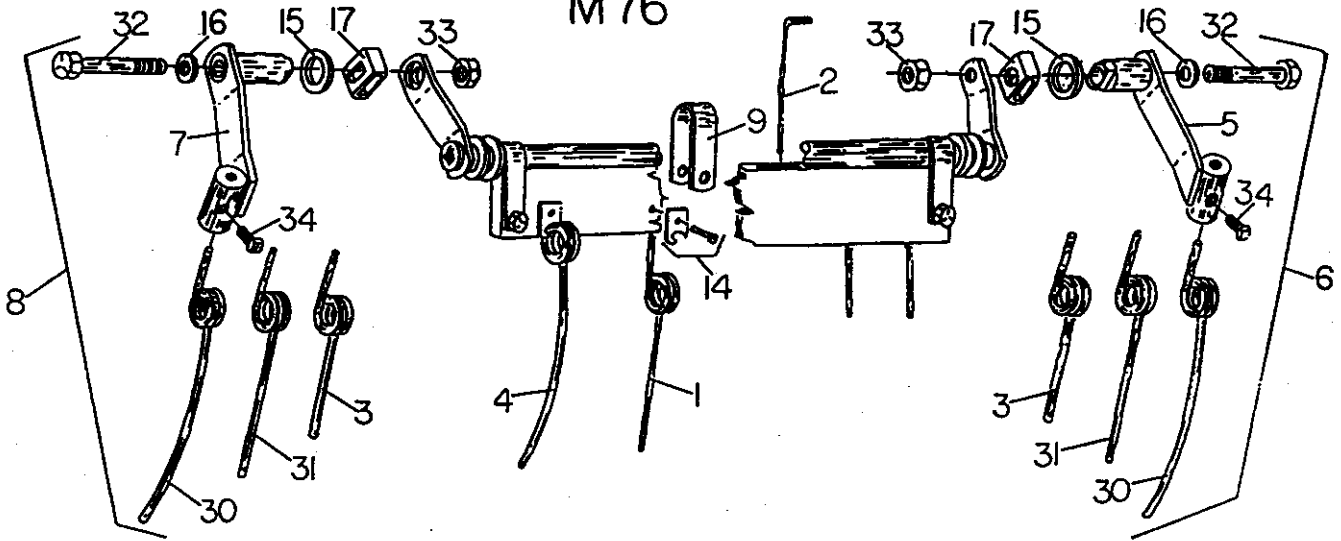

M76/N

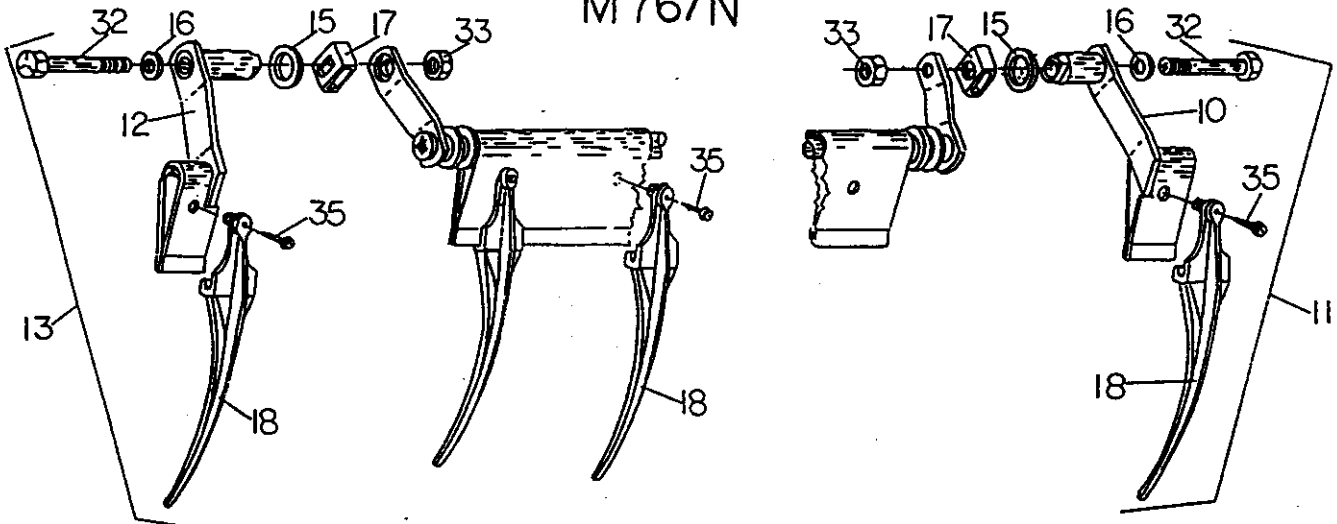

M76/W

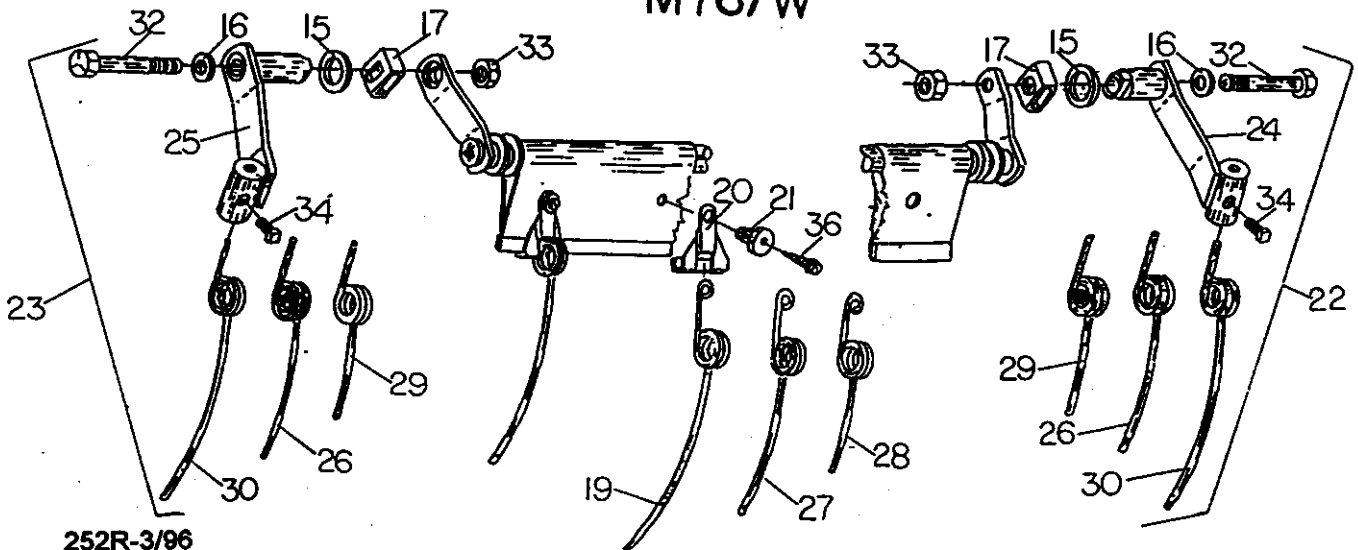

252R-3/96

TINES AND OUTBOARD FINGERS

<u>KEY</u>	<u>PART NUMBER</u>	<u>DESCRIPTION</u>
1	HA	A TINE, 6" STRAIGHT
2	HF	F TINE, 4" SPIKE
3	HG	OUTBOARD FINGER TINE FOR F TINE REEL
4	HM	M TINE, 8" CURVED
5	H13	OUTBOARD FINGER BRACKET, LH
6	H13A	OUTBOARD FINGER ASSEMBLY, LH W/H3479
	H13G	OUTBOARD FINGER ASSEMBLY, LH W/HG TINE
	H13M	OUTBOARD FINGER ASSEMBLY, LH W/H3476 TINE
7	H14	OUTBOARD FINGER BRACKET, RH
8	H14A	OUTBOARD FINGER ASSEMBLY, RH W/3479 TINE
	H14G	OUTBOARD FINGER ASSEMBLY, RH W/HG TINE
	H14M	OUTBOARD FINGER ASSEMBLY, RH W/H3476 TINE
9	H19A	BATSHAFT CLIP
10	H31	OUTBOARD FINGER BRACKET, LH
11	H31N	OUTBOARD FINGER ASSEMBLY, LH W/H3411 TINE
12	H32	OUTBOARD FINGER BRACKET, RH
13	H32N	OUTBOARD FINGER ASSEMBLY, RH W/H3411 TINE
14	H34	TINE CLIP W/RIVET
15	X3D13790-3	MACHINERY BUSHING (H39B)
16	H293	WASHER, HEAVY DUTY
17	H390	POSITION CLIP, OUTBOARD FINGER
18	H3411	COMPOSITE TINE ASSEMBLY. (N TINE)
	H3452	PACKAGE OF 10 H3411 TINES
19	H3433	TINE, METAL ON METAL BAT, 8"
20	H3434	CLIP FOR H3433, H3460 & H3461 TINES
21	H3454	BUTTON, STEEL TINE RETAINER
22	H3455	OUTBOARD FINGER ASSEMBLY, LH W/H3459 TINES
	H3462	OUTBOARD FINGER ASSEMBLY, LH W/H3464 TINE
	H3465	OUTBOARD FINGER ASSEMBLY, LH W/H3476 TINE
23	H3456	OUTBOARD FINGER ASSEMBLY, RH W/H3459 TINE
	H3463	OUTBOARD FINGER ASSEMBLY, RH W/H3464 TINE
	H3466	OUTBOARD FINGER ASSEMBLY, RH W/H3476 TINE
24	H3457	OUTBOARD FINGER BRACKET, LH
25	H3458	OUTBOARD FINGER BRACKET, RH
26	H3459	OUTBOARD FINGER TINE, 6"
27	H3460	TINE, METAL ON METAL BAT, 6"
28	H3461	TINE, METAL ON METAL BAT, 4"
29	H3464	OUTBOARD FINGER TINE, 4"
30	H3476	OUTBOARD FINGER TINE, 8"
31	H3479	OUTBOARD FINGER TINE, HA
32	X2A0430250	CAP SCREW, 7/16- 14 UNC X 2-1/2"
33	X2E043-NF2	7/16 X 14 UNC SIDE LOCK NUT
34	X2F037050	SET SCREW
35	X2K0060062	SCREW, SELF TAP X 5/8"
36	X2K0060100	SCREW, SELF TAP X 1"

CRANK JOURNALS, LH & RH

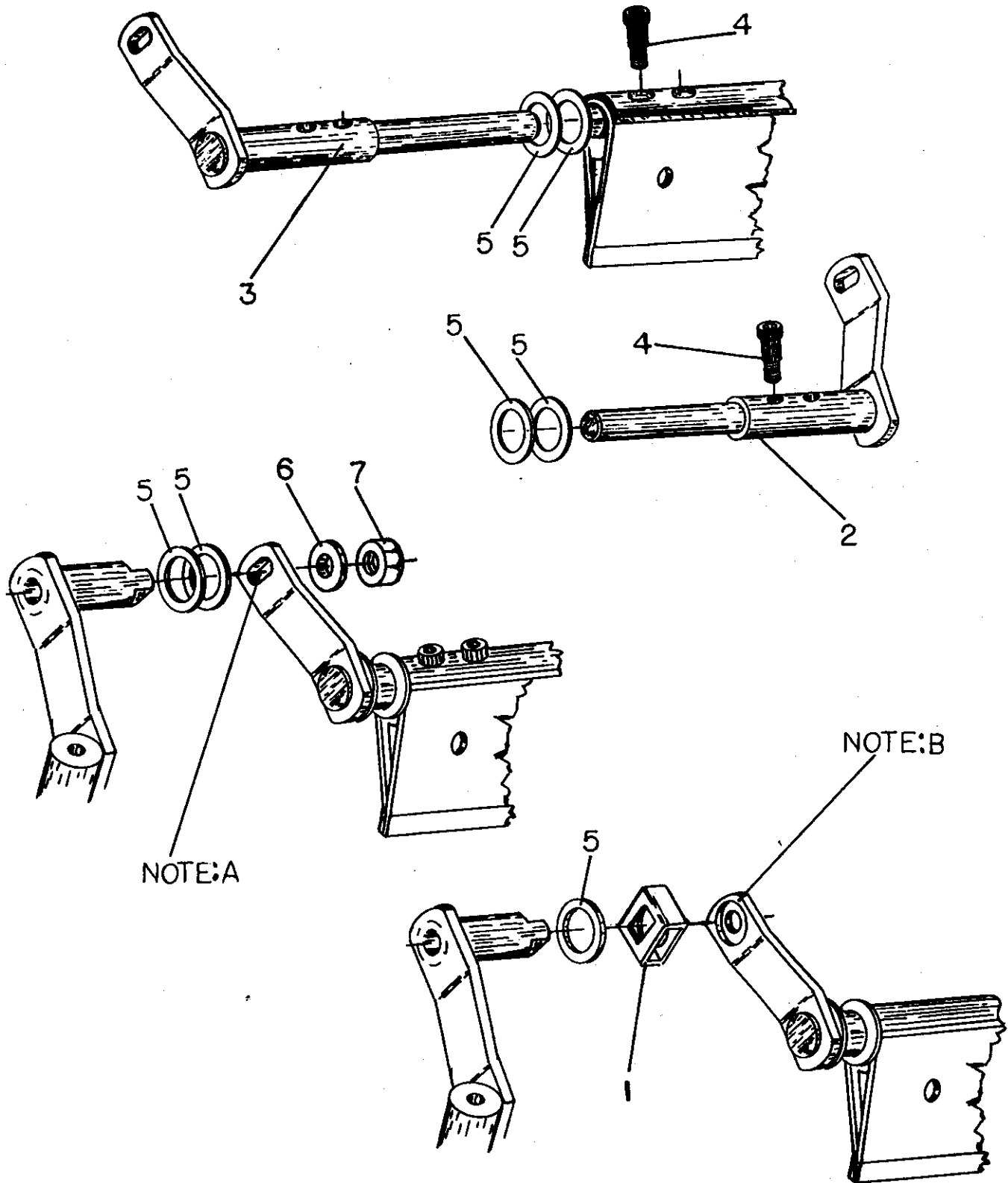

CRANK JOURNALS, LH & RH

<u>KEY</u>	<u>PART NO.</u>	<u>DESCRIPTION</u>
1	H390	POSITION CLIP, OUTBOARD FINGER
2	H7600	CRANK JOURNAL, LH
3	H7601	CRANK JOURNAL, RH
4	X2NS11	SCREW, HEX SOCKET HEAD SHOULDER - 3/8"
5	X3D13790-3	MACHINERY BUSHING
6	X3C043	FLAT WASHER, 7/16
7	X2E043-NF2	LOCK NUT, 7/16-14 UNC

NOTE A: Crank journals H7600 and H7601 have a D-slot hole for the outboard finger. The H390 position clip is not used with the D-slot hole crank journals. These crank journals do require 2 machine bushings, one on each side of the H7004 bearing, and a 7/16 flat washer under the lock nut.

NOTE B: Crank journals with a round countersunk hole require the H390 position clip. Only one machinery bushing is used. It is positioned on the outboard side of the H7004 bearing.

SPIDER BUNDLES

FOR

6" DIA. REEL CENTER TUBE AND 8" & 10" DIA. REEL CENTER TUBE REELS

	5 BAT REELS	6 BAT REELS
6" DIA CENTER TUBE	REEL PACKAGES 10 FT - M5-105 TO 14 FT M5-165 WILL USE SPIDER BUNDLE M5-5-41 REEL PACKAGES 15 FT - M5-167 TO 21 FT M5-248 WILL USE SPIDER BUNDLE M5-6-41	REEL PACKAGES 10 FT - M6-105 TO 14 FT M6-165 WILL USE SPIDER BUNDLE M6-5-41 REEL PACKAGES 15 FT - M6-167 TO 21 FT M6-248 WILL USE SPIDER BUNDLE M6-6-41
8" AND 10" DIA CENTER TUBE	REEL PACKAGES 22 FT - M5-249 TO 30 FT M5-351 WILL USE SPIDER BUNDLE M5-7-41	REEL PACKAGES 22 FT - M6-249 TO 30 FT M6-351 WILL USE SPIDER BUNDLE M6-7-41

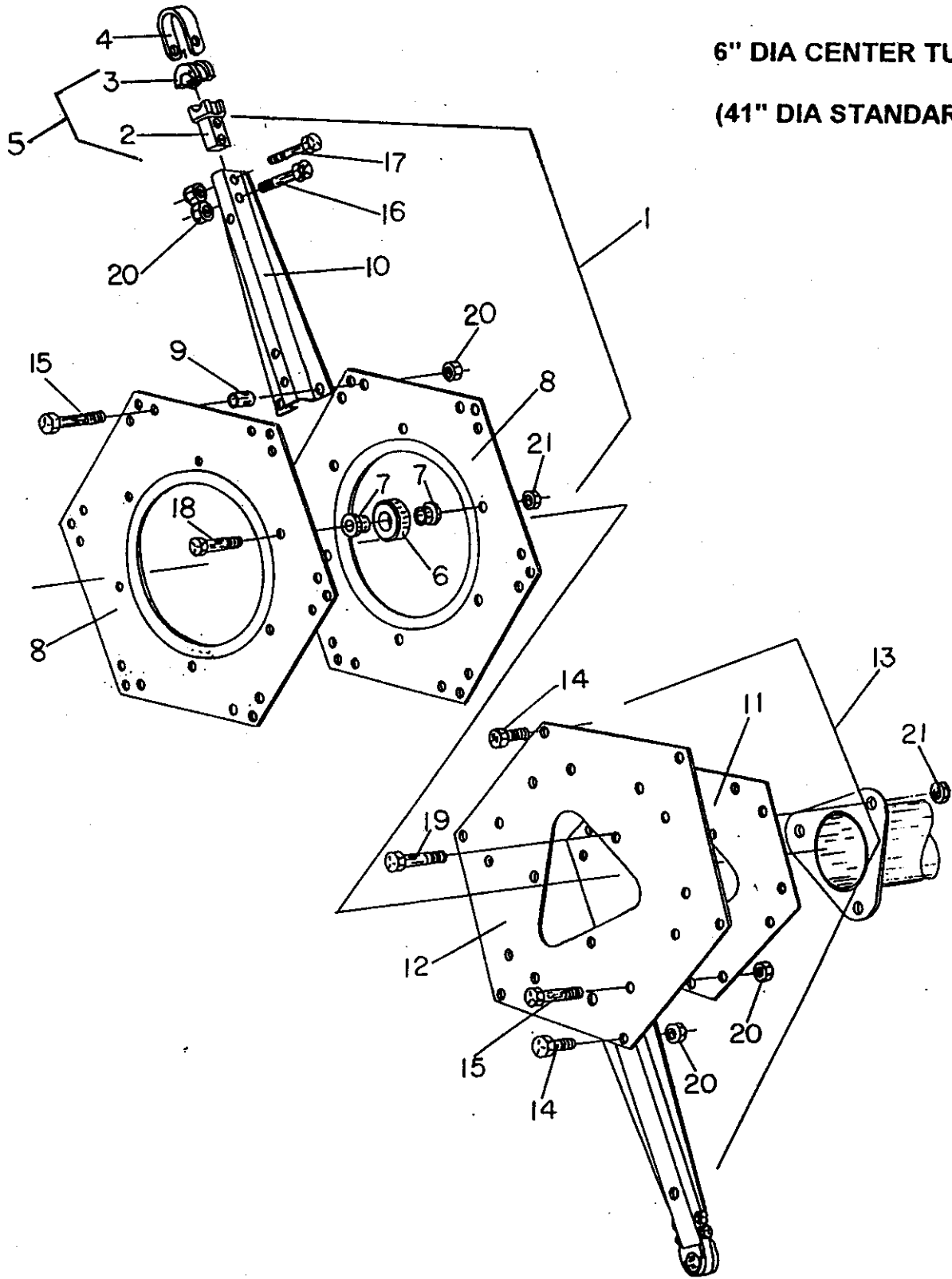

SPIDER BUNDLE PARTS

6" DIA CENTER TUBE (41" DIA STANDARD)

<u>KEY</u>	<u>PART NO.</u>	<u>DESCRIPTION</u>
1	H5141	ECCENTRIC SPIDER ASSEMBLY, 5 BAT
	H6141	ECCENTRIC SPIDER ASSEMBLY, 6 BAT
2	H7001	BASE, BATSHAFT BEARING
3	H7002	CAP, BATSHAFT BEARING
4	H7003	U-CLIP, BATSHAFT BEARING
5	H7004	BATSHAFT BEARING SET (H7001 & H7002)
6	H7022	ECCENTRIC ROLLER BEARING
7	H7023	BUSHING, ECCENTRIC BEARING
8	H7025	ECCENTRIC SPIDER RING, 5 BAT
	H7026	ECCENTRIC SPIDER RING, 6 BAT
9	H7027	SPACER
10	H7037	REEL ARM, 37" DIA (11")
	H7041	REEL ARM, 41" DIA (13")
	H7045	REEL ARM, 45" DIA (15")
	H7053	REEL ARM, 53" DIA (19")
11	H60105	SPIDER PLATE, SMALL, 5 BAT
	H60106	SPIDER PLATE, SMALL, 6 BAT
12	H60115	SPIDER PLATE, LARGE, 5 BAT
	H60116	SPIDER PLATE, LARGE, 6 BAT
13	H60135	SPIDER ASSEMBLY, 5 BAT - 41" DIA
	H60136	SPIDER ASSEMBLY, 6 BAT - 41" DIA
14	X2A0310050	CAP SCREW, 5/16 18 UNC X 1/2
15	X2A0310137	CAP SCREW, 5/16-18 UNC X 1-3/8
16	X2A0310150	CAP SCREW, 5/16-18 UNC X 1-1/2
17	X2A0310175	CAP SCREW, 5/16-18 UNC X 1-3/4
18	X2A0430150	CAP SCREW, 7/16-14 UNC X 1-1/2
19	X2A0430175	CAP SCREW, 7/16-14 UNC X 1-3/4
20	X2E031-NF2	HEX NUT, 5/16-18 UNC CENTER LOCK
21	X2E043-NF2	LOCK NUT, NO FLANGE SIDE LOCK, 7/16" L NC

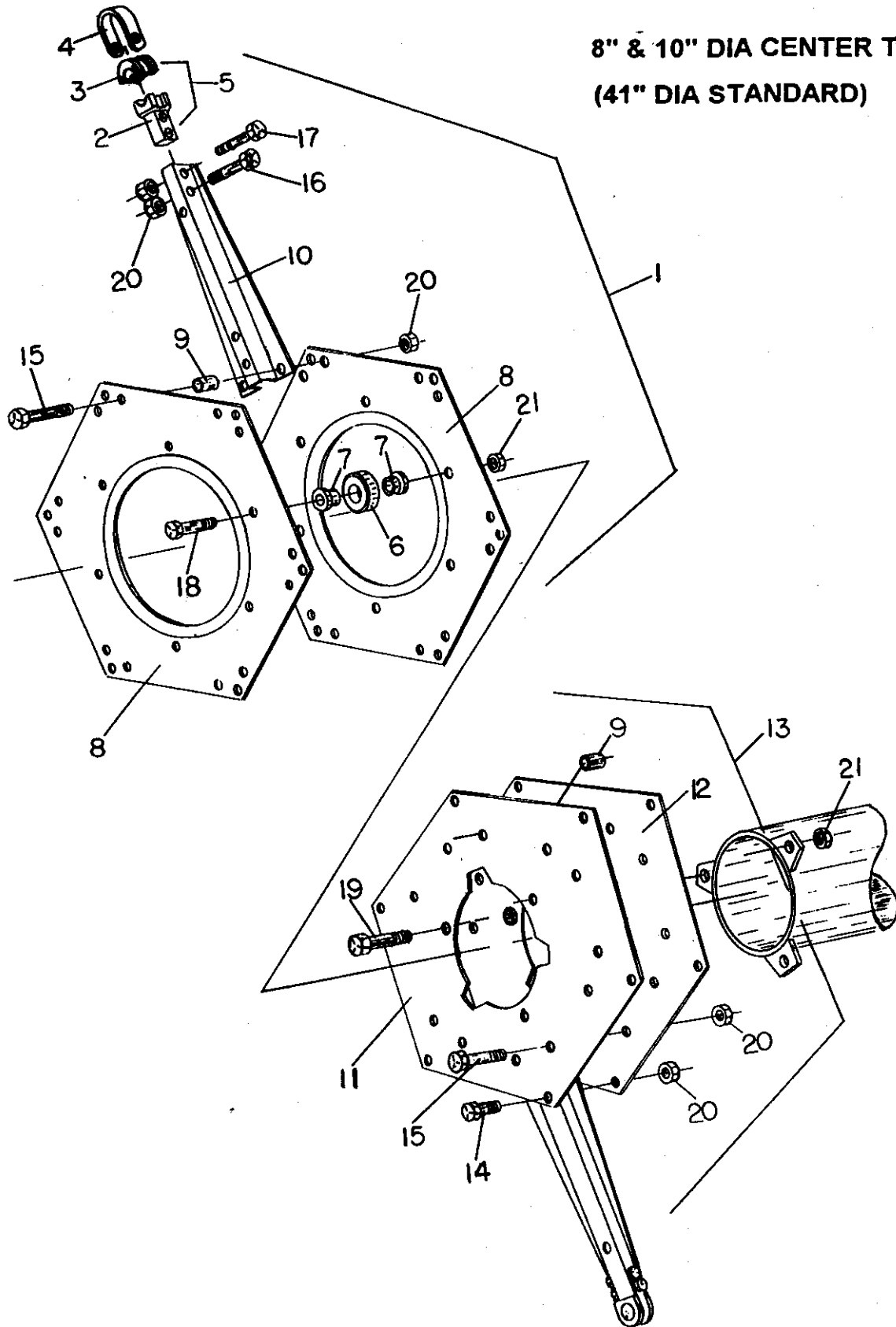

SPIDER BUNDLE PARTS
8" & 10" DIA CENTER TUBE (41" DIA STANDARD)

<u>KEY</u>	<u>PART NO.</u>	<u>DESCRIPTION</u>
1	H5141	ECCENTRIC SPIDER ASSEMBLY, 5 BAT
	H6141	ECCENTRIC SPIDER ASSEMBLY, 6 BAT
2	H7001	BASE, BATSHAFT BEARING
3	H7002	CAP, BATSHAFT BEARING
4	H7003	U-CLIP, BATSHAFT BEARING
5	H7004	BATSHAFT BEARING SET (H7001 & H7002)
6	H7022	ECCENTRIC ROLLER BEARING
7	H7023	BUSHING, ECCENTRIC BEARING
8	H7025	ECCENTRIC SPIDER RING, 5 BAT
	H7026	ECCENTRIC SPIDER RING, 6 BAT
9	H7027	SPACER
10	H7037	REEL ARM, 37" DIA (11")
	H7041	REEL ARM, 41" DIA (13")
	H7045	REEL ARM, 45" DIA (15")
	H7053	REEL ARM, 53" DIA (19")
11	H60215	SPIDER PLATE, LARGE, 5 BAT - LH
	H60216	SPIDER PLATE, LARGE, 6 BAT - LH
12	H60232	SPIDER PLATE, LARGE, 5 BAT - RH
	H60234	SPIDER PLATE, LARGE, 6 BAT - RH
13	H60235	SPIDER ASSEMBLY, 5 BAT - 8" & 10" CENTER TUBE, 41" STD
	H60236	SPIDER ASSEMBLY, 6 BAT - 8" & 10" CENTER TUBE, 41" STD
14	X2A0310050	CAP SCREW, 5/16-18 UNC X 1/2
15	X2A0310137	CAP SCREW, 5/16-18 UNC X 1-3/8
16	X2A0310150	CAP SCREW, 5/16-18 UNC X 1-1/2
17	X2A0310175	CAP SCREW, 7/16-18 UNC X 1-3/4
18	X2A0430150	CAP SCREW, 7/16-14 UNC X 1-1/2
19	X2A0430175	CAP SCREW, 7/16-14 UNC X 1-3/4
20	X2E031-NF2	HEX NUT, 5/16-18 UNC CENTER LOCK
21	X2E043-NF2	LOCK NUT, NO FLANGE SIDE LOCK, 7/16" UNC
NS	H7052	REEL ARM BRACE, 5 BAT 41" DIA STD (OPTIONAL)
	H7054	REEL ARM BRACE, 6 BAT 41" DIA STD (OPTIONAL)

**SPECIFIC MODEL
DRIVE & ATTACHING KITS (DA----)**

DRIVE & ATTACHING KITS ARE COMPOSED OF THE SPECIAL COMPONENTS REQUIRED TO DRIVE AND ATTACH THE LOVE PICKUP REEL TO THE SPECIFIC MAKE & MODEL OF COMBINE OR SWATHER, AND IN SOME CASES ANY OTHER SPECIAL SPECIFICATION.

DRIVE & ATTACHING KIT NUMBERS ARE IDENTIFIED BY NUMBER ON THE REEL SPECIFICATION PAGES OF THIS MANUAL. PLEASE CONTACT J. E. LOVE CO. FOR ADDITIONAL INFORMATION IF THE MAKE AND MODEL OF COMBINE OR SWATHER IS NOT LISTED.

PARTS ILLUSTRATION WILL BE PROVIDED FOR SPECIFIC DA KITS WITH LOVE PICKUP REEL ORDERS AND UPON REQUEST. THESE PAGES MAY BE INSERTED IN THIS MANUAL IN SECTION D.