

Calkins

CHISEL CHOPPER

Parts Manual

J.E. LOVE COMPANY

LOVE®

309 W. CALIFORNIA STREET
P.O. BOX 188
GARFIELD, WASHINGTON 99130-0188
(509) 635-1321 FAX: (509) 635-1434
www.jeloveco.com

CAUTION

BLOCK SECURELY

Do not place yourself under any equipment suspended hydraulically, with mechanical stops, jacks or hoists, without blocking securely.

Make sure machine cannot roll.

Table of Contents

Title	Page
Caution / Warning	-
Table of contents	1,2
Decal layout	3
Chisel chopper frame	4,5
17 ft. frame extensions	6,7
20 ft. frame extensions	8,9
Tandem wheel leg assemblies	10,11
Wheel leg, Walking beam, Hub & Spindle components	12,13
Adjustable linkage assembly, Cylinder lock & Depth stops	14,15
Front mount arm, Front hinge mount & Hydraulic cylinder	16,17
Hydraulics layout	18,19
Front mount arm, Cross tongue & Spring tower	20,21
Spring tower assembly	22,23
2 Blade coulters assembly	24,25
3 Blade coulters assembly	26,27
5 Blade coulters assembly	28,29
6 Blade coulters assembly	30,31
13 ft. Front coulters mounting	32,33
15 ft. Front coulters mounting	34,35
17 ft. Front coulters mounting	36,37
20 ft. Front coulters mounting	38,39
Forward shank mount	40,41
Chisel plow shank assembly	42,43
Rear support assembly, 51" left hand LH	44,45
Rear support assembly, 51" right hand RH	46,47
Rear support assembly, 68" left hand LH	48,49
Rear support assembly, 68" right hand RH	50,51
Rear support assembly, 72"	52,53
Rear support assembly, 93"	54,55
Single chopper gang assembly	56,57
Dual chopper gang assembly	58,59
13 ft. Chisel chopper	60,61
Chisel plow shanks, Rear support assy, & Chopper gangs	

Table of contents

Title	Page
15 ft. Chisel chopper -----	62,63
Chisel plow shanks, Rear support assy & Chopper gangs	
17 ft. Chisel chopper -----	64,65
Chisel plow shanks , Rear support assy & Chopper gangs	
20 ft. Chisel chopper -----	66,67
Chisel plow shanks, Rear support assy & Chopper gangs	
Part number page reference section-----	A-1 thru A-8

Decal layout

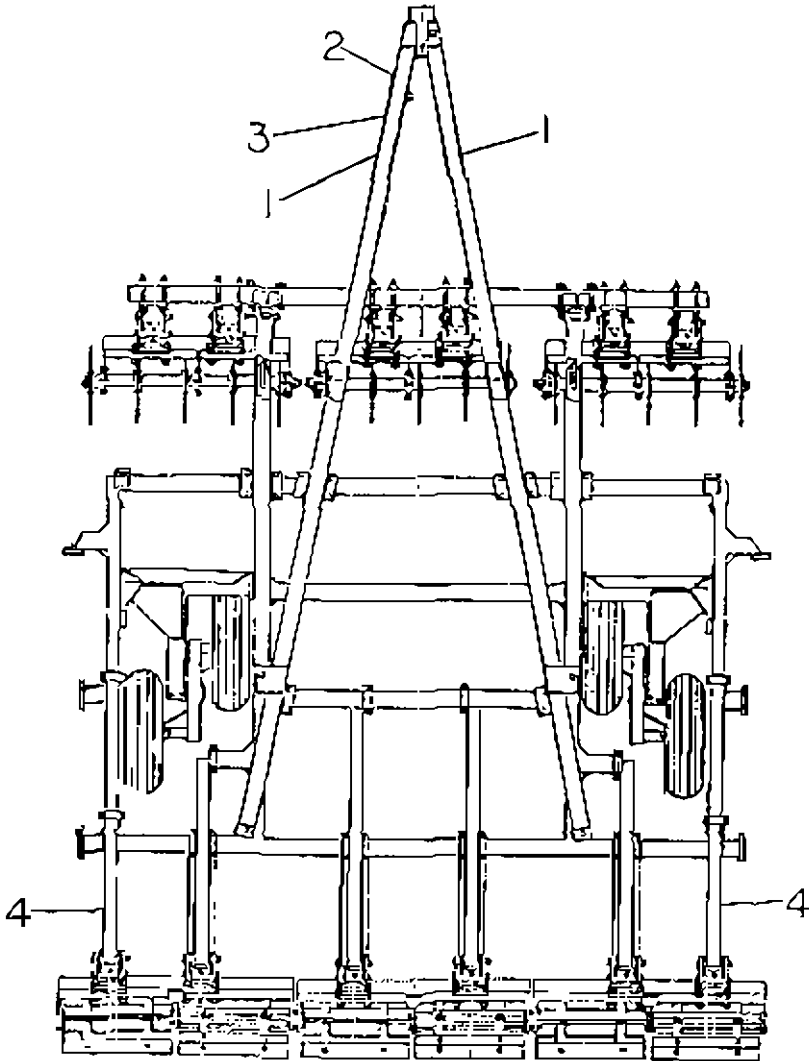

Key	Part No.	Description
1	5359-415	Calkins, large decal
2	5359-423	Yellow warning, decal
3	5359-411	No rider, decal
4	5359-425	Chisel chopper, decal

Chisel Chopper Frame

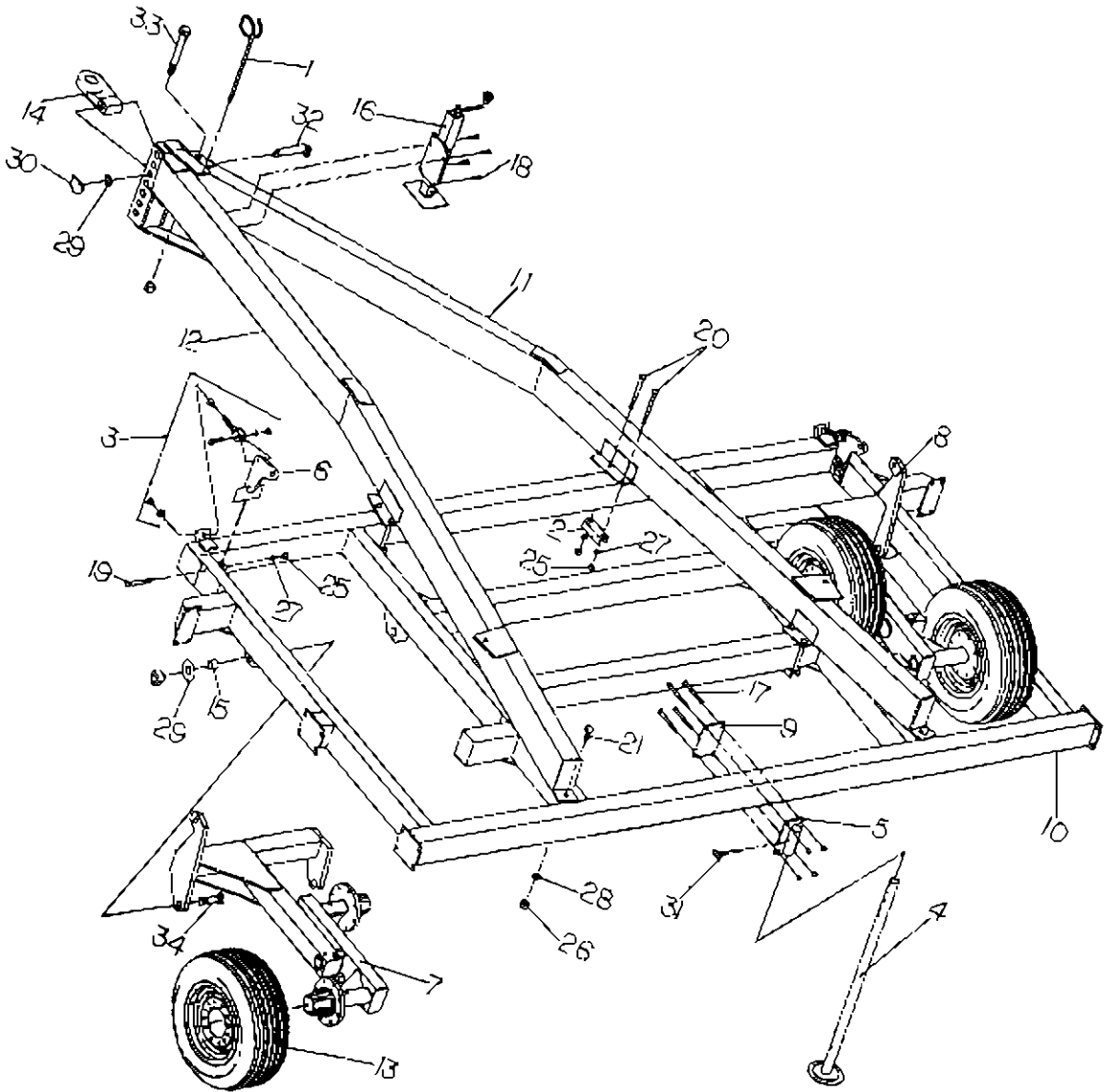

Chisel Chopper Frame

Key	Part No.	Description
1	0101-037	Hydraulic hose mast assembly
2	0206-031	Clamp plate, formed
3	0410-581	Adjustable linkage assembly
4	0420-102	Rear stand
5	0420-103	Rear stand adjustment bracket
6	0420-295	Cylinder pivot arm
7	0420-410	Wheel leg assembly, L.H
8	0420-415	Wheel leg assembly, R.H
9	0420-936	Base plate
10	0425-001	Center frame module
11	0425-022	Bent tongue, RH
12	0425-023	Bent tongue, LH
13	5639-027	Tire & wheel, 11L x 15, 8 ply, ribbed
14	5919-900	Tongue flapper
15	6136-675	Bushing, 1.75" OD x 1.53" ID x 1.438"
16	6329-055	Tongue jack
17	7114-060	Cap screw, 5/8" NC x 6"
18	7114-109	Cap screw, 5/8" NC x 2"
19	7115-075	Cap screw, 3/4" NC x 5 1/2"
20	7115-080	Cap screw, 3/4" NC x 8"
21	7116-025	Cap screw, 1" NC x 2 1/2"
22	7717-255	Lock nut, 1 1/4" NC
23	7717-555	Lock nut, 1 1/2" NC
24	7724-120	Lock nut, 5/8" NC
25	7725-002	Hex nut, 3/4" NC
26	7726-005	Hex nut, 1" NC
27	7845-020	Lock washer, 3/4"
28	7846-020	Lock washer, 1"
29	7896-500	Machine bushing, 1 1/2" x 10 GA. NR
30	7920-010	Driveline, lock pin, 5/16" x 2 3/4"
31	7920-012	Hitch pin, 1/2" x 4" With safety pin
32	8036-025	Pin, 1 1/2" x 5 13/16"
33	8116-006	Bolt, 1 1/4" NC x 10 1/2"
34	8117-003	Bolt, 1 1/2" NC x 4 1/2"

17 ft. Frame Extensions

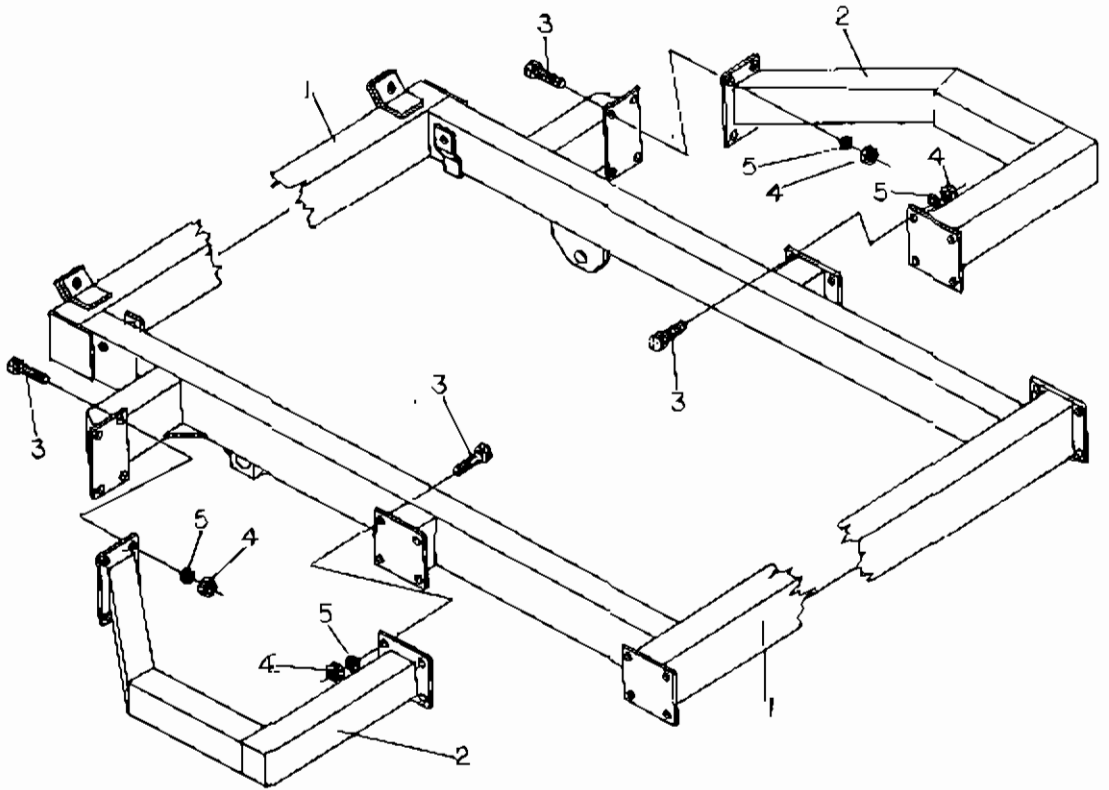

17 ft. Frame Extensions

Key	Part No.	Description
1	0425-001	Center Frame Module
2	0425-060	Frame Extension
3	7114-109	Cap screw, 5/8" NC x 2"
4	7724-005	Hex nut, 5/8" NC
5	7844-020	Lockwasher, 5/8"

20 ft. Frame Extensions

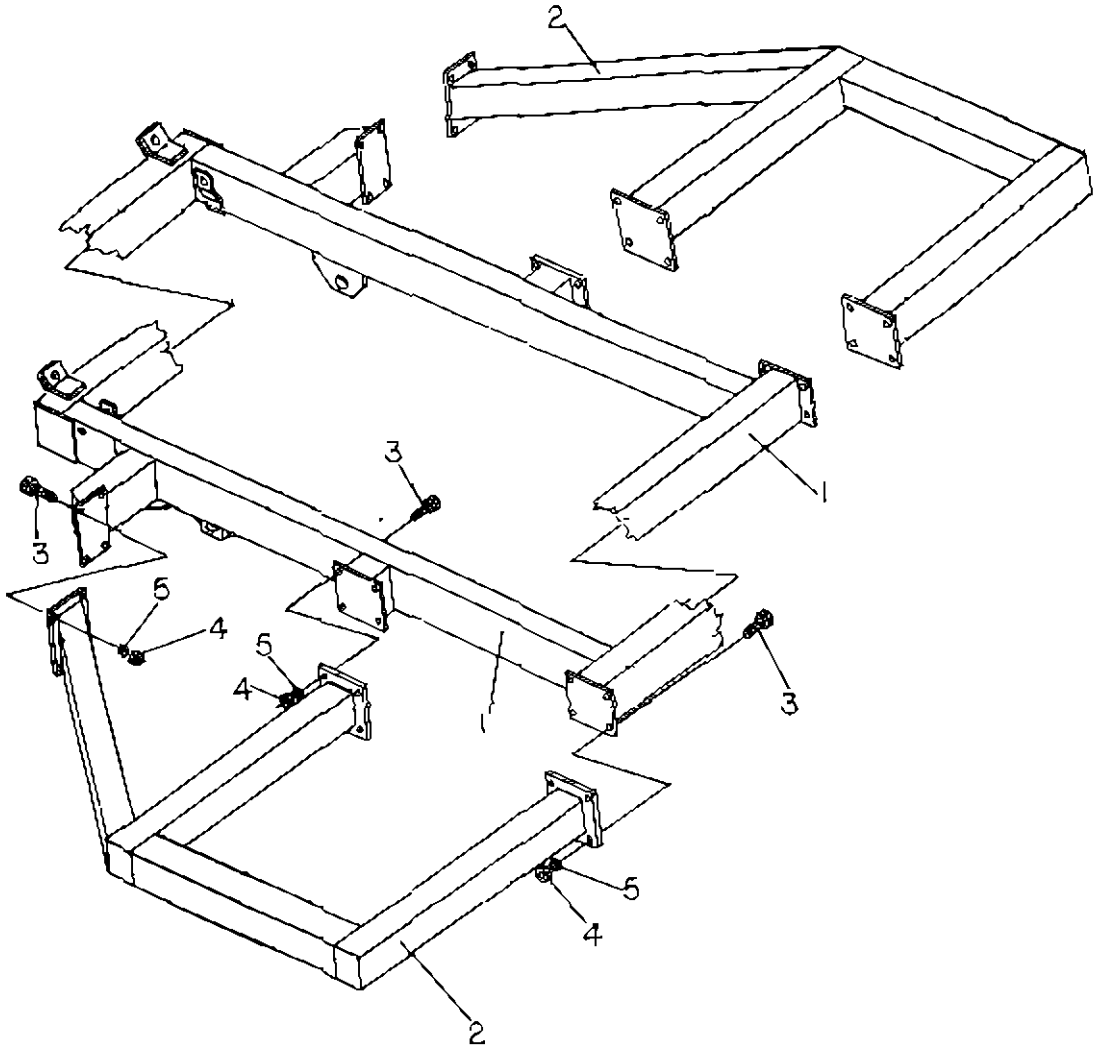

20 ft. Frame Extensions

Key	Part No.	Description
1	0425-001	Center Frame Module
2	0425-061	Frame Extension
3	7114-109	Cap screw, 5/8" NC x 2"
4	7724-005	Hex nut, 5/8" NC
5	7844-020	Lockwasher, 5/8"

Tandem Wheel Leg Assemblies

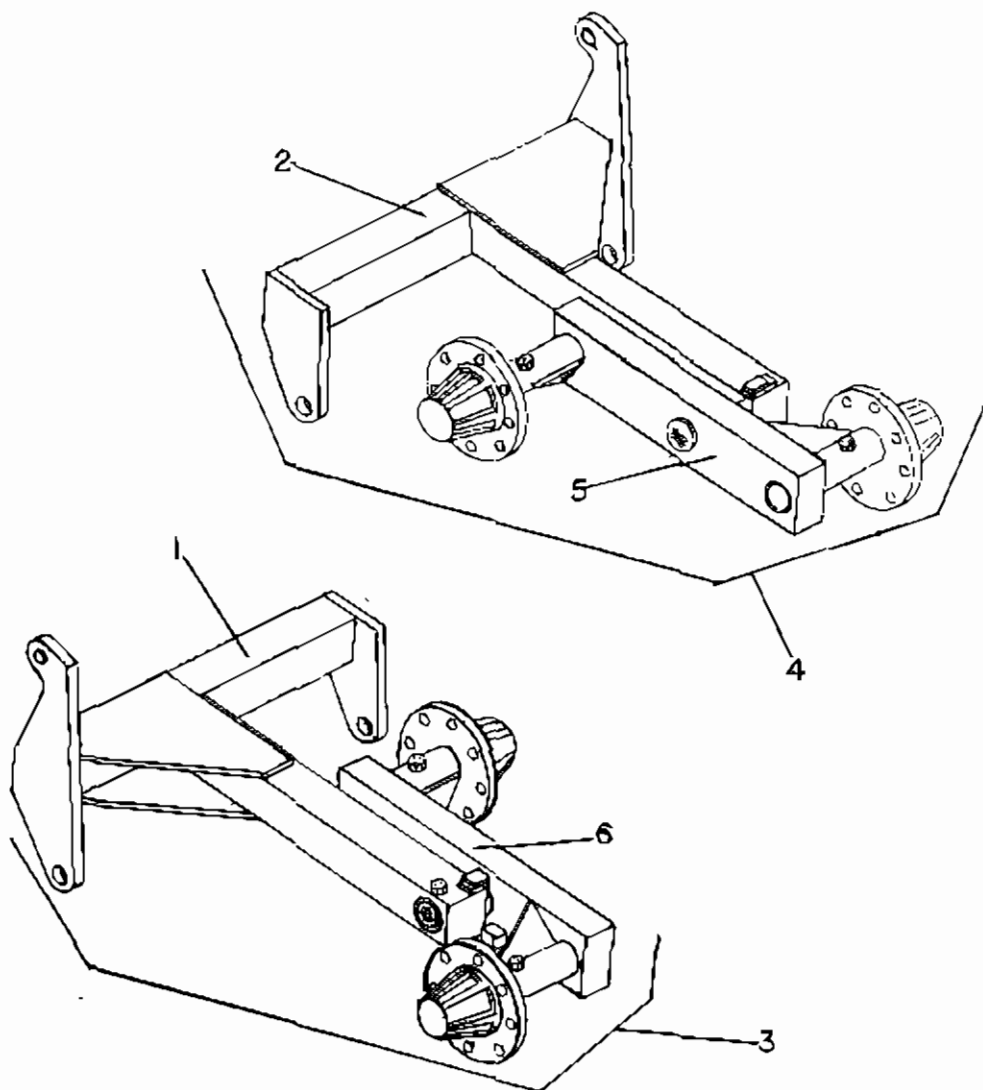

Tandem Wheel Leg Assemblies

Key	Part No.	Description
1	0420-165	Tandem Wheel Leg, LH
2	0420-166	Tandem Wheel Leg, RH
3	0420-410	Tandem Wheel Leg Assembly, LH
4	0420-415	Tandem Wheel Leg Assembly, RH
5	0420-450	Walking Beam Assembly, RH
6	0420-455	Walking Beam Assembly, LH

Wheel leg, Walking beam, Hub & Spindle components

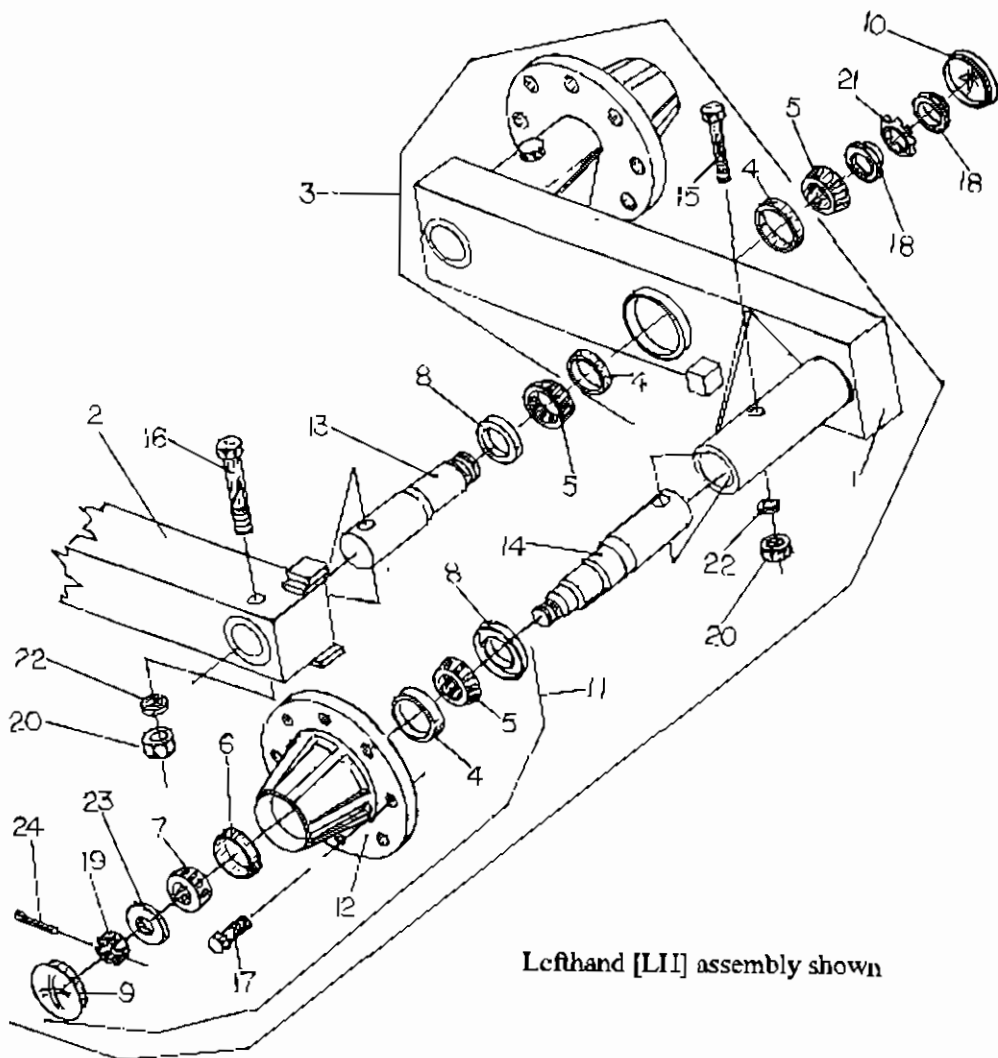

Lefthand [LI] assembly shown

Wheel leg, Walking beam, Hub & Spindle components

Key	Part No.	Description
1	0420-055	Walking beam, RH, with 5419-122 races
	0420-056	Walking beam, LH, with 5419-122 races
2	0420-165	Wheel leg, LH
	0420-166	Wheel leg, RH
3	0420-450	Walking beam assembly, RH
	0420-455	Walking beam assembly, LH
4	5419-122	Race
5	5419-152	Bearing
6	5419-153	Race
7	5419-154	Bearing
8	5439-151	Seal
9	5469-013	Dust cap
10	5469-020	Dust cap
11	5619-025	8 Bolt hub assembly
12	5619-026	8 Bolt hub
13	6628-016	Spindle, wheel leg
14	6628-017	Spindle, walking beam
15	7114-040	Cap screw, 5/8" NC x 4"
16	7114-050	Cap screw, 5/8" NC x 5"
17	7333-009	Lug bolt, 9/16" x 1 1/4"
18	7707-001	Lock nut, N-08
19	7715-875	Slotted nut
20	7724-005	Hex nut, 5/8" NC
21	7807-001	Ear washer, W-08
22	7814-020	Lock washer, 5/8"
23	7815-025	Flat washer, 7/8"
24	7910-162	Cotter pin, 5/32" x 1 1/2"

Adjustable linkage assembly, Cylinder lock & Depth stops

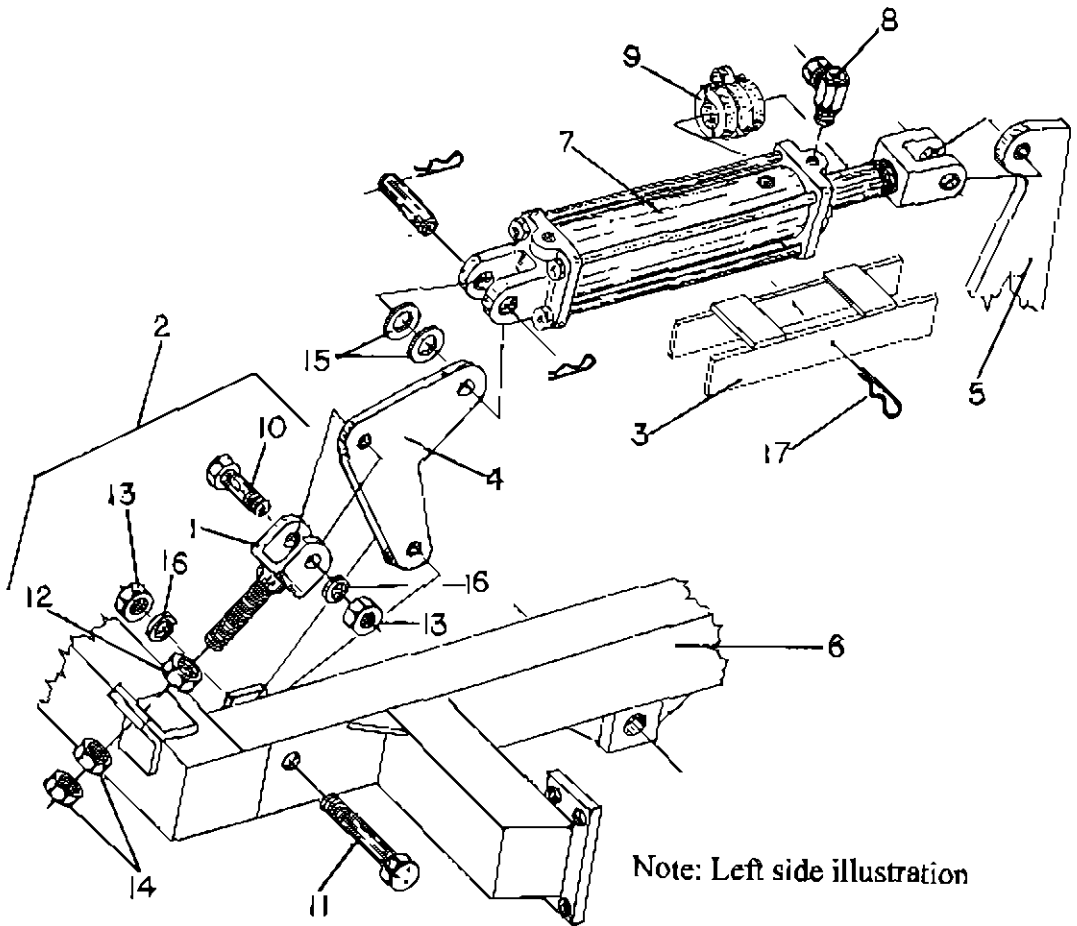

Adjustable linkage assembly, Cylinder lock & Depth stops

Key	Part No.	Description
1	0410-121	Adjustable link
2	0410-581	Adjustable linkage assembly
3	0420-101	Cylinder lock
4	0420-295	Pivot arm
5	0420-410	Wheel leg assembly, LH
6	0425-001	Center frame module
7	5819-064	Hydraulic cylinder, 3-3/4 x 12 Rephase, right side
	5819-065	Hydraulic cylinder, 4 x 12 Rephase, left side
8	5846-095	1/2" O-Ring, 90 degree swivel union
9	6899-402	Depth stop kit, 5 sizes 1" thru 2"
	6896-100	Depth stop, White 1"
	6896-125	Depth stop, Green 1 1/4"
	6896-150	Depth stop, Blue 1 1/2"
	6896-175	Depth stop, Red 1 3/4"
	6896-200	Depth stop, Yellow 2"
10	7115-025	Cap screw, 3/4"NC x 2 1/2"
11	7115-075	Cap screw, 3/4"NC x 5 1/2"
12	7715-871	Hex nut, 7/8"NC
13	7725-002	Hex nut, 3/4"NC
14	7725-138	Hex jam nut, 7/8"NC
15	7816-020	Flat washer, 1"
16	7845-020	Lock washer, 3/4"
17	7920-002	Hitch pin, #8 cylinder lock

Front mount arm, Front hinge mount & Hydraulic cylinder

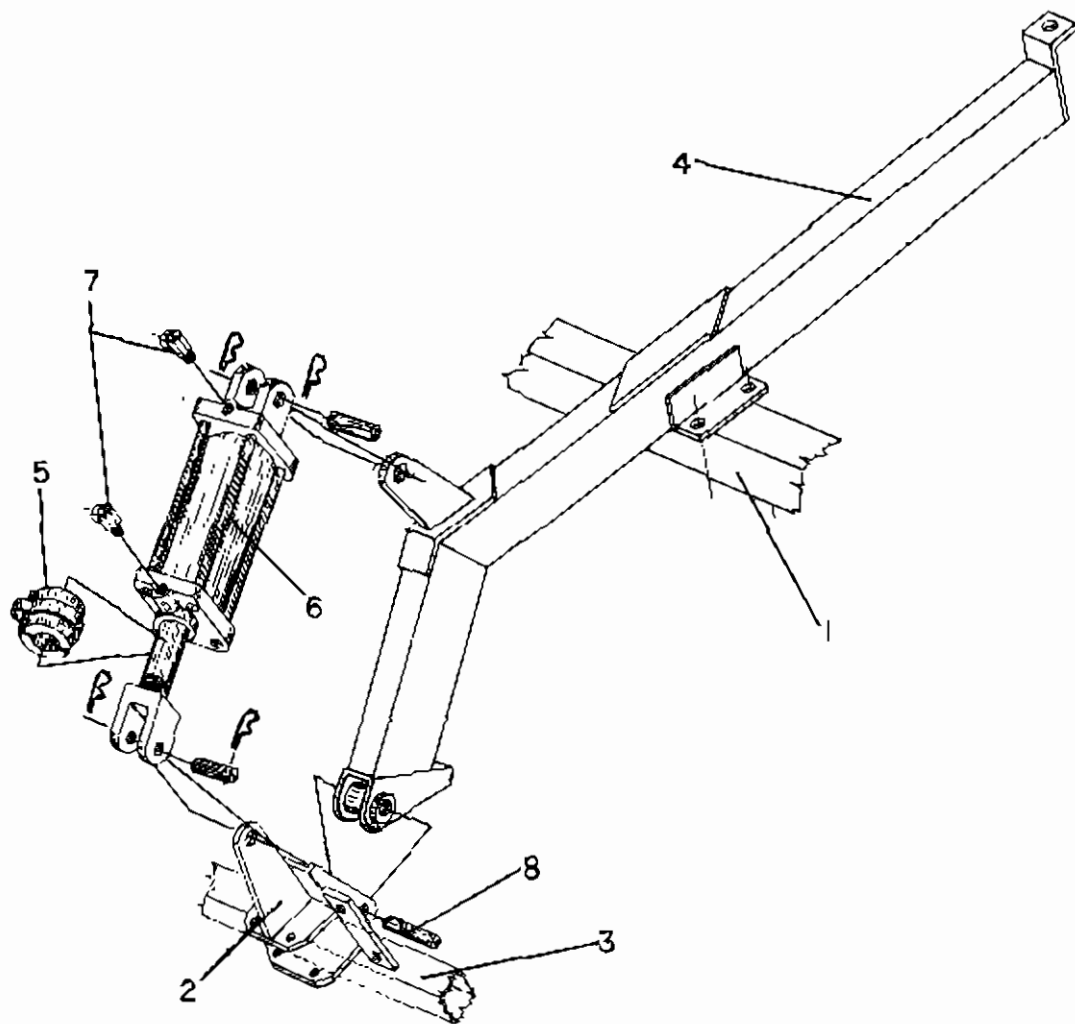

Front mount arm, Front hinge mount & Hydraulic cylinder

Key	Part No.	Description
1	0425-001	Center frame module
2	0425-002	Front hinge mount
3	0425-032	Cross tongue, 13 ft. and 15 ft.
	0425-033	Cross tongue, 17 ft. and 20 ft.
4	0425-045	Front mount arm
5	0425-502	Depth stop kit, large, 5 sizes 1" thru 2"
	6897-100	Depth stop, white 1"
	6897-125	Depth stop, green 1 1/4"
	6897-150	Depth stop, blue 1 1/2"
	6897-175	Depth stop, red 1 3/4"
	6897-200	Depth stop, yellow 2"
6	5818-625	Hydraulic cylinder, 4 x 8 SAE
7	5846-095	1/2 90 degree O-Ring swivel union
8	8036-022	Hinge pin, 1 1/4" x 7"

Hydraulics layout

Note

Clamp Key number items 1 & 3 around longic (using item)
4 [hose clamps] to secure item 2 [check valve assembly] to
Key number 1

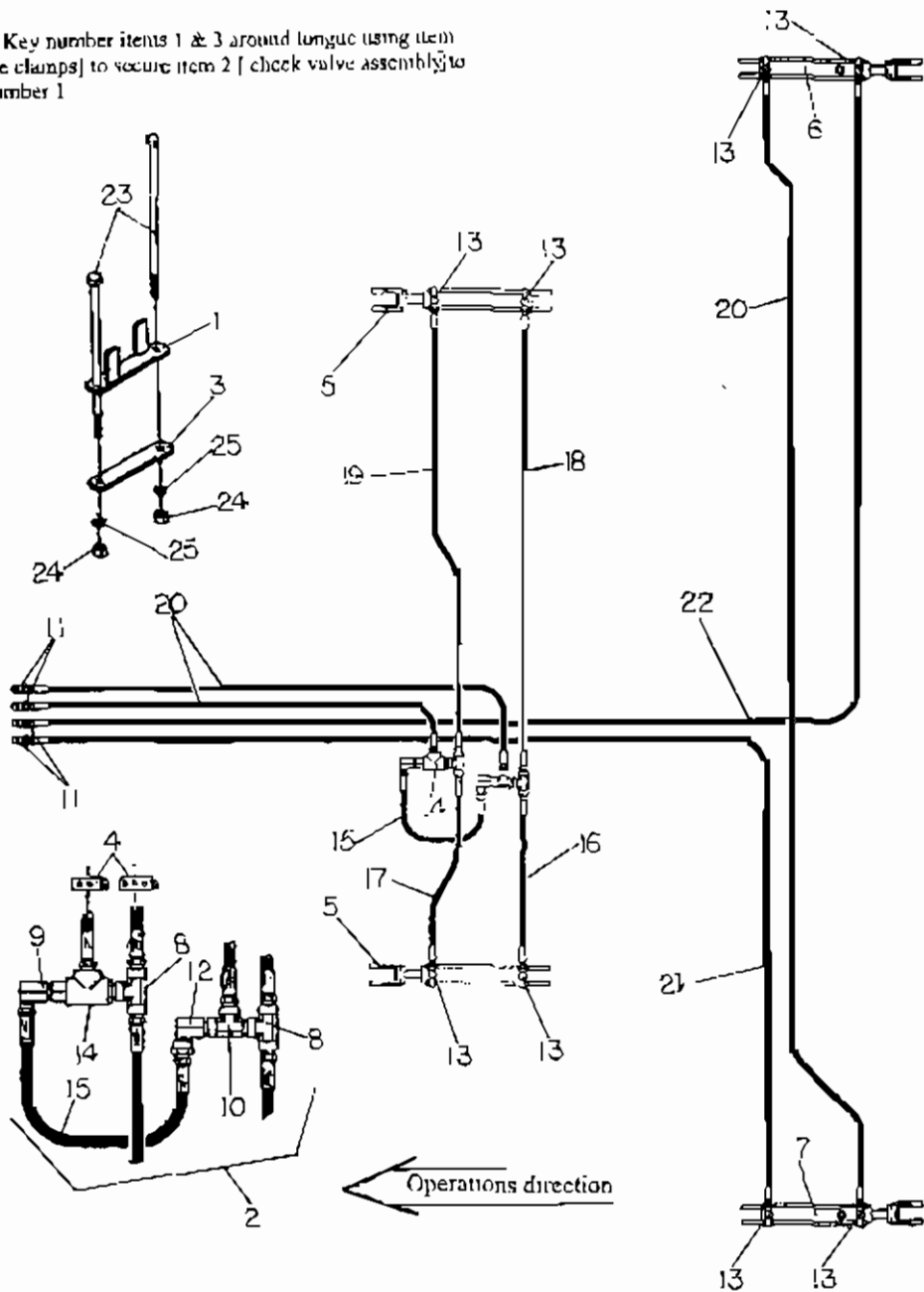

Hydraulics layout

Key	Part no.	Description
1	0425-052	Hydraulics bracket
2	0425-312	Pilot operated check valve assembly
3	0950-297	Backing plate
4	5226-200	Hose clamp, 3/4" to 1 1/2"
5	5818-625	Hydraulic cylinder, 4 x 8 SAE
6	5819-064	Hydraulic cylinder, 3-3/4 x 12 Rephasing
7	5819-065	Hydraulic cylinder, 4 x 12 Rephasing
8	5833-101	1/2" Tee
9	5842-650	3/8" 90 degree swivel union 1/4
10	5843-214	1/2" Male run tee
11	5843-235	1/2" Male quick coupler
12	5843-460	1/2" 90 degree swivel union
13	5846-095	1/2" 90 degree O-Ring swivel union
14	5859-410	1/2" pilot operated valve
15	6822-211	Hose, 3/8 x 11-3/8
16	6822-226	Hose, 3/8 x 26
17	6822-234	Hose, 3/8 x 34
18	6822-266	Hose, 3/8 x 66
19	6822-272	Hose, 3/8 x 72
20	6822-356	Hose, 3/8 x 156
21	6822-440	Hose, 3/8 x 240 [20'-0"]
22	6822-478	Hose, 3/8 x 288 [24'-0"]
23	7112-110	Cap screw, 3/8"NC x 10"
24	7722-010	Hex nut, 3/8"NC
25	7842-010	Lock washer, 3/8"

Front mount arm, Cross tongue and Spring tower assembly

Key	Part No.	Description
1	0206-031	Clamp plate
2	0216-021	Backing plate
3	0425-002	Front hinge mount
4	0425-032	Cross tongue, 13 ft. and 15 ft.
	0425-033	Cross tongue, 17 ft. and 20 ft.
5	0425-045	Front arm mount
6	0425-058	Single coultter gang, frame
	0425-059	Dual coultter gang, frame
7	0425-561	Spring tower assembly
8	7021-010	Roll pin, 7/32" x 2"
9	7022-005	Roll pin, 3/8" x 2"
10	7113-135	Cap screw, 1/2" NC x 6"
11	7114-060	Cap screw, 5/8" NC x 6"
12	7115-069	Cap screw, 3/4" NC x 6", gr. 8
13	7115-080	Cap screw, 3/4" NC x 8"
14	7116-025	Cap screw, 1" NC x 2 1/2"
15	7723-015	Hex nut, 1/2" NC
16	7724-005	Hex nut, 5/8" NC
17	7725-002	Hex nut, 3/4" NC
18	7726-005	Hex nut, 1" NC
19	7843-015	Lock washer, 1/2"
20	7844-020	Lock washer, 5/8"
21	7845-020	Lock washer, 3/4"
22	7846-020	Lock washer, 1"
23	8036-022	Hinge pin, 1 1/4" x 7"

Note: Prior to 2/97

Key	Part No.	Description
6	0425-011	Dual coultter gang, frame
	0425-012	Single coultter gang, frame
7	0425-450	Spring tower assembly

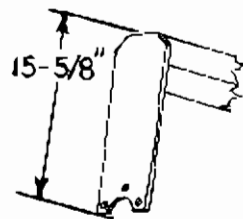

Spring tower assembly

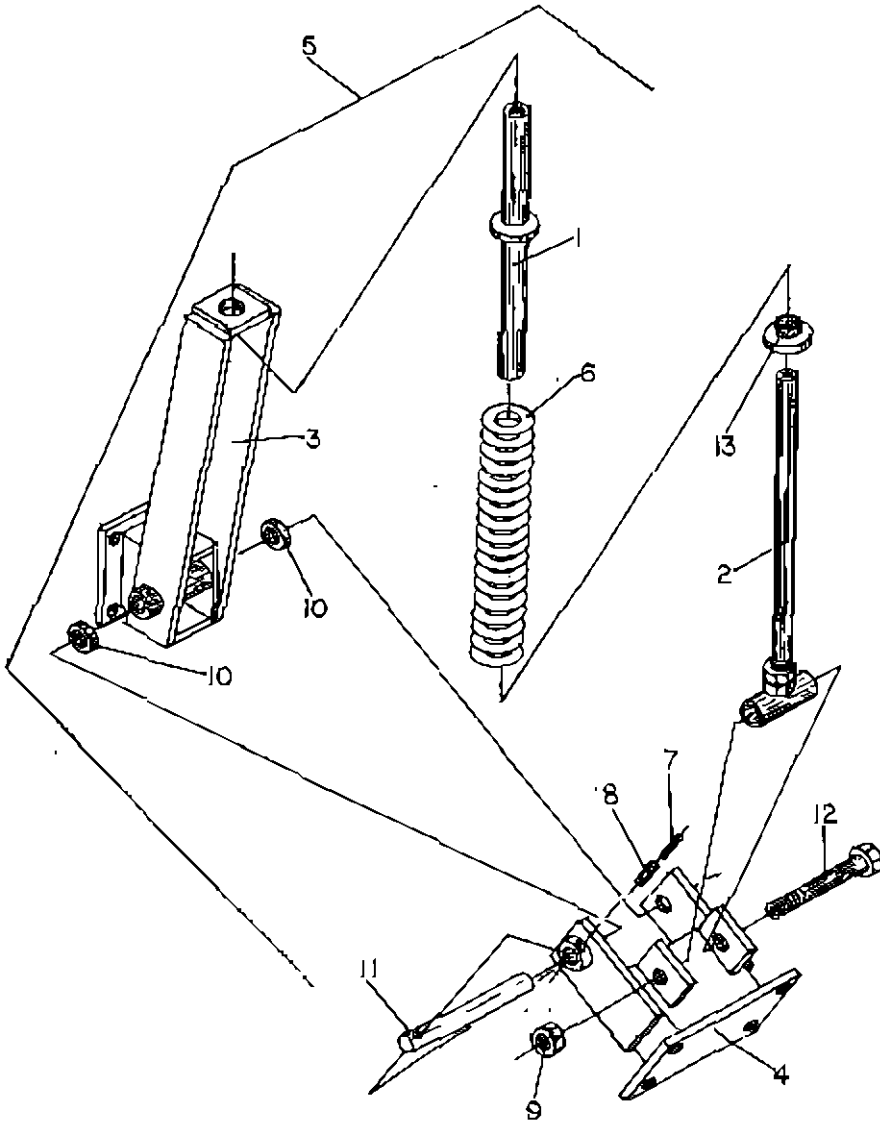

Spring tower assembly

Key	Part No.	Description
1	0425-009	Spring rod support tube
2	0425-010	Spring rod
3	0425-051	Spring tower , coultter mount
4	0425-055	7" gang mount
5	0425-561	Spring tower assembly
6	5114-001	Spring
7	7021-010	Roll pin, 7/32" x 2"
8	7022-005	Roll pin, 3/8" x 2"
9	7726-012	Lock nut, 1" NC . Nylock
10	7896-001	Machine bushing. 1" x 10 ga NR
11	8026-034	Pin, 1" x 8-9/16", with zerk
12	8116-003	Bolt, 1" NC x 6 1/4" , W/ Nylock nut- 7726-012
13	8816-001	Spring retainer washer

Note: Prior to 2/97

Key	Part No.	Description
4	0425-006	10" Gang mount
5	0425-450	Spring tower assembly

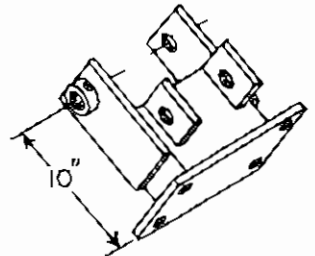

2 Blade Coultter Assembly

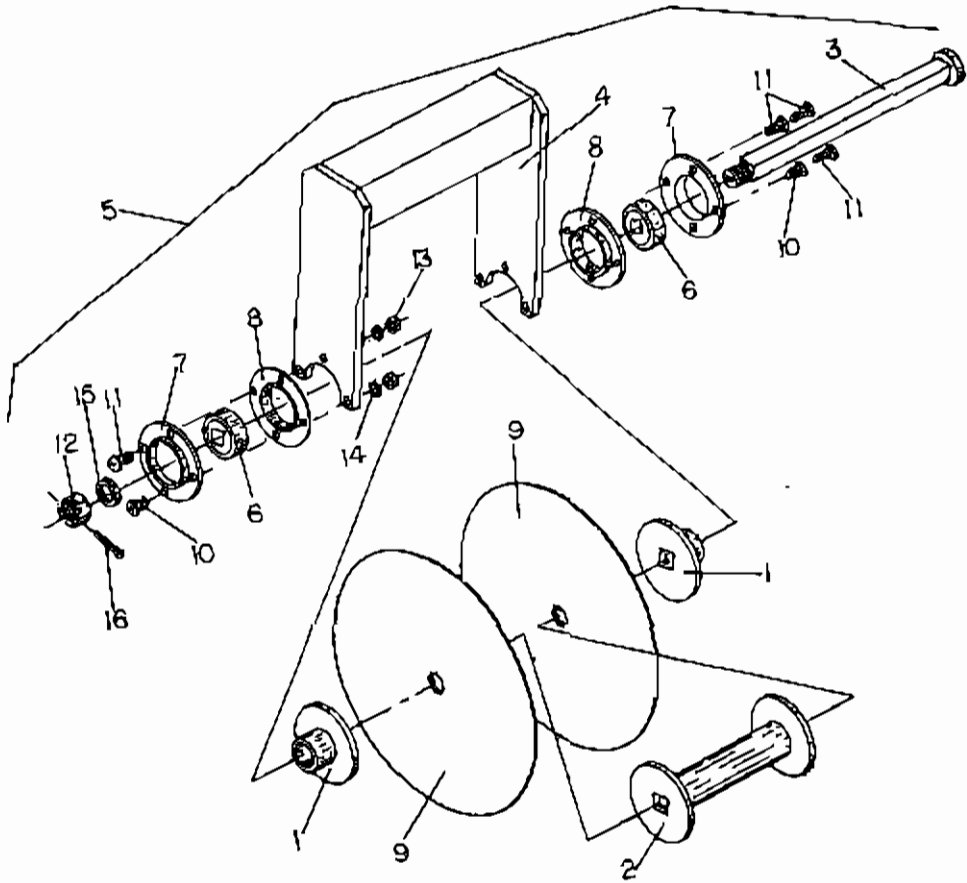

2 Blade coulter assembly

Key	Part No.	Description
1	0425-018	Coulter spacer, 2-3/16"
2	0425-021	Coulter spacer, 12"
3	0425-034	Coulter shaft, 20-3/8"
4	0425-058	Single coulter gang, frame
5	0425-558	2 Blade coulter assembly
6	5449-031	Bearing, DS209-TTR5
7	5499-010	Bearing flange, with zerk
8	5499-011	Bearing flange
9	5939-005	Coulter blade
10	7343-000	Carriage bolt, 1/2"NC x 1"
11	7343-001	Carriage bolt, 1/2"NC x 1 1/2"
12	7717-240	Slotted nut, 1 1/4"NF
13	7723-015	Hex nut, 1/2"NC
14	7843-015	Lock washer, 1/2"
15	7896-250	Machine bushing, 1 1/4" x 10 ga. NR
16	7910-180	Cotter pin, 3/16" x 2"

Note: Prior to 2/97

Key	Part No.	Description
4	0425-012	Single coulter gang, frame
5	0425-482	2 Blade coulter assembly

3 Blade Coulter Assembly

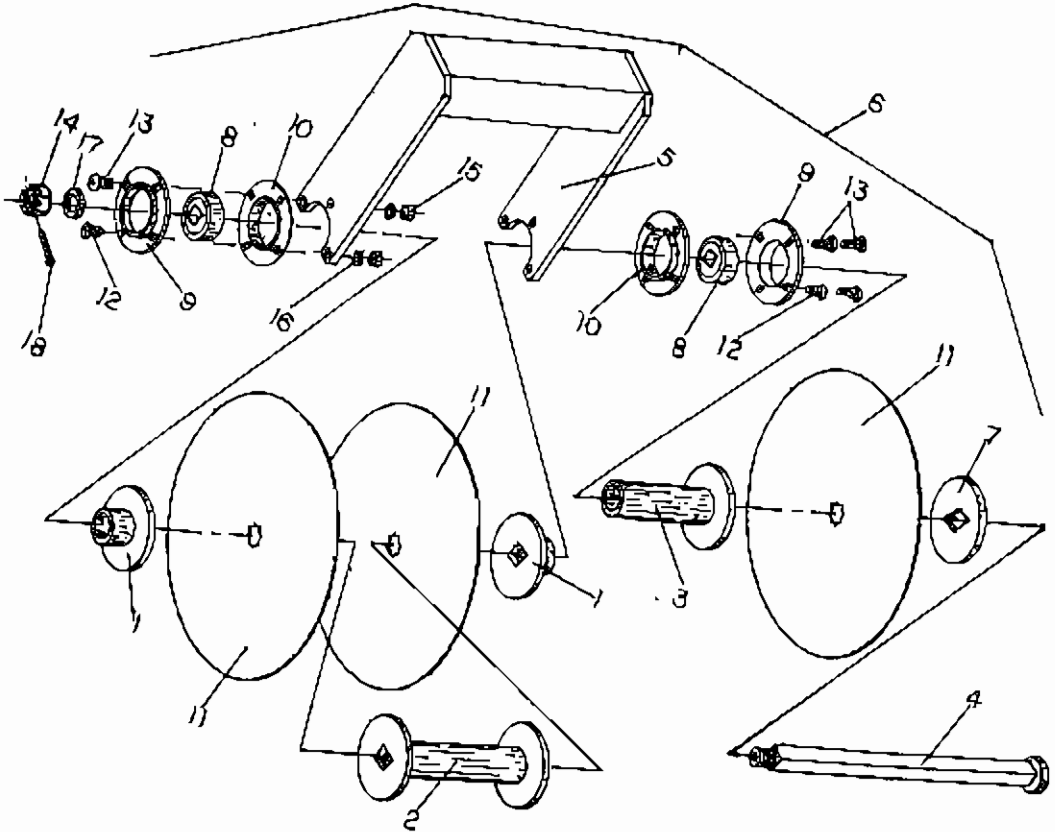

3 Blade coultter assembly

Key	Part No.	Description
1	0425-018	Coultter spacer, 2-3/16"
2	0425-021	Coultter spacer, 12"
3	0425-046	Coultter spacer, 8-3/16"
4	0425-047	Coultter shaft, 29-1/8"
5	0425-058	Single coultter gang, frame
6	0425-559	3 Blade coultter assembly
7	0425-955	Coultter washer
8	5449-031	Bearing, DS209-TTR5
9	5499-010	Bearing flange, with zerk
10	5499-011	Bearing flange
11	5939-005	Coultter blade
12	7343-000	Carriage bolt, 1/2"NC x 1"
13	7343-001	Carriage bolt, 1/2"NC x 1 1/2"
14	7717-240	Slotted nut, 1 1/4"NF
15	7723-015	Hex nut, 1/2"NC
16	7843-015	Lock washer, 1/2"
17	7896-250	Machine bushing, 1 1/4"x 10 ga. NR
18	7910-180	Cotter pin, 3/16" x 2"

Note: Prior to 2/97

Key	Part No.	Description
5	0425-012	Single coultter gang, frame
6	0425-495	3 Blade coultter assembly

5 Blade Coulter Assembly

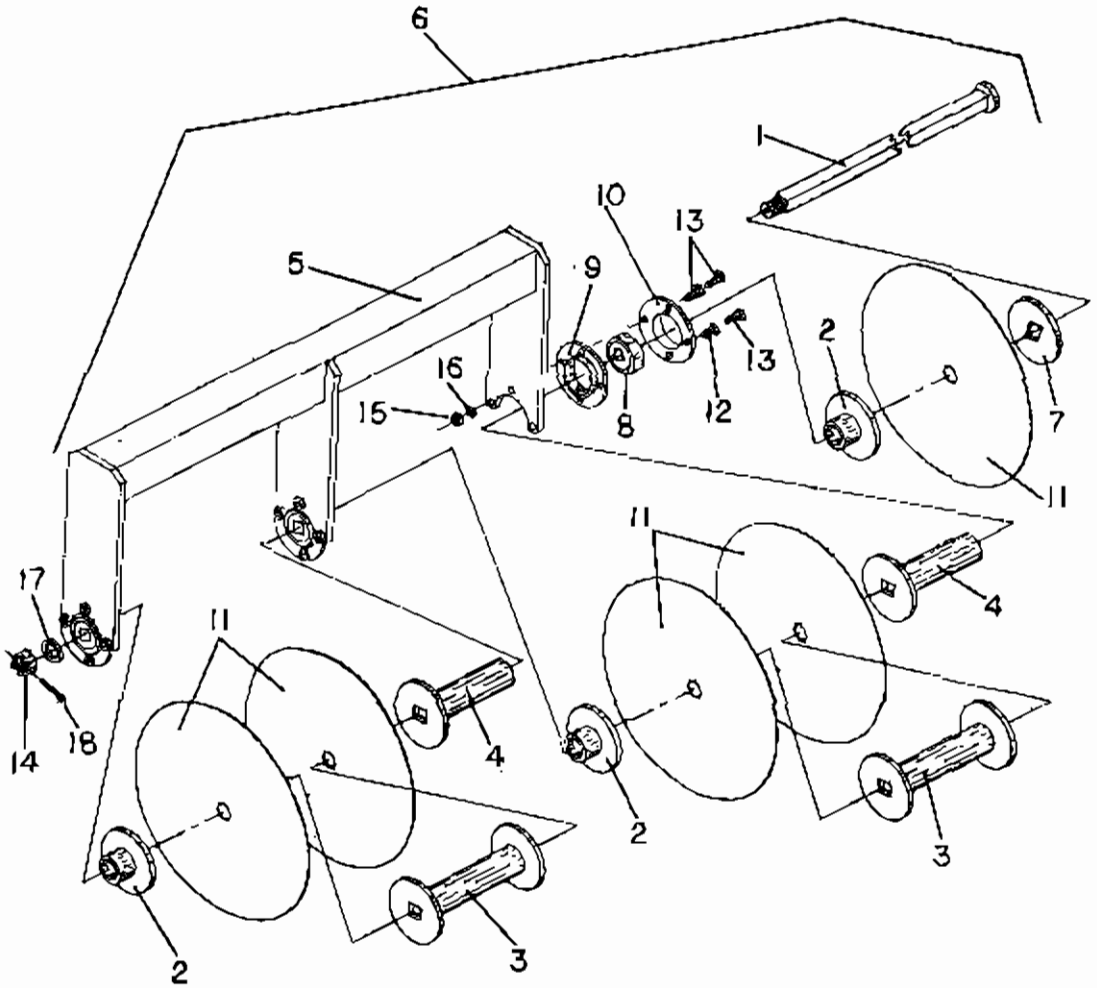

5 Blade coultter assembly

Key	Part No.	Description
1	0425-017	Coultter shaft, 53-1/8"
2	0425-018	Coultter spacer, 2-3/16"
3	0425-021	Coultter spacer, 12"
4	0425-046	Coultter spacer, 8-3/16"
5	0425-059	Dual coultter gang, frame
6	0425-560	5 Blade coultter assembly
7	0425-955	Coultter washer
8	5449-031	Bearing, DS209-TTR5
9	5499-010	Bearing flange, W/zerk
10	5499-011	Bearing flange
11	5939-005	Coultter blade
12	7343-000	Carriage bolt, 1/2"NC x 1"
13	7343-001	Carriage bolt, 1/2"NC x 1 1/2"
14	7717-240	Slotted nut, 1 1/4"NF
15	7723-015	Hex nut, 1/2"NC
16	7843-015	Lock washer, 1/2"
17	7896-250	Machine bushing, 1 1/4" x 10 ga. NR
18	7910-180	Cotter pin, 3/16" x 2"

Note: Prior to 2/97

Key	Part No.	Description
5	0425-011	Dual coultter gang, frame
6	0425-483	5 Blade coultter assembly

6 Blade Coulter Assembly

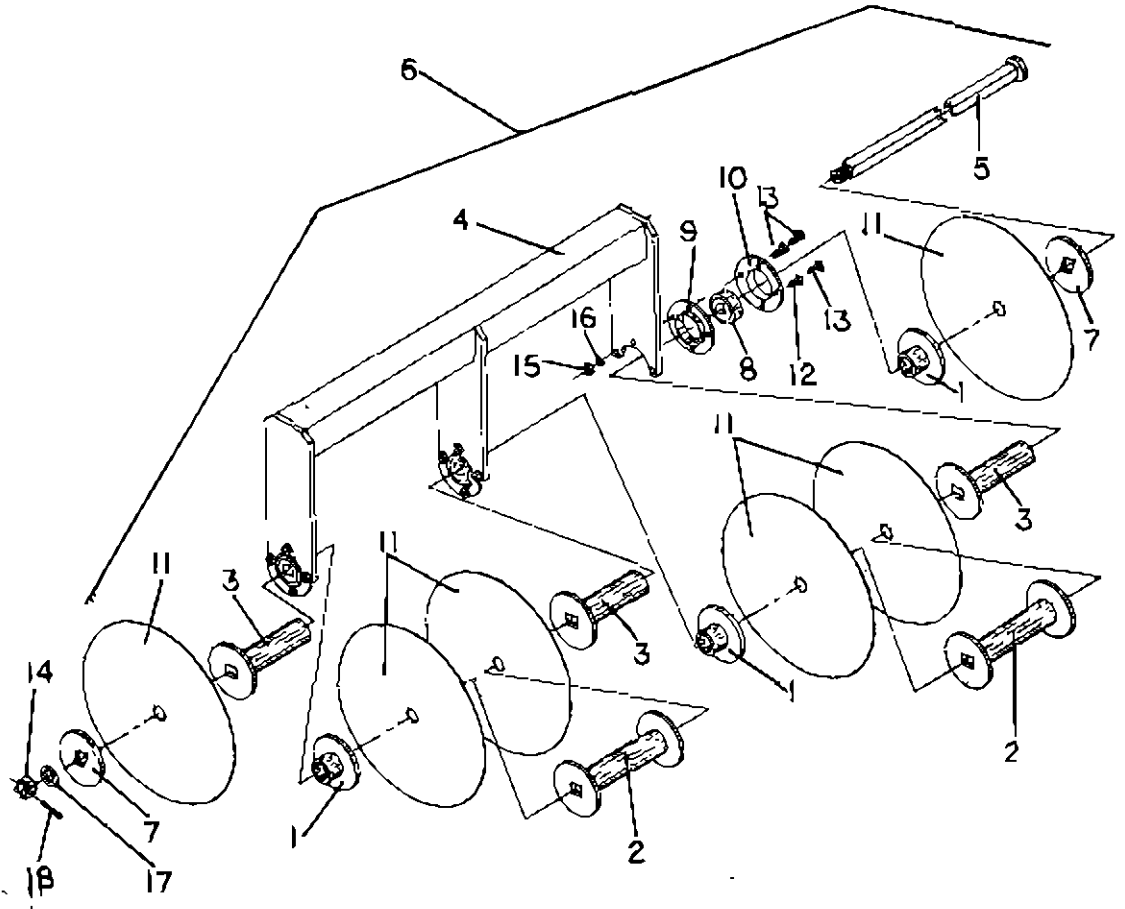

6 Blade coulter assembly

Key	Part No	Description
1	0425-018	Coulter spacer, 2-3/16"
2	0425-021	Coulter spacer, 12"
3	0425-046	Coulter spacer, 8-3/16"
4	0425-059	Dual coulter gang, frame
5	0425-062	Coulter shaft, 62-1/8"
6	0425-562	6 Blade coulter assembly
7	0425-955	Coulter washer
8	5449-031	Bearing, DS209-TTR5
9	5499-010	Bearing flange, W/zerk
10	5499-011	Bearing flange
11	5939-005	Coulter blade
12	7343-000	Carriage bolt, 1/2"NC x 1"
13	7343-001	Carriage bolt, 1/2"NC x 1 1/2"
14	7717-240	Slotted nut, 1 1/4"NF
15	7723-015	Hex nut, 1/2"NC
16	7843-015	Lock washer, 1/2"
17	7896-250	Machine bushing, 1 1/4" x 10 ga NR
18	7910-180	Cotter pin, 3/16" x 2"

Note: Prior to 2/97

Key	Part No.	Description
4	0425-011	Dual coulter gang, frame
6	not avail	6 Blade coulter assembly, only made after 2/97

13 ft. Front Coupler Mounting

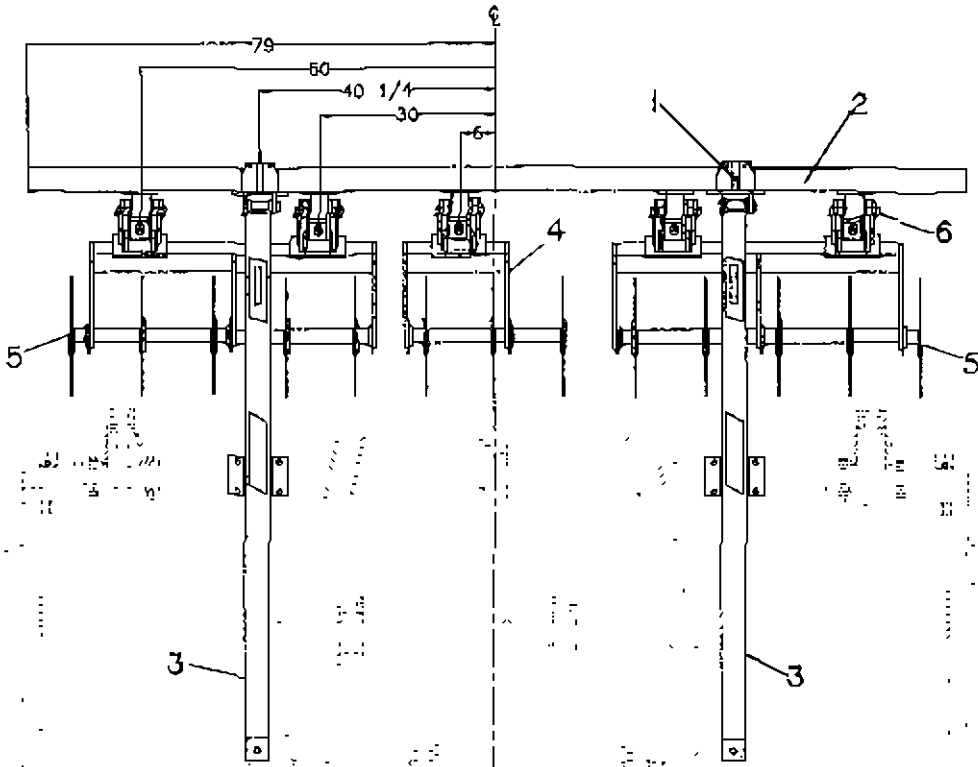

13 ft. Front Coultter Mounting

Key	Part No.	Description
1	0425-002	Front hinge mount
2	0425-032	Cross tongue, 13 ft. and 15 ft.
3	0425-045	Front mount arm
4	0425-559	3 Blade coultter gang assembly
5	0425-560	5 Blade coultter gang assembly
6	0425-561	Spring tower assembly

Note: Prior to 2/97

Key	Part No.	Description
4	0425-495	3 Blade coultter gang assembly
5	0425-483	5 Blade coultter gang assembly
6	0425-450	Spring tower assembly

15 ft. Front Coulters Mounting

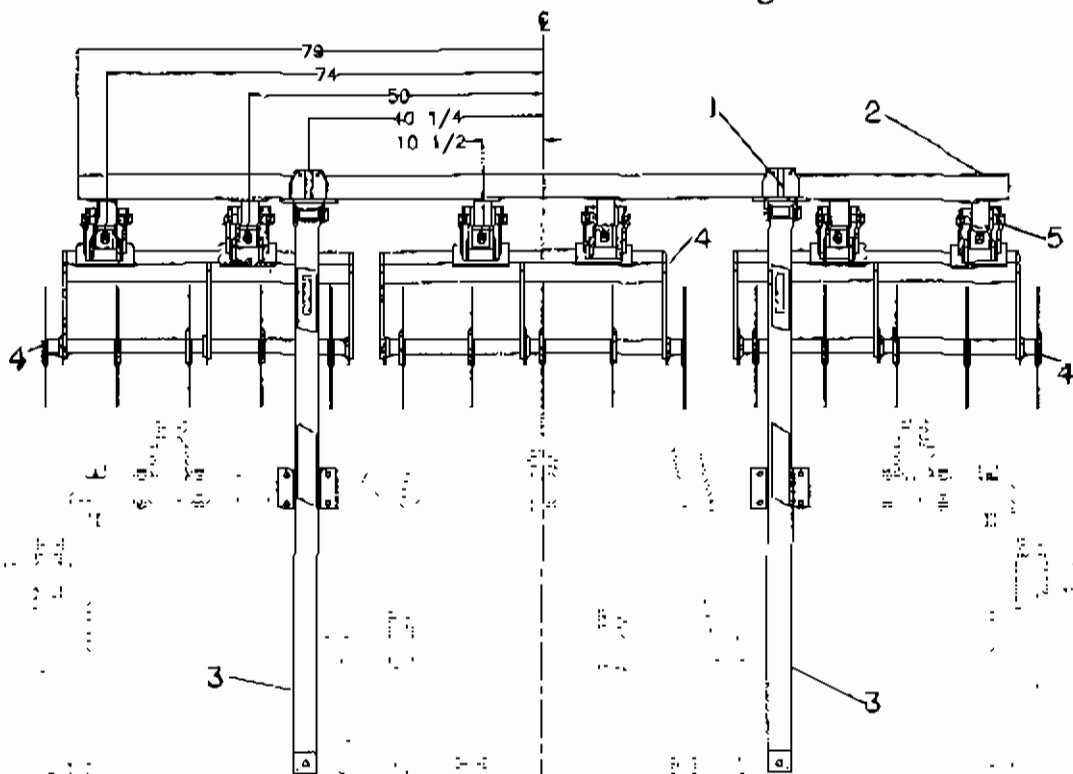

15 ft. Front Coultter Mounting

Key	Part No.	Description
1	0425-002	Front hinge mount
2	0425-032	Cross tongue, 13 ft. and 15 ft.
3	0425-045	Front mount arm
4	0425-560	5 Blade coultter gang assembly
5	0425-561	Spring tower assembly

Note: Prior to 2/97

Key	Part No.	Description
4	0425-483	5 Blade coultter gang assembly
5	0425-450	Spring tower assembly

17 ft. Front Coultter Mounting

Key	Part No.	Description
1	0425-002	Front hinge mount
2	0425-033	Cross tongue, 17 ft. and 20 ft
3	0425-045	Front mount arm
4	0425-558	2 Blade gang assembly
5	0425-560	5 Blade gang assembly
6	0425-561	Spring tower assembly

Note: Prior to 2/97

Key	Part No.	Description
4	0425-482	2 Blade coultter gang assembly
5	0425-483	5 Blade coultter gang assembly
6	0425-450	Spring tower assembly

20 ft. Front Coulters Mounting

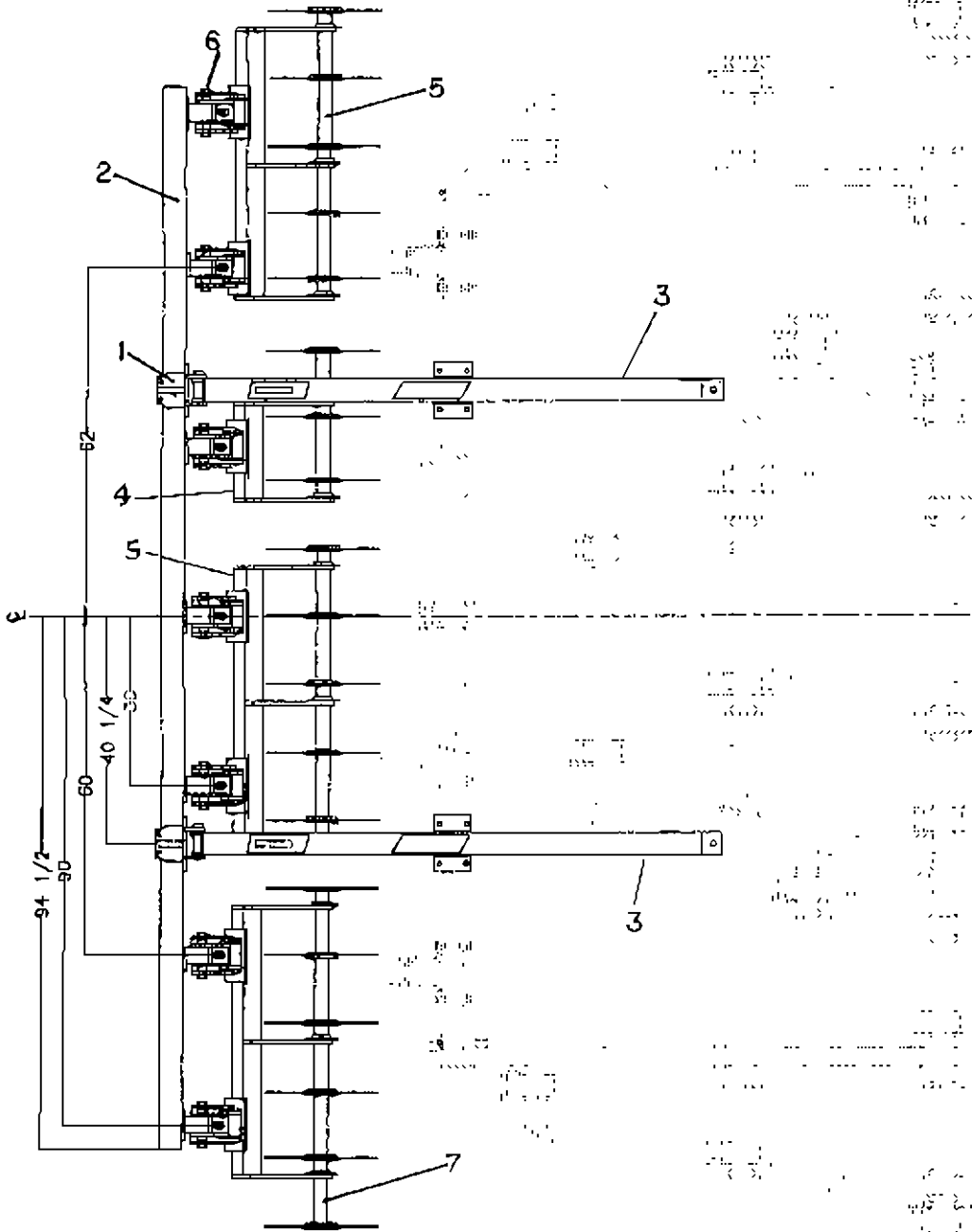

20 ft. Front Coulter Mounting

Key	Part No.	Description
1	0425-002	Front hinge mount
2	0425-033	Cross tongue, 17 ft, and 20 ft
3	0425-045	Front mount arm
4	0425-559	3 Blade coultter assembly
5	0425-560	5 Blade gang assembly
6	0425-561	Spring tower assembly
7	0425-562	6 Blade gang assembly

Note: Prior to 2/97

Key	Part No.	Description
4	0425-495	3 Blade coultter gang assembly
5	0425-483	5 Blade coultter gang assembly
6	0425-450	Spring tower assembly
7	not avail	6 Blade coultter gang assembly, not made prior to 2/97

Forward shank mount

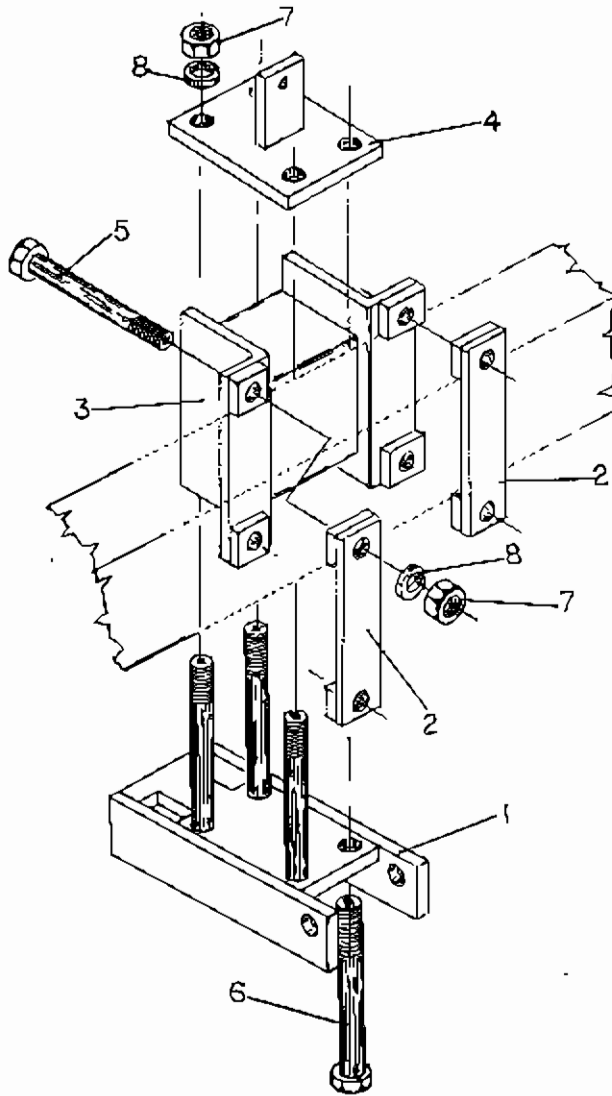

Forward shank mount

Key	Part No.	Description
1	0420-081	Shank mount bracket
2	0420-114	Backing plate
3	0420-118	Forward shank mount
4	0425-030	Cylinder lock holder
5	7115-071	Cap screw, ¼"NC x 6 ½"
6	7115-080	Cap screw, ¼"NC x 8"
7	7725-002	Hex nut, ¼"NC
8	7845-020	Lock washer, ¼"

Chisel plow shank assembly

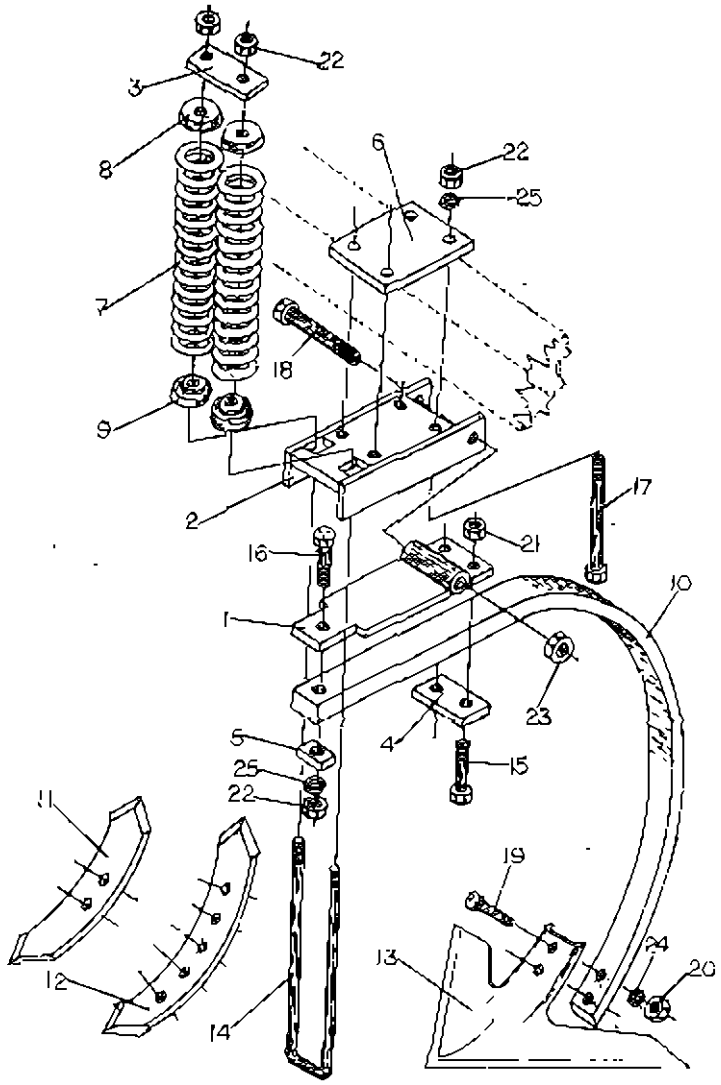

Chisel plow shank assembly

Key	Part No.	Description
	0420-355	32" CHISEL SHANK ASSEMBLY W/O POINT
	NOTE: NOT ALL PARTS ILLUSTRATED ARE INCLUDED IN ASSY	
1.	0420-060	SHANK MOUNT HINGE
2.	0420-081	SHANK MOUNT BRACKET
3	0420-287	SUPPORT PLATE
4.	0420-298	MOUNT PLATE
5	0420-298	SPACER
6	0420-300	MOUNT BACKING PLATE
7.	5113-001	SPRING
8	5919-050	TOP INSERT
9.	5919-051	BOTTOM INSERT
10.	5939-002	32" SHANK
11.	5952-609	POINT, REVERSIBLE BOLT ON
12	5952-812	POINT, TWISTED RH
	5952-813	POINT, TWISTED LH
13.	5952-635	SWEEP, 16"
	5952-641	SWEEP, 18"
14.	6215-001	LH-BOLT, 3/4" w/2-7/16" SPAN
15.	7114-028	CAP SCREW, 5/8" NC X 3-1/4"
16.	7115-030	CAP SCREW, 3/4" NC X 3"
17.	7115-080	CAP SCREW, 3/4" NC X 8"
18.	7115-112	CAP SCREW, 7/8" NC X 7"
19	7273-001	PLOW BOLT, 1/2" NC X 2-1/2"
20	7723-015	HEX NUT, 1/2"
21	7724-120	LOCK NUT, 5/8" NC
22.	7725-002	HEX NUT, 3/4" NC
23.	7725-130	LOCK NUT, 7/8" NC
24.	7843-015	LOCK WASHER, 1/2"
25.	7845-020	LOCK WASHER, 3/4"

Rear support assembly, 51" left hand

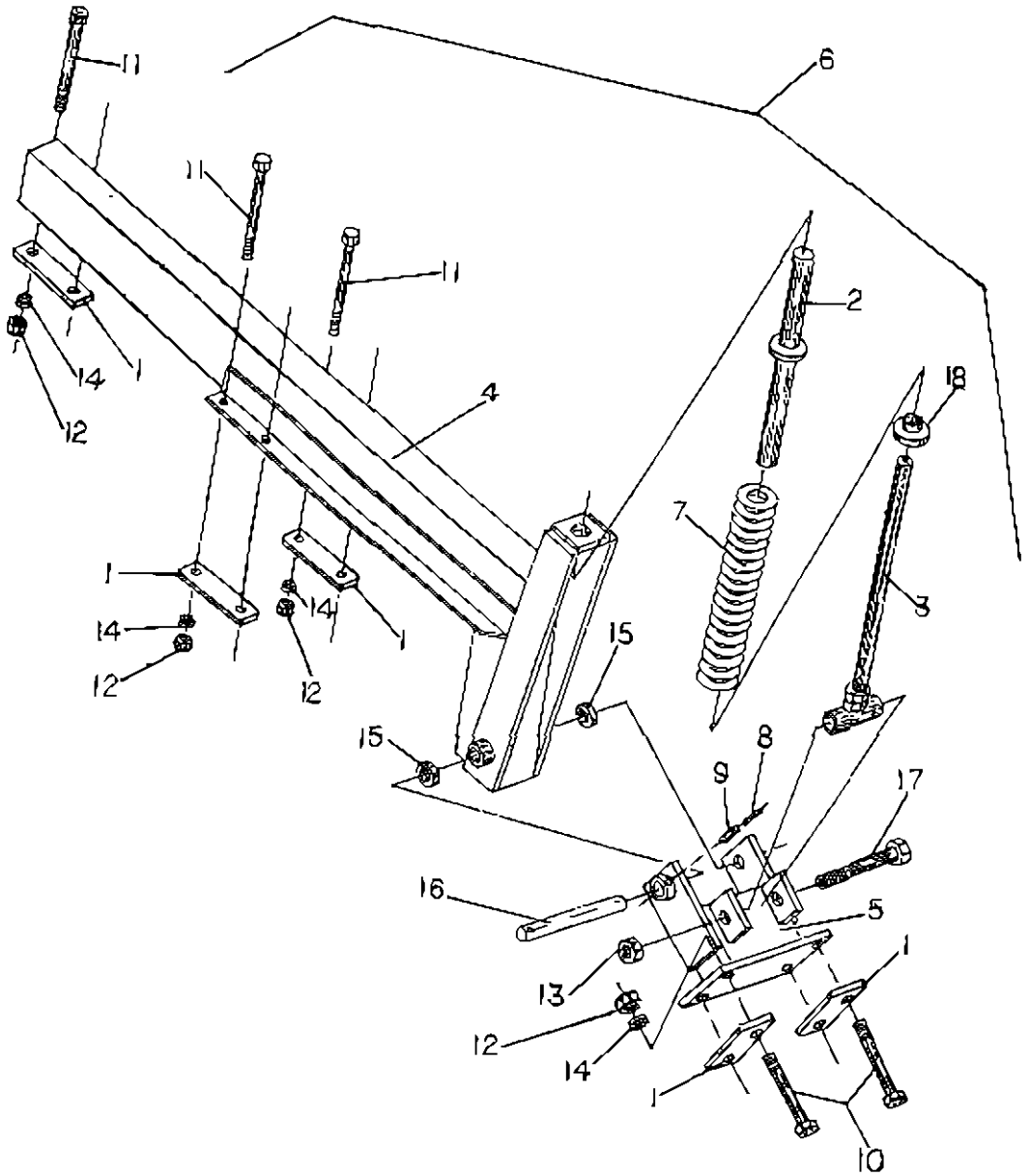

Rear support assembly, 51" left hand

Key	Part No.	Description
1	0216-021	Backing plate
2	0425-009	Spring rod support tube
3	0425-010	Spring rod
4	0425-043	51" Rear support, L.H
5	0425-055	7" Gang mount
6	0425-550	Rear support assembly, 51" L.H
7	5114-001	Spring
8	7021-010	Roll pin, 7/32" x 2"
9	7022-005	Roll pin, 3/8" x 2"
10	7114-060	Cap screw, 5/8"NC x 6"
11	7114-080	Cap screw, 5/8"NC x 8"
12	7724-005	Hex nut, 5/8"NC
13	7726-012	Lock nut, 1"NC
14	7844-020	Lock washer, 5/8"
15	7896-001	Machine bushing, 1" x 10 ga. NR
16	8026-034	Pin, 1" x 8-9/16"
17	8116-003	Bolt, 1"NC x 6 1/4"
18	8816-001	Spring retainer washer

Note: Prior to 2/97

Key	Part No.	Description
5	0425-006	Gang mount, 10"
6	0425-480	Rear support assembly, 51" LH

Rear support assembly, 51" right hand

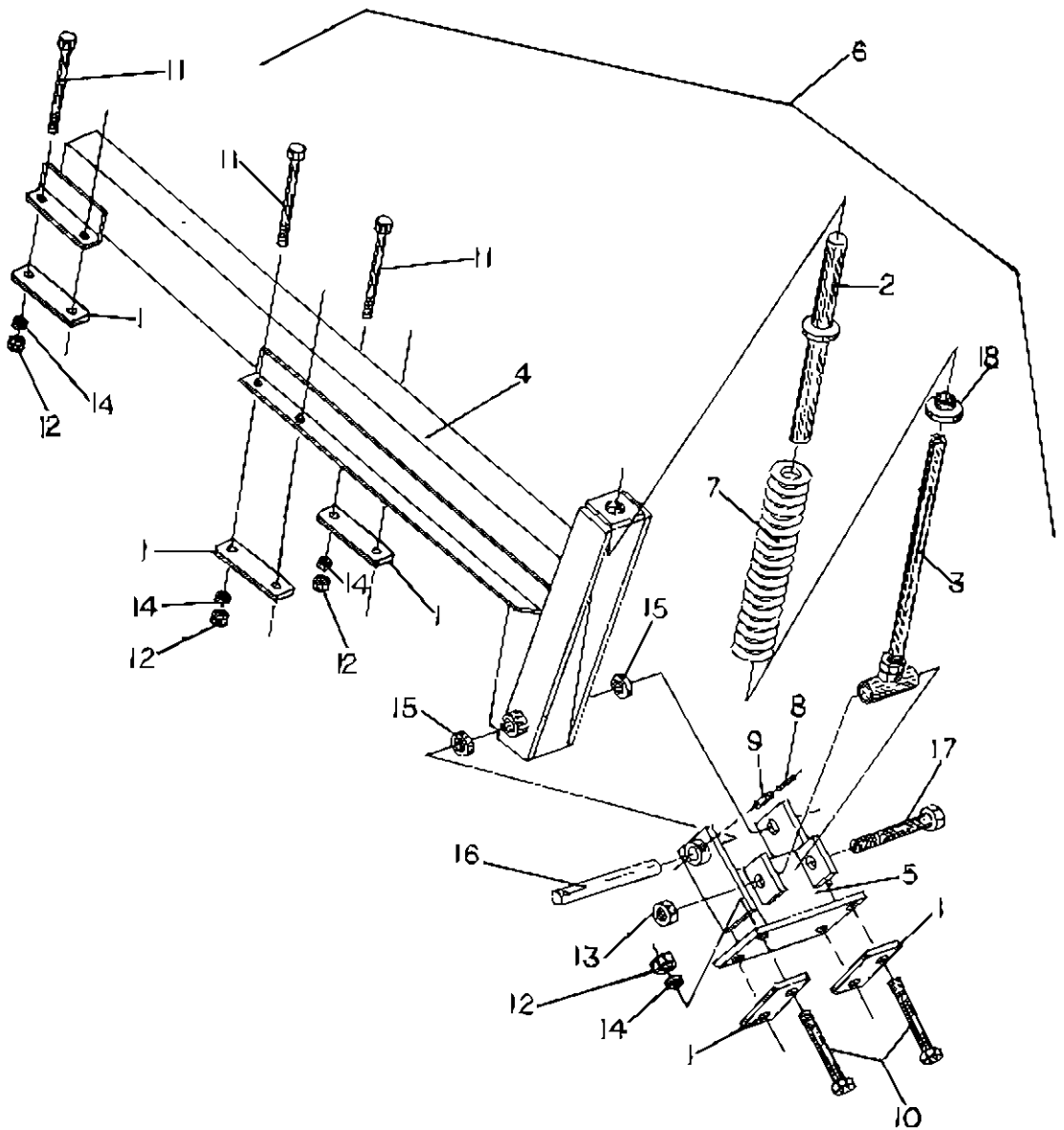

Rear support assembly, 51" right hand

Key	Part No.	Description
1	0216-021	Backing plate
2	0425-009	Spring rod support tube
3	0425-010	Spring rod
4	0425-044	51" Rear support, RH
5	0425-055	7" Gang mount
6	0425-551	Rear support assembly, 51" RH
7	5114-001	Spring
8	7021-010	Roll pin, 7/32" x 2"
9	7022-005	Roll pin, 3/8" x 2"
10	7114-060	Cap screw, 5/8"NC x 6"
11	7114-080	Cap screw, 5/8"NC x 8"
12	7724-005	Hex nut, 5/8"NC
13	7726-012	Lock nut, 1"NC
14	7844-020	Lock washer, 5/8"
15	7896-001	Machine bushing, 1" x 10 ga. NR
16	8026-034	Pin, 1" x 8-9/16"
17	8116-003	Bolt, 1"NC x 6 1/4"
18	8816-001	Spring retainer washer

Note: Prior to 2/97

Key	Part No.	Description
5	0425-006	Gang mount, 10"
6	0425-479	Rear support assembly, 51" RH

Rear support assembly, 68" left hand

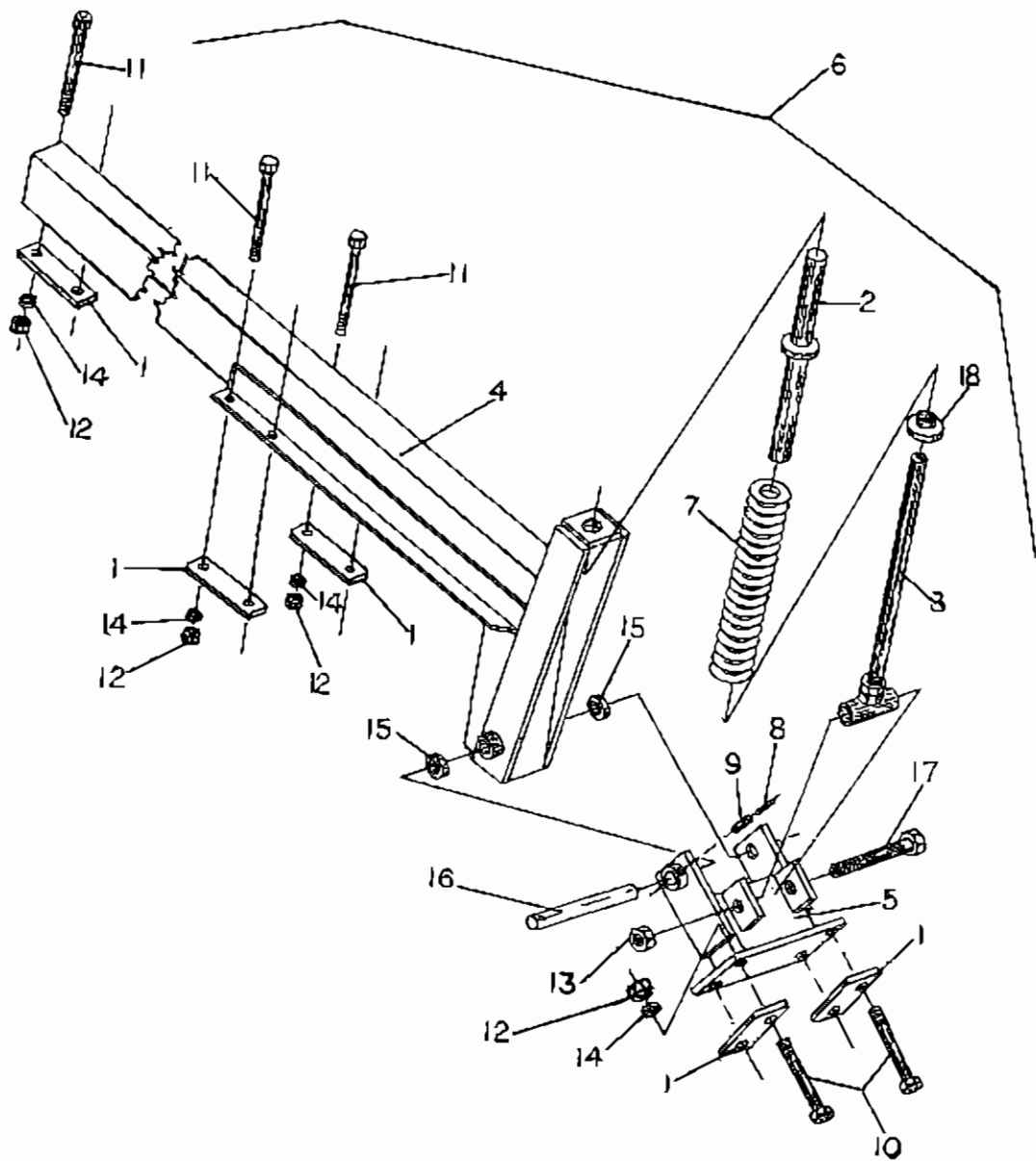

Rear support assembly, 68" left hand

Key	Part No.	Description
1	0216-021	Backing plate
2	0425-009	Spring rod support tube
3	0425-010	Spring rod
4	0425-037	68" Rear support, LH
5	0425-055	7" Gang mount
6	0425-552	Rear support assembly, 68" LH
7	5114-001	Spring
8	7021-010	Roll pin, 7/32" x 2"
9	7022-005	Roll pin, 3/8" x 2"
10	7114-060	Cap screw, 5/8"NC x 6"
11	7114-080	Cap screw, 5/8"NC x 8"
12	7724-005	Hex nut, 5/8"NC
13	7726-012	Lock nut, 1"NC
14	7844-020	Lock washer, 5/8"
15	7896-001	Machine bushing, 1" x 10 ga. NR
16	8026-034	Pin, 1" x 8-9/16"
17	8116-003	Bolt, 1"NC x 6 1/4"
18	8816-001	Spring retainer washer

Note: Prior to 2/97

Key	Part No.	Description
5	0425-006	Gang mount, 10"
6	0425-491	Rear support assembly, 68" LH

Rear support assembly, 68" right hand

Key	Part No.	Description
1	0216-021	Backing plate
2	0425-009	Spring rod support tube
3	0425-010	Spring rod
4	0425-038	68" Rear support, RH
5	0425-055	7" Gang mount
6	0425-553	Rear support assembly, 68" RH
7	5114-001	Spring
8	7021-010	Roll pin, 7/32" x 2"
9	7022-005	Roll pin, 3/8" x 2"
10	7114-060	Cap screw, 5/8"NC x 6"
11	7114-080	Cap screw, 5/8"NC x 8"
12	7724-005	Hex nut, 5/8"NC
13	7726-012	Lock nut, 1"NC
14	7844-020	Lock washer, 5/8"
15	7896-001	Machine bushing, 1" x 10 ga. NR
16	8026-034	Pin, 1" x 8-9/16"
17	8116-003	Bolt, 1"NC x 6 1/4"
18	8816-001	Spring retainer washer

Note: Prior to 2/97

Key	Part No.	Description
5	0425-006	Gang mount, 10"
6	0425-496	Rear support assembly, 68" RH

Rear support assembly, 72"

Key	Part No.	Description
1	0216-021	Backing plate
2	0425-009	Spring support tube
3	0425-010	Spring rod
4	0425-040	72" Rear support
5	0425-055	7" Gang mount
6	0425-201	Backing plate
7	0425-554	72" Rear support assembly
8	5114-001	Spring
9	7021-010	Roll pin, 7/32" x 2"
10	7022-005	Roll pin, 3/8" x 2"
11	7114-060	Cap screw, 5/8"NC x 6"
12	7724-005	Hex nut, 5/8"NC
13	7725-002	Hex nut, 3/4"NC
14	7726-012	Lock nut, 1"NC
15	7844-020	Lock washer, 5/8"
16	7845-020	Lock washer, 1/4"
17	7896-001	Machine bushing, 1" x 10 ga. NR
18	8026-034	Pin, 1" x 8-9/16"
19	8115-014	Bolt, 3/4"NC x 13-7/8"
20	8116-003	Bolt, 1"NC x 6 1/4"
21	8816-001	Spring retainer washer

Note: Prior to 2/97

Key	Part No.	Description
5	0425-006	Gang mount, 10"
7	0425-492	Rear support assembly, 72"

Rear support assembly, 93"

Key	Part No.	Description
1	0216-021	Backing plate
2	0425-009	Spring rod support tube
3	0425-010	Spring rod
4	0425-039	93" Rear support
5	0425-055	7" Gang mount
6	0425-555	Rear support assembly, 93"
7	5114-001	Spring
8	7021-010	Roll pin, 7/32" x 2"
9	7022-005	Roll pin, 3/8" x 2"
10	7114-060	Cap screw, 5/8"NC x 6"
11	7114-080	Cap screw, 5/8"NC x 8"
12	7724-005	Hex nut, 5/8"NC
13	7726-012	Lock nut, 1"NC
14	7844-020	Lock washer, 5/8"
15	7896-001	Machine bushing, 1" x 10 ga. NR
16	8026-034	Pin, 1" x 8-9/16"
17	8116-003	Bolt, 1"NC x 6 1/4"
18	8816-001	Spring retainer washer

Note: Prior to 2/97

Key	Part No.	Description
5	0425-006	Gang mount, 10"
6	0425-497	Rear support assembly, 93"

Single chopper gang assembly

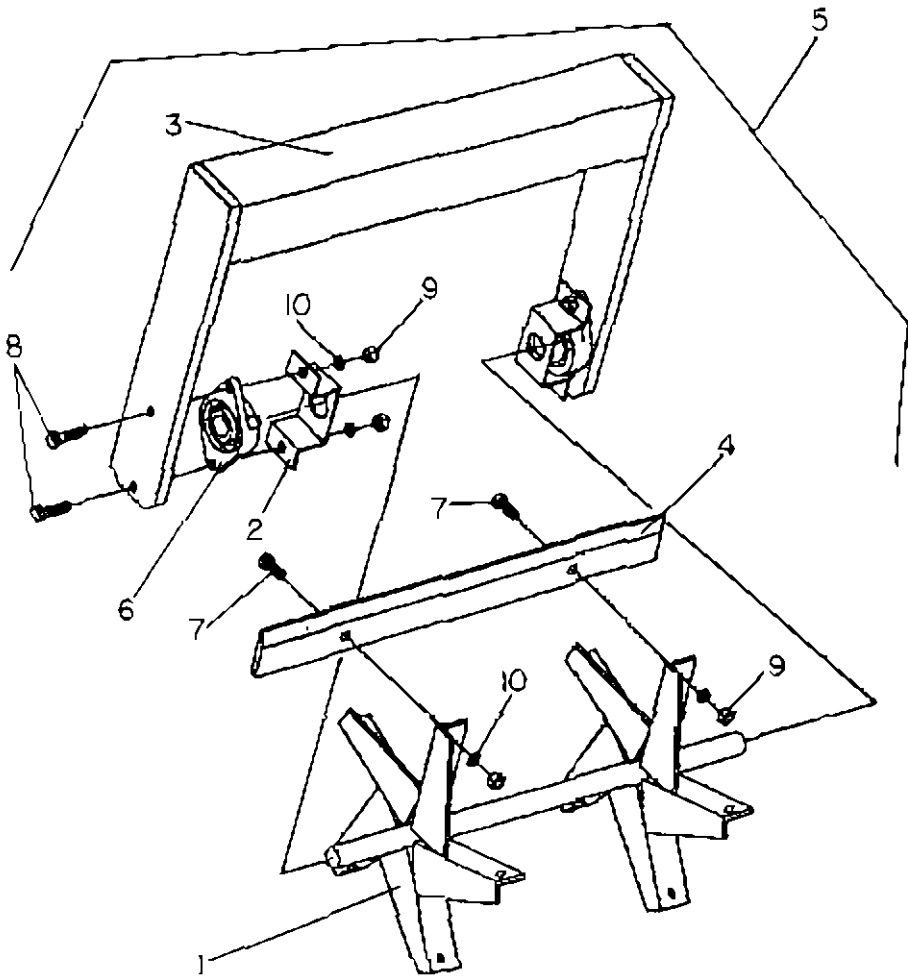

Single chopper gang assembly

Key	Part No.	Description
1	0425-013	5 Blade spider hub
2	0425-031	Bearing protector
3	0425-056	Single chopper gang, frame
4	0425-200	Chopper blade
5	0425-556	Single chopper gang assembly
6	5449-035	Bearing, TCJT 1 1/4"
7	7113-101	Cap screw, 1/2"NC x 1 1/4"
8	7113-110	Cap screw, 1/2"NC x 2"
9	7723-010	Hex nut, 1/2"NC, heavy
10	7843-015	Lock washer, 1/2"

Note: Prior to 2/97

Key	Part No.	Description
3	0425-008	Single chopper gang, frame
5	0425-498	Single chopper gang assembly

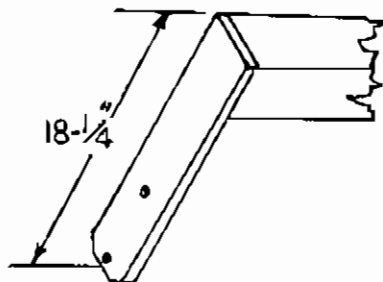

Dual chopper gang assembly

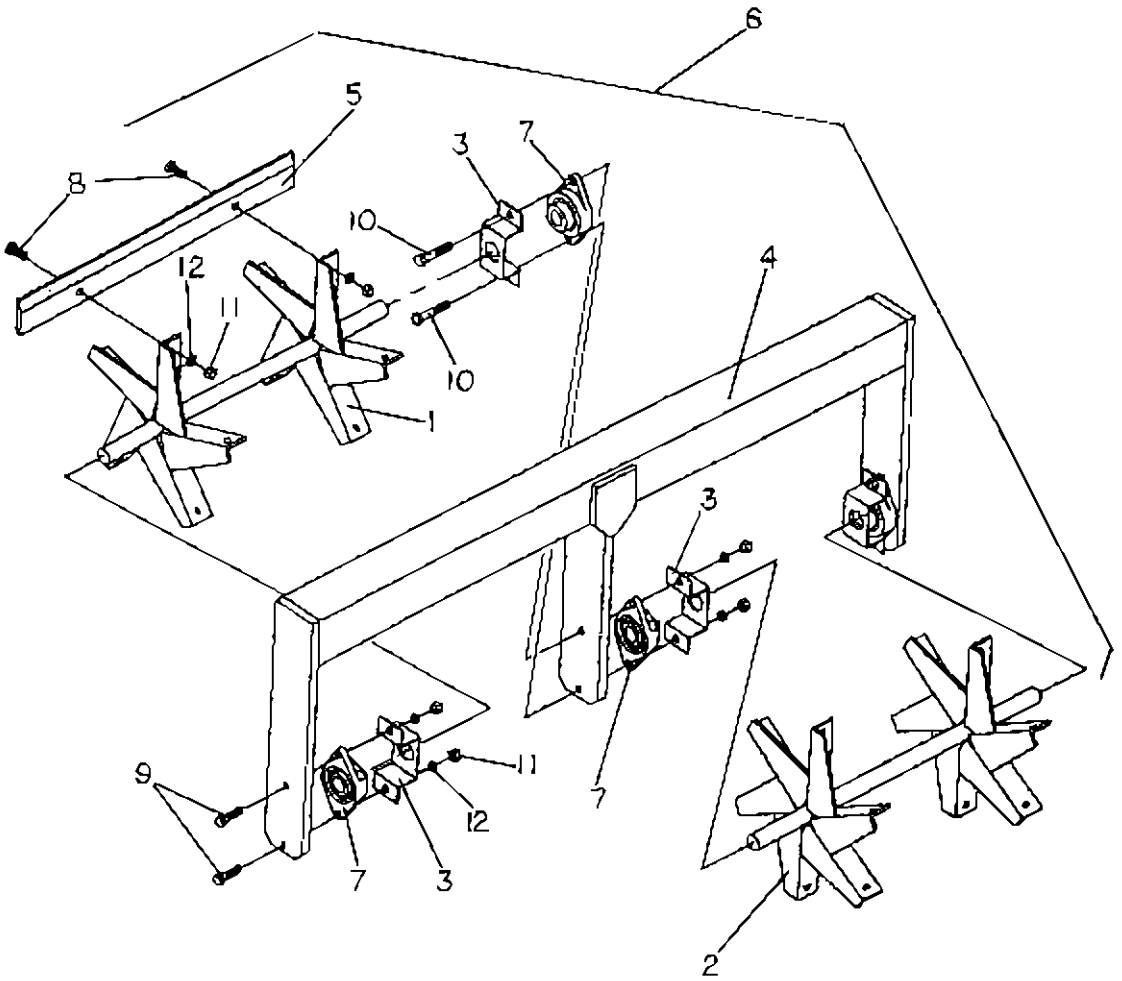

Dual chopper gang assembly

Key	Part No.	Description
1	0425-013	5 Blade spider hub
2	0425-014	6 Blade spider hub
3	0425-031	Bearing protector
4	0425-057	Dual chopper gang , frame
5	0425-200	Chopper blade
6	0425-557	Dual chopper gang assembly
7	5449-035	Bearing, TCJT 1 1/4"
8	7113-101	Cap screw, 1/2"NC x 1 1/4"
9	7113-110	Cap screw, 1/2"NC x 2"
10	7113-113	Cap screw, 1/2"NC x 2-3/4"
11	7723-010	Hex nut, 1/2"NC, heavy
12	7843-015	Lock washer, 1/2"

Note: Prior to 2/97

Key	Part No.	Description
4	0425-007	Dual chopper gang, frame
6	0425-490	Dual chopper gang assembly

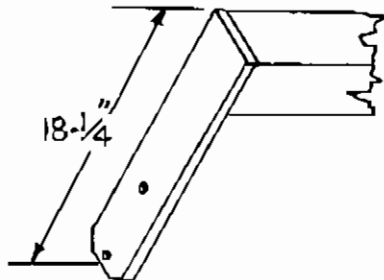

13 ft. Chisel Chopper

Chisel plow shanks, Rear support assemblies & Chopper gangs

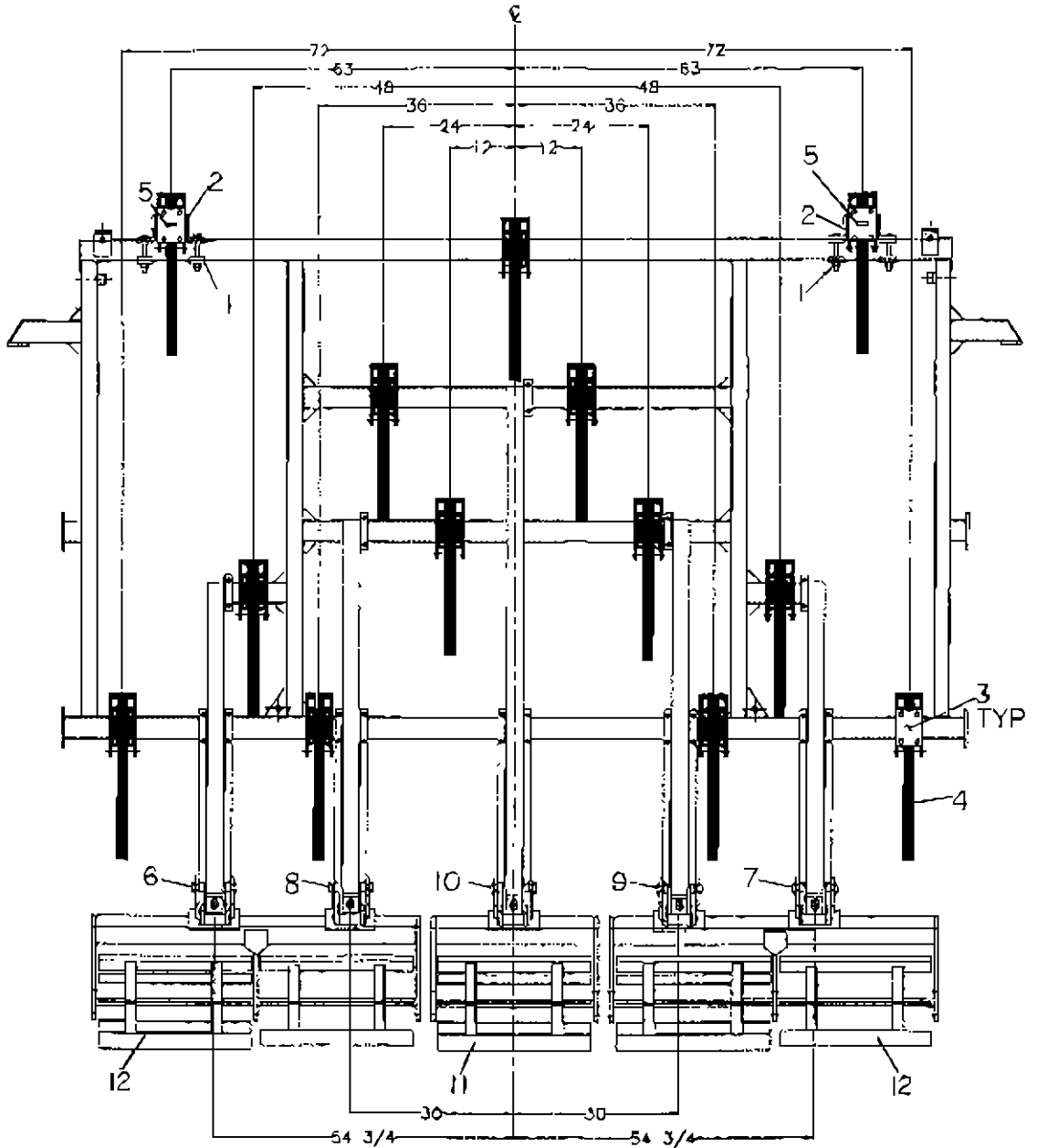

13 ft. Chisel Chopper
Chisel plow shanks, Rear support assemblies & Chopper gangs

Key	Part No.	Description
1	0420-114	Backing plate
2	0420-118	Forward shank mount
3	0420-300	Mount plate
4	0420-355	Chisel plow shank assembly
5	0425-030	Cylinder lock holder
6	0425-550	Rear support assembly, 51" LH
7	0425-551	Rear support assembly, 51" RH
8	0425-552	Rear support assembly, 68" LH
9	0425-553	Rear support assembly, 68" RH
10	0425-555	Rear support assembly, 93" Center
11	0425-556	Single chopper gang assembly
12	0425-557	Dual chopper gang assembly

Note: Prior to 2/97

Key	Part No.	Description
6	0425-480	Rear support assembly, 51" LH
7	0425-479	Rear support assembly, 51" RH
8	0425-491	Rear support assembly, 68" LH
9	0425-496	Rear support assembly, 68" RH
10	0425-497	Rear support assembly, 93"
11	0425-498	Single chopper gang assembly
12	0425-490	Dual chopper gang assembly

15 ft. Chisel Chopper

Chisel plow shanks, Rear support assemblies & Chopper gangs

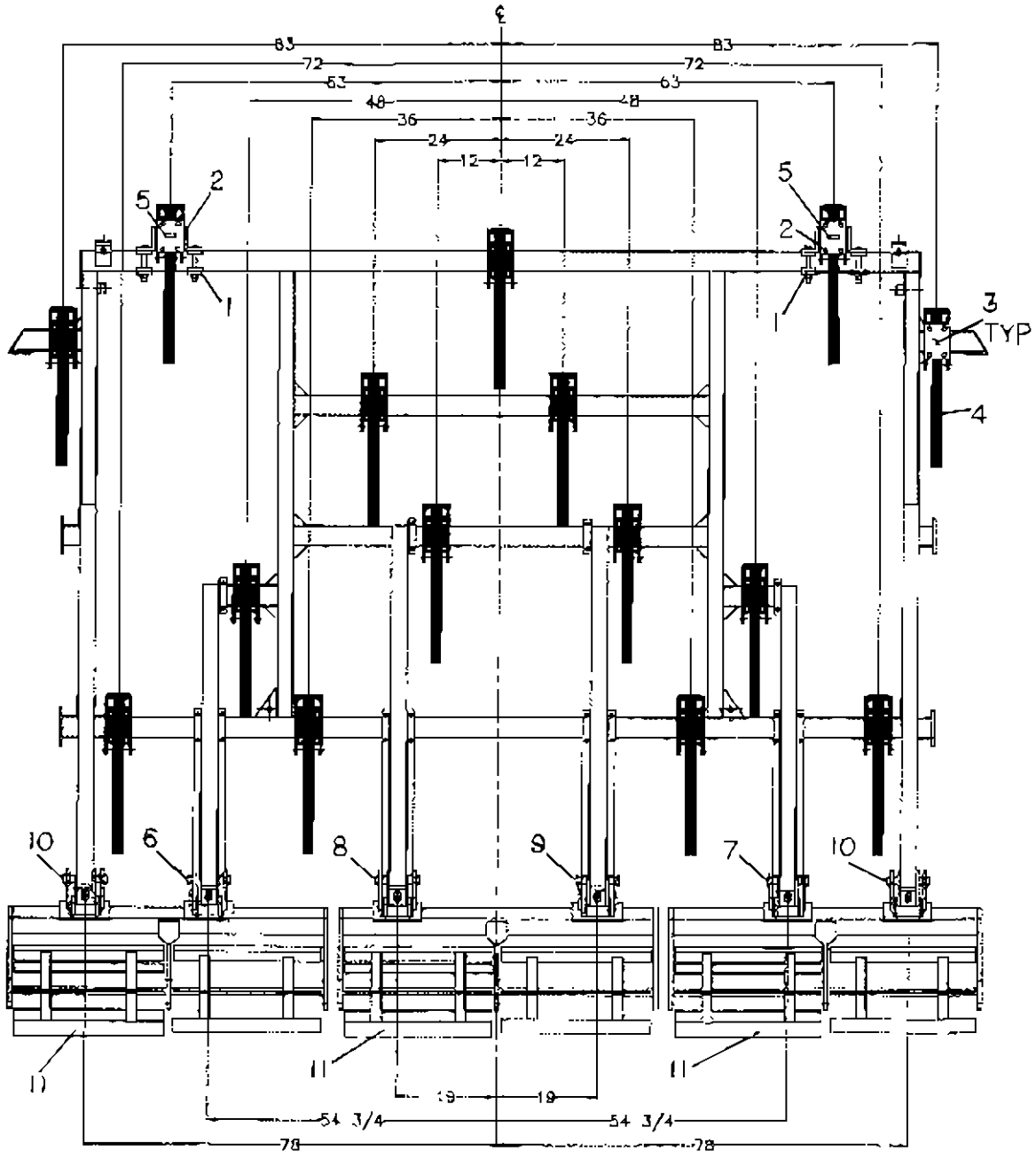

15 ft. Chisel Chopper

Chisel plow shanks, Rear support assemblies & Chopper gangs

Key	Part No.	Description
1	0420-114	Backing plate
2	0420-118	Forward shank mount
3	0420-300	Mount plate, [typical]
4	0420-355	Chisel plow shank assembly
5	0425-030	Cylinder lock holder
6	0425-550	Rear support assembly, 51" LH
7	0425-551	Rear support assembly, 51" RH
8	0425-552	Rear support assembly, 68" LH
9	0425-553	Rear support assembly, 68" RH
10	0425-554	Rear support assembly, 72"
11	0425-557	Dual chopper gang assembly

Note: Prior to 2/97

Key	Part No.	Description
6	0425-480	Rear support assembly, 51" LH
7	0425-479	Rear support assembly, 51" RH
8	0425-491	Rear support assembly, 68" LH
9	0425-496	Rear support assembly, 68" RH
10	0425-492	Rear support assembly, 72"
11	0425-490	Dual chopper gang assembly

17 ft. Chisel Chopper

Chisel plow shanks, Rear support assemblies & Chopper gangs

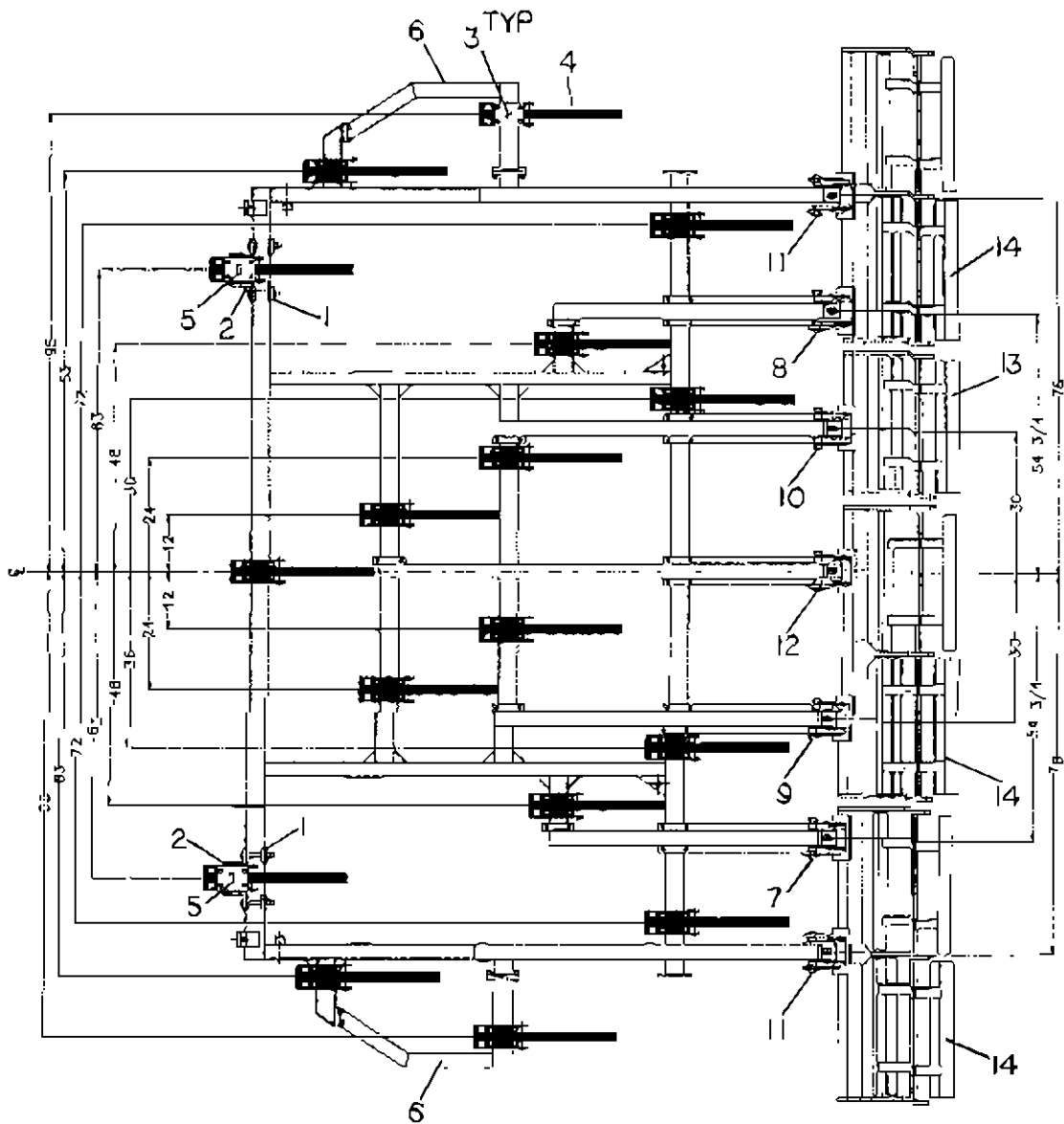

17 ft. Chisel Chopper

Chisel plow shanks, Rear support assemblies & Chopper gangs

Key	Part No.	Description
1	0420-114	Backing plate
2	0420-118	Forward shank mount
3	0420-300	Mount plate [typical]
4	0420-355	Chisel plow shank assembly
5	0425-030	Cylinder lock holder
6	0425-060	Frame extension
7	0425-550	Rear support assembly, 51" LH
8	0425-551	Rear support assembly, 51" RH
9	0425-552	Rear support assembly, 68" LH
10	0425-553	Rear support assembly, 68" RH
11	0425-554	Rear support assembly, 72"
12	0425-555	Rear support assembly, 93" Center line
13	0425-556	Single chopper gang assembly
14	0425-557	Dual chopper gang assembly

Note: Prior to 2/97

Key	Part No.	Description
7	0425-480	Rear support assembly, 51" LH
8	0425-479	Rear support assembly, 51" RH
9	0425-491	Rear support assembly, 68" LH
10	0425-496	Rear support assembly, 68" RH
11	0425-492	Rear support assembly, 72"
12	0425-497	Rear support assembly, 93"
13	0425-498	Single chopper gang assembly
14	0425-490	Dual chopper gang assembly

20 ft. Chisel Chopper

Chisel plow shanks, Rear support assemblies & Chopper gangs

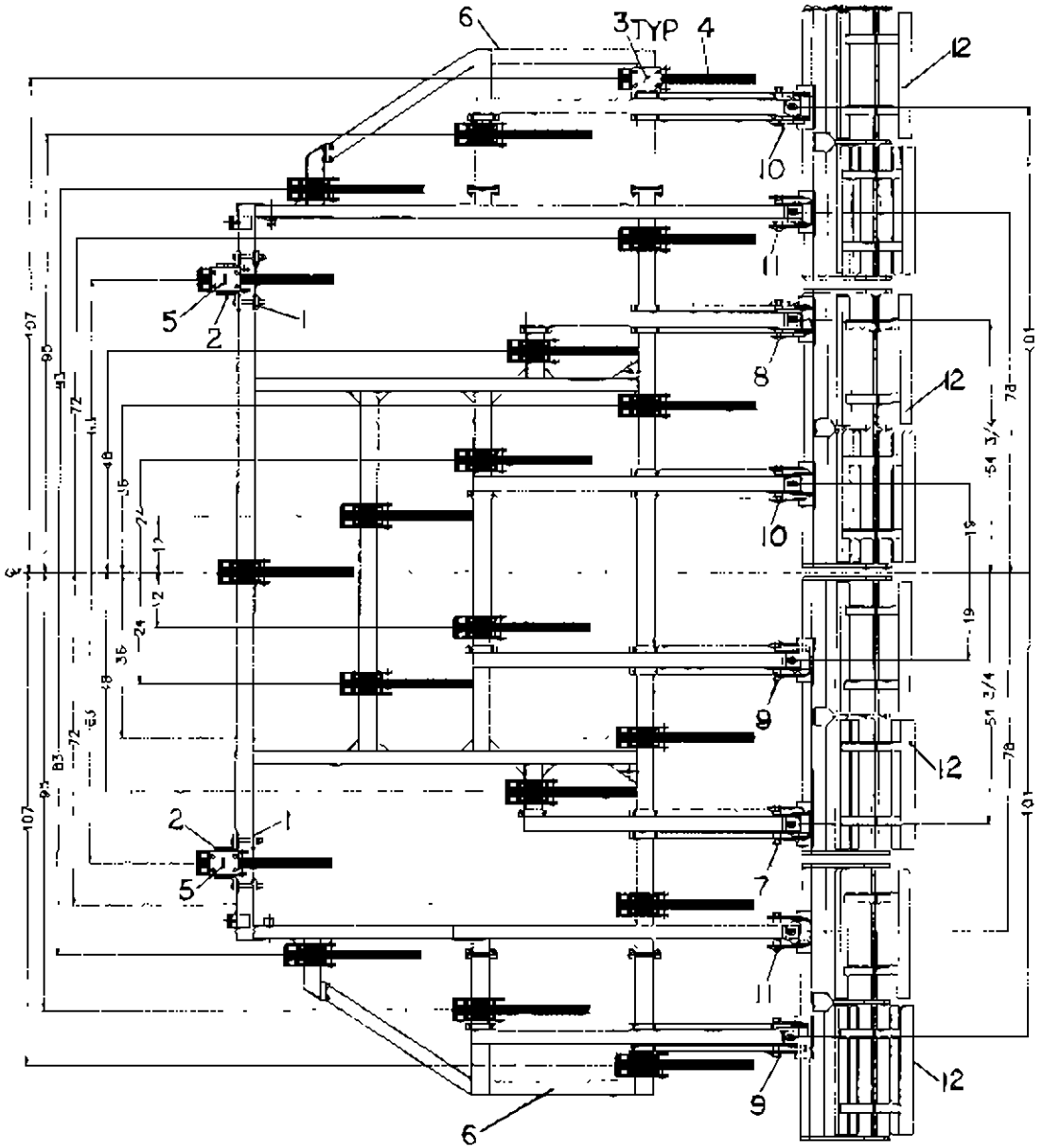

20 ft. Chisel Chopper

Chisel plow shanks, Rear support assemblies & Chopper gangs

Key	Part No.	Description
1	0420-114	Backing plate
2	0420-118	Forward shank mount
3	0420-300	Mount plate, [typical]
4	0420-355	Chisel plow shank assembly
5	0425-030	Cylinder lock holder
6	0425-061	Frame extension
7	0425-550	Rear support assembly, 51" LH
8	0425-551	Rear support assembly, 51" RH
9	0425-552	Rear support assembly, 68" LH
10	0425-553	Rear support assembly, 68" RH
11	0425-554	Rear support assembly, 72"
12	0425-557	Dual chopper gang assembly

Note: Prior to 2/97

Key	Part No.	Description
7	0425-480	Rear support assembly, 51" LH
8	0425-479	Rear support assembly, 51" RH
9	0425-491	Rear support assembly, 68" LH
10	0425-496	Rear support assembly, 68" RH
11	0425-492	Rear support assembly, 72"
12	0425-490	Dual chopper gang assembly

Part number page referencce

Part no.	Description	Page no.
0101-037	Hydraulic hose mast assembly	5
0206-031	Clamp plate, formed	5, 21
0216-021	Backing plate	21, 45, 47, 49 50, 51, 53, 55
0410-121	Adjustable link	15
0410-581	Adjustable linkage assembly	5, 15
0420-055	Walking beam, RH, W/ 5419-122 Races	13
0420-056	Walking beam, LH, W/ 5419-122 Races	13
0420-080	Shank mount hinge	43
0420-081	Shank mount bracket	41 43
0420-101	Cylinder lock	15
0420-102	Rear stand	5
0420-103	Rear stand adjustment bracket	5
0420-114	Backing plate	41, 61, 63, 65, 67
0420-118	Forward shank mount	41, 61, 63, 65, 67
0420-165	Tandem wheel leg, I H	11, 13
0420-166	Tandem wheel leg, RII	11, 13
0420-295	Cylinder pivot arm	5, 15
0420-297	Support plate	43
0420-298	Mount plate	43
0420-299	Spacer	43
0420-300	Mount backing plate	43, 61, 63, 65, 67
0420-355	Chisel plow shank assembly, W/O Point	43, 61, 63, 65, 67
0420-410	Tandem wheel leg assembly, RH	5, 11, 15
0420-415	Tandem wheel leg assembly, LH	5, 11
0420-450	Walking beam assembly, RH	11, 13
0420-455	Walking beam assembly, LH	11, 13
0420-936	Base plate	5

Part number page reference

Part no.	Description	Page no.
0425-001	Center frame module	5, 7, 9, 15, 17
0425-002	Front hinge mount	17, 21, 33, 35, 37, 39
0425-006	Gang mount, 10"	23, 45, 47, 49, 51, 53, 55
0425-007	Dual chopper gang, frame	59
0425-008	Single chopper gang, frame	57
0425-009	Spring rod support tube	23, 45, 47, 49, 51, 53, 55
0425-010	Spring rod	23, 45, 47, 49, 51, 53, 55
0425-011	Dual coultter gang, frame	21, 29, 31
0425-012	Single coultter gang, frame	21, 25, 27
0425-013	5 Blade spider hub	57, 59
0425-014	6 Blade spider hub	59
0425-017	Coultter shaft, 53-1/8"	29
0425-018	Coultter spacer, 2-3/16"	25, 27, 29, 31
0425-021	Coultter spacer, 12"	25, 27, 29, 31
0425-022	Bent tongue, RH	5
0425-023	Bent tongue, LH	5
0425-030	Cylinder lock holder	41, 61, 63, 65, 67
0425-031	Bearing protector	57, 59
0425-032	Cross tongue, 13 ft. and 15 ft.	17, 21, 33, 35
0425-033	Cross tongue, 17 ft. and 20 ft.	17, 21, 33, 35
0425-034	Coultter shaft, 20-3/8"	25
0425-037	68" Rear support, LH	49
0425-038	68" Rear support, RH	51
0425-039	93" Rear support	55
0425-040	72" Rear support	53
0425-043	51" Rear support, LH	45
0425-044	51" Rear support, RH	47
0425-045	Front arm mount	17, 21, 33, 35, 37, 39

Part number page reference

Part no.	Description	Page no.
0425-046	Coulter spacer, 8-3/16"	27, 29, 31
0425-047	Coulter shaft, 29-1/8"	27
0425-051	Spring tower, coulter mount	23
0425-052	Hydraulic bracket	19
0425-055	7" Gang mount	23, 45, 47, 49, 51, 53, 55
0425-056	Single chopper gang, frame	57
0425-057	Dual chopper gang, frame	59
0425-058	Single coulter gang, frame	21, 25, 27
0425-059	Dual coulter gang, frame	21, 29, 31
0425-060	Frame extension	7, 65
0425-061	Frame extension	9, 67
0425-062	Coulter shaft, 62-1/8"	31
0425-200	Chopper blade	57, 59
0425-201	Backing plate	53
0425-312	Pilot operated check valve assembly	19
0425-450	Spring tower assembly	21, 23, 33, 35, 37, 39
0425-479	Rear support assembly, 51" RH	47, 61, 63, 65, 67
0425-480	Rear support assembly, 51" LH	45, 61, 63, 65, 67
0425-482	2 Blade coulter gang assembly	25, 37
0425-483	5 Blade coulter gang assembly	29, 33, 37, 39
0425-490	Dual chopper gang assembly	59, 61, 63, 65, 67
0425-491	Rear support assembly, 68" LH	49, 63, 65, 67
0425-492	Rear support assembly, 72"	53, 63, 65, 67
0425-495	3 Blade coulter gang assembly	27, 33, 39
0425-496	Rear support assembly, 68" RH	51, 61, 65, 67
0425-497	Rear support assembly, 93"	55, 61, 65
0425-498	Single chopper gang assembly	57, 61, 65

Part number page reference

Part no.	Description	Part no.
0425-502	Depth stop kit, large, 5 sizes 1" thru 2"	17
0425-550	Rear support assembly, 51" LH	45, 61, 63, 65, 67
0425-551	Rear support assembly, 51" RH	47, 61, 63, 65, 67
0425-552	Rear support assembly, 68" LH	49, 61, 63, 65, 67
0425-553	Rear support assembly, 68" RH	51, 61, 63, 65, 67
0425-554	Rear support assembly, 72"	53, 63, 65, 67
0425-555	Rear support assembly, 93"	55, 61, 65
0425-556	Single chopper gang assembly	57, 61, 65
0425-557	Dual chopper gang assembly	59, 61, 63, 65, 67
0425-558	2 Blade coultter gang assembly	25, 37
0425-559	3 Blade coultter gang assembly	27, 33, 39
0425-560	5 Blade coultter gang assembly	29, 33, 35, 37, 39
0425-561	Spring tower assembly	21, 23, 33, 35, 37, 39
0425-562	6 Blade coultter gang assembly	31, 39
0425-955	Coultter washer	27, 29, 31
0950-297	Backing plate	19
5113-001	Spring	43
5114-001	Spring	23, 45, 47, 49, 51, 53, 55
5226-200	Hose clamp, 3/4" to 1 1/2"	19
5359-411	No rider decal	3
5359-415	Calkins, large decal	3
5359-423	Yellow warning decal	3
5359-425	Chisel chopper, decal	3

Part number page reference

Part no.	Description	Page no.
5419-122	Race	13
5419-152	Bearing	13
5419-153	Race	13
5419-154	Bearing	13
5439-151	Seal	13
5449-031	Bearing, DS209-TTR5	25, 27, 29, 31
5449-035	Bearing, TCJT 1 1/4"	57, 59
5469-013	Dust cap	13
5469-020	Dust cap	13
5499-010	Bearing flange, W/zerk	25, 27, 29, 31
5499-011	Bearing flange	25, 27, 29, 31
5619-025	8 Bolt hub assembly	13
5619-026	8 Bolt hub	13
5639-027	Tire and wheel, 11L x 15, 8 ply, Ribbed	5
5818-625	Hydraulic cylinder, 4 x 8 SAE	17, 19
5819-064	Hydraulic cylinder, 3-3/4 x 12 Rebase	15, 19
5819-065	Hydraulic cylinder, 4 x 12 Rebase	15, 19
5833-101	1/2" Tee	19
5842-650	3/8"-90 degree swivel union 1/4"	19
5843-214	1/2" Male run tee	19
5843-235	1/2" Male quick coupler	19
5843-460	1/2"-90 degree swivel union	19
5846-095	1/2" -90 degree O-Ring swivel union	15, 17, 19
5859-410	1/2" Pilot operated valve	19
5919-050	Top insert	43
5919-051	Bottom insert	43
5919-900	Tongue flapper	5
5939-002	32" Shank	43
5939-005	Coulter blade	25, 27, 29, 31
5952-609	Point, reversible bolt on	43
5952-612	Point, twisted RH	43
5952-613	Point, twisted LH	43
5952-635	Sweep, 16"	43
5952-641	Sweep, 18"	43

Chisel chopper

A-5

Part number page reference

Part no.	Description	Part no.
6136-675	Bushing, 1.75" OD x 1.53" ID x 1.438"	5
6215-001	U-Bolt, 3/4" W/ 2-7/16" span	43
6329-055	Tongue jack	5
6628-016	Spindle, wheel leg	13
6628-017	Spindle, walking beam	13
6822-211	Hose, 3/8" x 11-3/8"	19
6822-226	Hose, 3/8" x 26"	19
6822-234	Hose, 3/8" x 34"	19
6822-266	Hose, 3/8" x 66"	19
6822-272	Hose, 3/8" x 72"	19
6822-356	Hose, 3/8" x 156"	19
6822-440	Hose, 3/8" x 240" [20'-0"]	19
6822-478	Hose, 3/8" x 288" [24'-0"]	19
6896-100	Depth stop, white 1" med.	15
6896-125	Depth stop, green 1 1/4" med.	15
6896-150	Depth stop, blue 1 1/2" med.	15
6896-175	Depth stop, red 1 3/4" med.	15
6896-200	Depth stop, yellow 2" med.	15
6897-100	Depth stop, white 1" large	17
6897-125	Depth stop, green 1 1/4" large	17
6897-150	Depth stop, blue 1 1/2" large	17
6897-175	Depth stop, red 1 3/4" large	17
6897-200	Depth stop, yellow 2" large	17
6899-402	Depth stop kit, 5 sizes 1" thru 2" med.	15
7021-010	Roll pin, 7/32" x 2"	21, 23, 45
7022-005	Roll pin, 3/8" x 2"	21, 23, 45
7112-110	Cap screw, 3/8"NC x 10"	19
7113-101	Cap screw, 1/2"NC x 1 1/4"	57, 59
7113-110	Cap screw, 1/2"NC x 2"	57, 59
7113-113	Cap screw, 1/2"NC x 2 3/4"	59
7113-135	Cap screw, 1/2"NC x 6"	21

Part number page reference

Part no.	Description	Page no.
7114-028	Cap screw, 5/8"NC x 3-1/4"	43
7114-040	Cap screw, 5/8"NC x 4"	13
7114-050	Cap screw, 5/8"NC x 5"	13
7114-060	Cap screw, 5/8"NC x 6"	5, 21, 45, 47, 49, 51, 53, 55
7114-080	Cap screw, 5/8"NC x 8"	45, 47, 49, 51, 55
7114-109	Cap screw, 5/8"NC x 2"	5, 7, 9
7115-025	Cap screw, 3/4"NC x 2 1/2"	15
7115-030	Cap screw, 3/4"NC x 3"	43
7115-069	Cap screw, 3/4"NC x 6" Gr. 8	21
7115-071	Cap screw, 3/4"NC x 6 1/2"	41
7115-075	Cap screw, 3/4"NC x 5 1/2"	15
7115-080	Cap screw, 3/4"NC x 8"	21, 41, 43
7115-112	Cap screw, 3/4"NC x 7"	43
7116-025	Cap screw, 1"NC x 2 1/2"	21
7273-001	Plow bolt, 1/2"NC x 2 1/2"	43
7333-009	Lug bolt, 9/16" x 1 1/4"	13
7343-000	Carriage bolt, 1/2"NC x 1"	25, 27, 29, 31
7343-001	Carriage bolt, 1/2"NC x 1 1/2"	25, 27, 29, 31
7707-001	Lock nut, N-08	13
7715-871	Hex nut, 7/8"NC	15
7715-875	Slotted nut,	13
7717-240	Slotted nut, 1 1/4"NF	25, 27, 29, 31
7717-255	Lock nut, 1 1/4"NC	5
7717-555	Lock nut, 1 1/2"NC	5
7722-010	Hex nut, 3/8"NC	19
7723-010	Hex nut, 1/2"NC, heavy	57, 59
7723-015	Hex nut, 1/2"NC	21, 25, 27, 29, 31, 43
7724-005	Hex nut, 5/8"NC	7, 9, 13, 21, 45, 47
7724-120	Lock nut, 5/8"NC	5, 43
7725-002	Hex nut, 3/4"NC	5, 15, 21, 41, 43, 53
7725-130	Lock nut, 7/8"NC	43
7726-005	Hex nut, 1"NC	5, 21
7726-012	Lock nut, 1"NC	23, 45, 47, 49, 51, 53, 55

Part number page reference

Part no.	Description	Page no.
7807-001	Ear washer, W-08	13
7814-020	Lock washer, 5/8"	13
7815-025	Flat washer, 7/8"	13
7816-020	Flat washer, 1"	15
7842-010	Lock washer, 3/8"	19
7843-015	Lock washer, 1/2"	21, 25, 27, 29, 31, 43, 57, 59
7844-020	Lock washer, 5/8"	7, 9, 21, 45, 47, 49, 53, 55
7845-020	Lock washer, 3/4"	5, 15, 21, 41, 43, 53
7846-020	Lock washer, 1"	5, 21
7896-001	Machine bushing, 1" 10 ga. NR	23, 45, 47, 49, 51, 53, 55
7896-250	Machine bushing, 1 1/4" x 10 ga. NR	25, 27, 29, 31
7896-500	Machine bushing, 1 1/2" x 10 ga. NR	5
7910-162	Cotter pin, 5/32" x 1 1/2"	13
7910-180	Cotter pin, 3/16" x 2"	25, 27, 29, 31
7920-002	Hitch pin, #8, cylinder lock	15
7920-010	Drive line lock pin, 5/16" x 2 1/4"	5
7920-012	Hitch pin, 1/2" x 4" W/ safety pin	5
8026-034	Pin, 1" x 8-9/16"	45, 47, 49, 51, 53, 55
8036-022	Hinge pin, 1 1/4" x 7"	17, 21
8036-025	Pin, 1 1/2" x 5-13/16"	5
8115-014	Bolt, 3/4" NC x 13-7/8"	53
8116-003	Bolt, 1" NC x 6 1/4" W/ nylock nut 7726-012	23, 45, 47, 49, 51, 53, 55
8116-006	Bolt, 1 1/4" NC x 10 1/4"	5
8117-003	Bolt, 1 1/2" NC x 4 1/2"	5
8816-001	Spring retainer washer	23, 45, 47, 49, 51, 53, 55